

# Product Manual

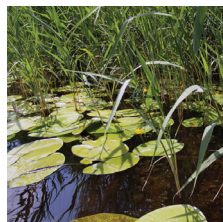

## Weed Raker™

Item 580111

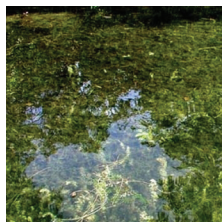
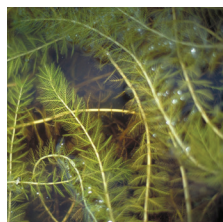
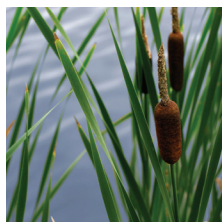

## Table of Contents:

Product Contents .....	2
Assembly Instructions .....	3
Operating Instructions .....	4

Replacement Parts .....	4
Product Warranty.....	4

# Important Information:

Please read these instructions thoroughly before use. Failure to follow instructions may result in equipment damage or failure, losses, injury or death.

## ⚠ **WARNING:** ⚠

To reduce the risk of injury:

- The Weed Raker is designed for removing submerged, partially emergent, or emergent aquatic vegetation from underwater. Any other use is strictly prohibited. Before using the Weed Raker, please read this manual carefully to understand the proper use of the unit.

## ⚠ **SAFETY FIRST:** ⚠

Keep out of reach of children.

Do not use with children in immediate area.

IMPORTANT: Jenlis, Inc® is not responsible for equipment damage or failure, losses, injury or death resulting from failure to follow safety precautions, misuse or abuse of equipment.

## PRODUCT CONTENTS:

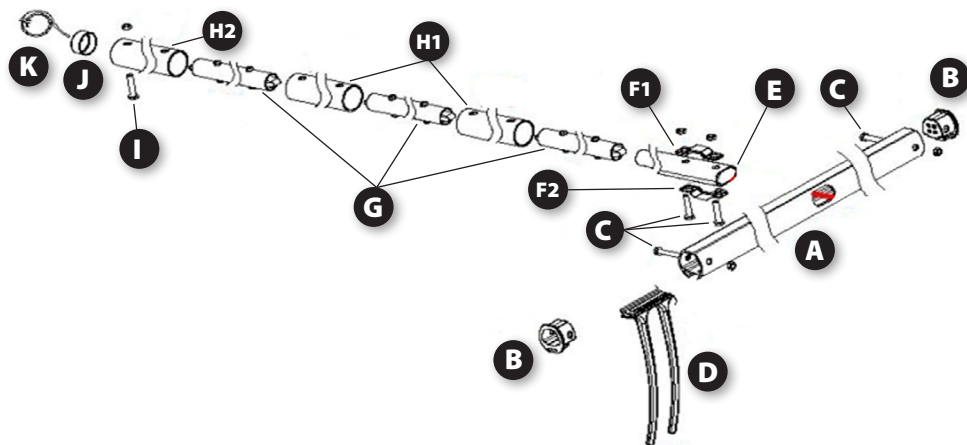

PART		QTY
A	Rake Head Extrusion	1
B	End Cap	2
C	2" Bolt & Nut	4
D	Tines (Teeth)	12 pr.
E	Handle Section for Head	1
F1/F2	Support Bracket	2

PART		QTY
G	Handle Connector	3
H1/H2	Handle	3
I	1.75" Bolt & Nut	1
J	Black End Cap	1
K	Rope	1

# Assembly & Instructions

**Tools Required:** 1/2" Wrench, 12mm Wrench

## Step 1

Place one end of the end cap (B), into the Rake Head (A). Secure the end cap with the bolt and lock nut (C).



## Step 2

Insert rake teeth (D) into the channel at the bottom of the rake head (there are 12 pairs of teeth). The teeth should curve toward the handle. When all of the teeth have been inserted, insert the second end cap (B) into the end of the rake head and secure in place with the bolt and nut (C).



## Step 3

Slide the section of the handle with a tapered end (E) into the oval hole in the rake head (A) (see diagram). The handle should only pass through the hole far enough so the hole closest to the end of the handle is completely visible on the other side of the rake head. Place the handle support brackets (F1) over the top and bottom (F2) of the rake head and line them up with the holes in the handle on either side of the rake head. Insert the two bolts (3) from the bottom of the handle up through the holes in the handle and handle support brackets. Secure the bolts with the lock nuts and tighten until they are snug.



## Step 4

Connect the remaining sections of the handle (H1/H2) to the handle section (E) using the handle connector pieces (G). Push the spring loaded clip on both sides of one end of the connector piece and insert it into the handle. Rotate the connector piece until the spring clip ends snap into the holes in the handle. Complete the assembly by inserting the last handle section.



# Operating Instructions

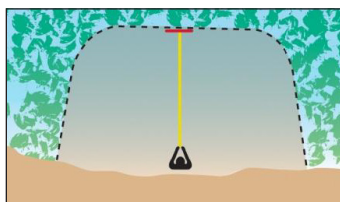
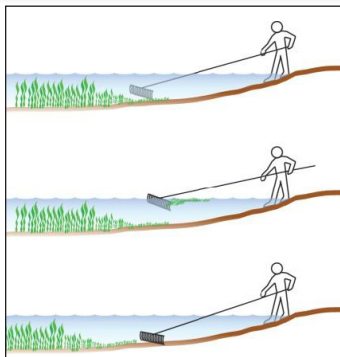

The Weed Raker is designed to remove:

- Roots of weeds to prevent re-growth
- Cut weeds and debris floating on the surface of the water
- Shorter bottom dwelling weeds
- Decaying organic matter on the bottom

If you have recently cut your weeds with the Weed Razer, use the Weed Raker to remove the remaining roots that lie beneath the surface of your lake or pond bottom. Allow the Raker head to sink to the bottom. Use a back and forth motion with the Raker handle and stir up the bottom. The long teeth of the Weed Raker will dig into the bottom and dislodge the root system of most leafy submerged aquatic vegetation. The large Raker head is ideal for gathering and move piles of cut weeds.

## Replacement Parts

WEED RAKER	PART #
D. Replacement Tines	580115
E. Lower Handle Section (Connects to Head)	580260
F. Support Bracket w/Hardware (C)	580269
G. Handle Connector w/ 2 Spring Clips	580140

WEED RAKER	PART #
H1. Middle Handle Section	580259
H2. Upper Handle w/Black End Cap	580258
K. Rope (25')	580255

### ONE YEAR MANUFACTURER'S WARRANTY:

**1-Year Manufacturer's Warranty** – Jenlis, Inc. warrants this product to be free from defects in workmanship and materials, under normal, non-commercial use and conditions, for a period of (1) one year from the original invoice date. **Warranty Limitations** – Damage resulting from use in commercial environment, misuse, abuse, negligence, and/or accidents. The manufacturer agrees, at its option during the warranty period, to repair any defect in material or workmanship, or to furnish a repaired or refurbished product without charge. All warranty claims must be sent to Jenlis, at the customer's expense. Return shipping will be pre-paid. All returns must be pre-approved. Please visit [www.weedrazer.com/warranty](http://www.weedrazer.com/warranty) for an RMA number prior to returning product. Returns without RMA's will be refused.