

HOME 30 CONCEPT

HERRINGBONE

ONEFLOR **HERRINGBONE** KOLLEKTSIOON

... SAADAVAL LIIMITUNAVÕI KLIKK-SÜSTEEMIGA NING AKUSTILISE ALUSPÕHJAGA (ALATES JUUNIST 2020)

HOME 30

PUIDU- MUSTRID

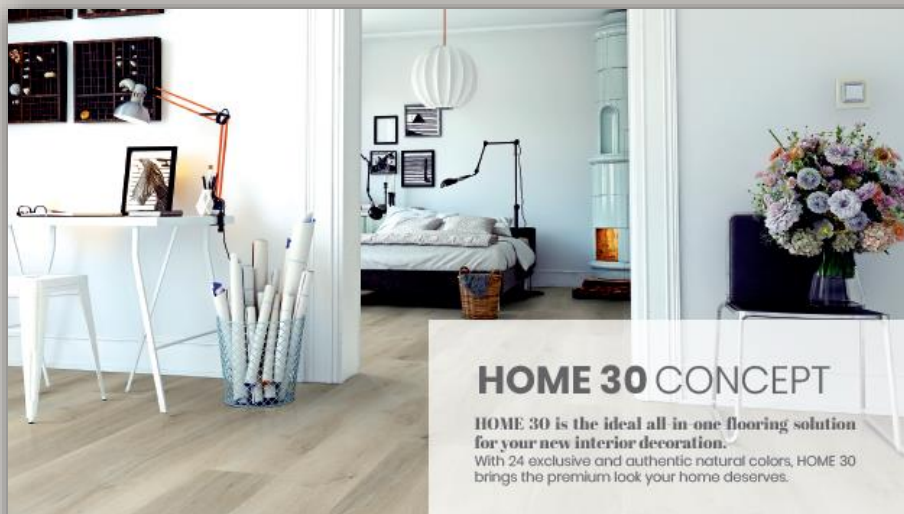

HOME 30 CONCEPT

HOME 30 is the ideal all-in-one flooring solution for your new interior decoration.

With 24 exclusive and authentic natural colors, HOME 30 brings the premium look your home deserves.



Noble Oak Greige

OFR-030-004N | 177,8 x 1219,2 mm
OFD-030-062 | 185 x 1219,2 mm
OFC-030-062 | 177,8 x 1219,2 mm



Authentic Oak Natural

OFR-030-008N | 177,8 x 1219,2 mm
OFD-030-064 | 185 x 1219,2 mm
OFC-030-064 | 177,8 x 1219,2 mm



Prestige Oak Natural

OFR-030-009N | 177,8 x 1219,2 mm
OFD-030-066 | 185 x 1219,2 mm
OFC-030-066 | 177,8 x 1219,2 mm



Sea Oak white

OFR-030-012N | 177,8 x 1219,2 mm
OFD-030-069 | 185 x 1219,2 mm
OFC-030-069 | 177,8 x 1219,2 mm



Royal Oak Natural

OFR-030-005N | 177,8 x 1219,2 mm
OFD-030-063 | 185 x 1219,2 mm
OFC-030-063 | 177,8 x 1219,2 mm



Pure Oak Grey

OFR-030-008N | 177,8 x 1219,2 mm
OFD-030-065 | 185 x 1219,2 mm
OFC-030-065 | 177,8 x 1219,2 mm



Dookside Oak Natural light

OFR-030-011N | 177,8 x 1219,2 mm
OFD-030-068 | 185 x 1219,2 mm
OFC-030-068 | 177,8 x 1219,2 mm



Traditional Oak Greige

OFR-030-013N | 177,8 x 1219,2 mm
OFD-030-070 | 185 x 1219,2 mm
OFC-030-070 | 177,8 x 1219,2 mm



Traditional Oak Natural light

OFR-030-014N | 177,8 x 1219,2 mm
OFD-030-071 | 185 x 1219,2 mm
OFC-030-071 | 177,8 x 1219,2 mm



Warm Oak Greige

OFR-030-015N | 177,8 x 1219,2 mm
OFD-030-072 | 185 x 1219,2 mm
OFC-030-072 | 177,8 x 1219,2 mm

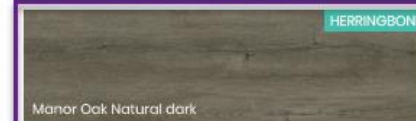

Manor Oak Natural dark

OFR-030-010N | 177,8 x 1219,2 mm
OFD-030-067 | 185 x 1219,2 mm
OFC-030-067 | 177,8 x 1219,2 mm
100 OFD-030-167 | 122 x 610 mm
100 OFR-030-167 | 122 x 610 mm



Painted Wood Natural

OFR-030-016N | 177,8 x 1219,2 mm
OFD-030-073 | 185 x 1219,2 mm
OFC-030-073 | 177,8 x 1219,2 mm



Sawcut Oak Natural

OFR-030-017N | 177,8 x 1219,2 mm
OFD-030-074 | 185 x 1219,2 mm
OFC-030-074 | 177,8 x 1219,2 mm
100 OFR-030-174 | 122 x 610 mm
100 OFD-030-174 | 122 x 610 mm



Soft Oak Greige

OFR-030-020N | 177,8 x 1219,2 mm
OFD-030-077 | 185 x 1219,2 mm
OFC-030-077 | 177,8 x 1219,2 mm
100 OFR-030-177 | 122 x 610 mm
100 OFD-030-177 | 122 x 610 mm



Sawcut Oak Dark

OFR-030-018N | 177,8 x 1219,2 mm
OFD-030-075 | 185 x 1219,2 mm
OFC-030-075 | 177,8 x 1219,2 mm



Soft Oak Natural

OFR-030-019N | 177,8 x 1219,2 mm
OFD-030-076 | 185 x 1219,2 mm
OFC-030-076 | 177,8 x 1219,2 mm



French Oak Natural

OFR-030-021N | 177,8 x 1219,2 mm
OFD-030-078 | 185 x 1219,2 mm
OFC-030-078 | 177,8 x 1219,2 mm



German Oak Natural

OFR-030-022N | 177,8 x 1219,2 mm
OFD-030-079 | 185 x 1219,2 mm
OFC-030-079 | 177,8 x 1219,2 mm

REFERENCES :
OFR - SOLIDE CLICK 30
OFD - ECO30
OFC - ECOCLOCK30



HERRINGBONES PATTERN

HERRINGBONES

The aesthetics and timeless elegance of a herringbone floor is unique.

Herringbone patterns tell the story of castles, classical mansion houses and museums. They can also play a magnificent role in modern and classic homes.

HERRINGBONE KOLLEKTSIOON

HERRINGBONE

Manor Oak Natural dark

OFR-030-010N | 177,8 x 1219,2 mm

OFD-030-067 | 185 x 1219,2 mm

OFC-030-067 | 177,8 x 1219,2 mm

HB OFD-030-167 | 122 x 610 mm

HB OFR-030-167 | 122 x 610 mm

HERRINGBONE

Sawcut Oak Natural

OFR-030-017N | 177,8 x 1219,2 mm

OFD-030-074 | 185 x 1219,2 mm

OFC-030-074 | 177,8 x 1219,2 mm

HB OFR-030-174 | 122 x 610 mm

HB OFD-030-174 | 122 x 610 mm

HERRINGBONE

Soft Oak Greige

OFR-030-020N | 177,8 x 1219,2 mm

OFD-030-077 | 185 x 1219,2 mm

OFC-030-077 | 177,8 x 1219,2 mm

HB OFR-030-177 | 122 x 610 mm

HB OFD-030-177 | 122 x 610 mm

MIKS HERRINGBONE?

Kalasabamustri ajatu elegants

Kalasabamustriga põrandad räägivad lugusid kindlustest, klassikalistest mõisahäärberitest ning muuseumitest.

Kalasabamustrilistel põrandatel on oluline roll ka kaasaegsetes ja klassikalistes kodudes.



HOME 30
Eco30 herringbone (OFD) / Solide Click 30 herringbone (OFR)

ONE FLOR EUROPE

Dekor/Design/Dessin **Manor Oak Natural dark**

Klicken / Click / A clipser (Rigid Acoustic) 122 x 610 x 4,5 mm
Art-Nr. OFR-030-167 2,68 m²/Paket/Box/Paquet

Kleben / Dry back/ A collar 122 x 610 x 2,0 mm
Art-Nr. OFD-030-167 1,49 m²/Paket/Box/Paquet

Designboden mit 0,3 mm Nutzschrift
Luxury Vinyl Tiles with 0,30 wear layer
Lames vinyles avec couche d'usure 0,30

Strapazierfähig
Durable
Résistant

Pflegeleicht
Easy maintenance
Entretien facile

Gerauscharm
Good sound insulation
Bonne isolation phonique

Gelenkschonend
Walking comfort
Confort à la marche

Fußwarm
Thermal comfort
Confort thermique

100% Phthalatfrei
100% Phthalate free
100% Sans phtalate

Für Fußbodenheizung geeignet
Suitable for floor heating
Convient au chauffage par le sol

Feuchtraumgeeignet
Suitable for wet rooms
Convient aux pièces humides

Rutschfest
Anti Slip surface
Antidérapant

Einfache und schnelle Verlegung
Quick and easy to install
Facile et rapide à poser

Verlegung über Fliesen möglich
Installation over ceramic possible
Installation sur carrelage possible

OFD only

25 Years
5 Years

ÉMISSIONS DANS L'AIR INTÉRIEUR
A+

SOLIDE CLICK 30 **HERRINGBONE**

Saadaval juunikuust 2020

- Uus jäik (rigid) LVT kollektsioon / Herringbone
- 3 ehedat naturaalse tamme disaini
- Väikesed mõõtmed (122*610 mm)
- Üldpaksus 4,5 mm / kulumiskihi paksus 0,30 mm
- Uus I4F klikk-ühendussüsteem
- Integreeritud akustilise aluspõhjaga (21 dB)
- Madal VOC, ftalaadivaba ja 100% ümbertöödeldav



SOLIDE CLICK 30 HERRINGBONE

Saadaval juunikuust 2020

- Saab paigaldada otse keraamiliste plaatide peale
- Suurepärase löögisummutusega
- Lihtne paigaldada
- Sobilik niiskettesse ruumidesse ja põrandaküttega aluspõrandatele
- Suurepärase kulumiskindlusega ja kerge puhastada tänu PUR Ecoprotec™ pinnatöötlustele
- Parem siseõhu kvaliteet



ECO30 HERRINGBONE

Saadaval juunikuust 2020

- Uus alusele liimitav LVT kolleksioon / Herringbone
- 3 ehedat naturaalse tamme disaini
- Väikesed mõõtmed (122*610 mm)
- Üldpaksus 2,00 mm / kulumiskihi paksus 0,30 mm
- Madal VOC, ftalaadivaba ja 100% taaskasutatav



ECO30 HERRINGBONE

Saadaval juunikuust 2020

- Hea hinna ja kvaliteedi suhtega
- Suurepärase kulumiskindluse ja lihtne puhastatavus tänu PUR Ecoprotec™ pinnatöötlemisele
- Parem siseõhu kvaliteet

TEHNILISED ANDMED

HOME 30 CONCEPT

Herringbone kollektsoon

| COLLECTION | ONEFLOR CODE | DESCRIPTION | TOTAL THICKNESS | WEAR LAYER | CLICK TYPE | WEIGHT / m ² (kg/m ²) | DIMENSIONS (mm) | NB PLANKS / BOX | M ² / BOX | NB BOXES / PALLET | M ² / PALLET |
|-------------------|--------------|------------------------|-----------------|------------|------------|--|-----------------|-----------------|----------------------|-------------------|-------------------------|
| Herringbone ECO30 | OFD-030-167 | Manor Oak Natural dark | 2,0mm | 0,3mm | - | 3,600 | 122 x 610 | 36 | 2,68 | 126 | 337,68 |
| Herringbone ECO30 | OFD-030-174 | Sawcut Oak Natural | 2,0mm | 0,3mm | - | 3,600 | 122 x 610 | 36 | 2,68 | 126 | 337,68 |
| Herringbone ECO30 | OFD-030-177 | Soft Oak Greige | 2,0mm | 0,3mm | - | 3,600 | 122 x 610 | 36 | 2,68 | 126 | 337,68 |

| COLLECTION | ONEFLOR CODE | DESCRIPTION | TOTAL THICKNESS | WEAR LAYER | CLICK TYPE | WEIGHT / m ² (kg/m ²) | DIMENSIONS (mm) | NB PLANKS / BOX | M ² / BOX | NB BOXES / PALLET | M ² / PALLET |
|-----------------------------|--------------|------------------------|-----------------|------------|------------|--|-----------------|------------------|----------------------|-------------------|-------------------------|
| Herringbone SOLIDE CLICK 30 | OFR-030-167 | Manor Oak Natural dark | 4,5mm | 0,3mm | I4F | 7,10 | 122 x 610 | 20 (= 10R + 10L) | 1,49 | 112 | 166,88 |
| Herringbone SOLIDE CLICK 30 | OFR-030-174 | Sawcut Oak Natural | 4,5mm | 0,3mm | I4F | 7,10 | 122 x 610 | 20 (= 10R + 10L) | 1,49 | 112 | 166,88 |
| Herringbone SOLIDE CLICK 30 | OFR-030-177 | Soft Oak Greige | 4,5mm | 0,3mm | I4F | 7,10 | 122 x 610 | 20 (= 10R + 10L) | 1,49 | 112 | 166,88 |



TOOTE EHITUS

SOLIDE CLICK 30 (OFR)

- ECOPROTEC™ Anti-Scratch Ceramic PU Coating (Anti-Bacterial)
- Clear design protection layer
- HD design print layer
- Rigid Core Layer
- IXPE acoustic backing

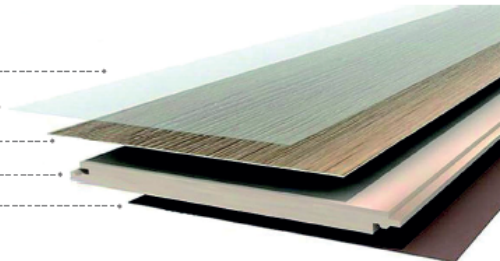

ECO30 (OFD)

- ECOPROTEC™ Anti-Scratch Ceramic PU Coating (Anti-Bacterial)
- Clear design protection layer
- HD design print layer
- Extra stabilization core layer
- Stabilization core layer
- Curling prevention balance layer
- ECOTECTURE™ Multi-layer property technology

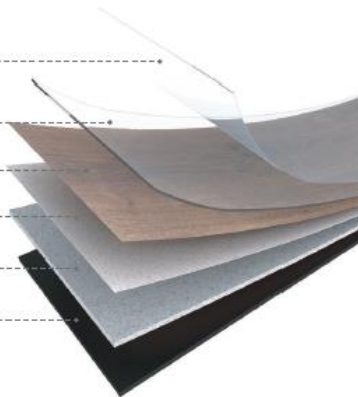

| PRODUCT SPECIFICATIONS | STANDARD | SOLIDE CLICK 30 // SOLIDE CLICK 30 HB | ECO 30 // ECO 30 HB | ECOCLICK 30 | | | |
|--|--------------|--|---|---|---|---|--|
| Product standard / Belagsart / Standard produit | - | EN ISO 10582 | EN ISO 10582 | EN ISO 10582 | | | |
| Product standard / Belagsart / Standard produit | - | Heterogeneous resilient floorcovering / Heterogener elastischer Designbodenbelag / Revêtements de sol résilients hétérogènes | | | | | |
| Total thickness / Gesamtstärke / Epaisseur totale | EN ISO 24346 | 4,5 mm | 2,0 mm | 4,0 mm | | | |
| Wear layer thickness / Nutzschiebtdicke / Epaisseur couche d'usure | EN ISO 24340 | 0,30 mm | 0,30 mm | 0,30 mm | | | |
| Classification / Nutzungsklasse / Classe d'usage | EN ISO 10874 | Domestic: 23 | Domestic: 23 | Domestic: 23 | | | |
| | | Commercial: 31 | Commercial: 31 | Commercial: 31 | | | |
| Total weight / Gesamtgewicht / Poids total | EN ISO 23997 | 6.450 g/m ² - 7.100 g/m ² (HB) | 3.605 g/m ² - 3.600 g/m ² (HB) | 7.630 g/m ² | | | |
| Wear layer binder content / Bindemittelgehalt / Teneur en agent liant (couche d'usure) | EN ISO 10582 | Type I / Typ I / Type I | Type I / Typ I / Type I | Type I / Typ I / Type I | | | |
| Abrasion group / Verschleißprüfung / Groupe d'abrasion | EN 660-2 | Group T: ≤ 2,00 mm ³ | | | | | |
| Dimensions / Dielengröße / Dimensions | EN ISO 24342 | Planks / Dielen / Lames: 177,8 x 1219,2 mm 12 planks/box = 2,60m ² 40 boxes/pallet = 104,05m ² | Planks / Dielen / Lames (HB): 122 x 610 mm 20 planks/box = 1,49m ² 112 boxes/pallet = 166,88m ² | Planks / Dielen / Lames: 185 x 1219,2 mm 21 planks/box = 4,74m ² 60 boxes/pallet = 284,4m ² | Planks / Dielen / Lames (HB): 122 x 610 mm 36 planks/box = 2,68m ² 126 boxes/pallet = 337,68m ² | Planks / Dielen / Lames: 177,8 x 1219,2 mm 10 planks/box = 2,17m ² 60 boxes/pallet = 130,2m ² | - |
| | | Tiles / Fliesen / Dalles: 457,2 x 914,4 mm 6 tiles/box = 2,51m ² 52 boxes/pallet = 130,44m ² | Tiles / Fliesen / Dalles: 304,8 x 609,6 mm 12 tiles/box = 2,23m ² 60 boxes/pallet = 133,80m ² | Tiles / Fliesen / Dalles: 457,2 x 914,4 mm 12 tiles/box = 5,02m ² 58 boxes/pallet = 291,16m ² | Tiles / Fliesen / Dalles: 304,8 x 609,6 mm 24 tiles/box = 4,46m ² 68 boxes/pallet = 294,36m ² | Tiles / Fliesen / Dalles: 466 x 936 mm 6 tiles/box = 2,62m ² 50 boxes/pallet = 131m ² | Tiles / Fliesen / Dalles: 304,8 x 609,6 mm 12 tiles/box = 2,23m ² 60 boxes/pallet = 133,8m ² |
| Surface treatment / Oberflächenvergütung / Traitement de surface | - | PUR EcoprotectTM | | PUR EcoprotectTM | | | |
| Locking system / Klick System / Type de clic | - | I4F | Dry back / Zum kleben / A collar | Unipush | | | |
| Bevelled edges / Gefaste Kanten (Füge) / Chanfrein | - | Yes / Ja / Oui (Micro bevel) | | Yes / Ja / Oui (Micro bevel) | | | |

| PRODUCT PERFORMANCES | STANDARD | SOLIDE CLICK 30 // SOLIDE CLICK 30 HB | ECO 30 // ECO 30 HB | ECOCLICK 30 |
|---|-----------------------|--|-------------------------|-------------------------|
| Dimensional stability / Dimensionsstabilität / Stabilité dimensionnelle | EN ISO 23999 | ≤ 0,06 % | ≤ 0,10 % | ≤ 0,10 % |
| Castor chair / Schreibtischstuhl / Chaise à roulettes | ISO 4918 | No damage / Keine Schäden / Aucun dommage (Type W) | | |
| Furniture leg / Möbelfüße / Pied de meuble | EN ISO 16581 | No damage / Keine Schäden / Aucun dommage | | |
| Squareness & straightness / Rechtwinklichkeit & Geradheit / Equerrage | EN ISO 24342 | ≤ 0,25 mm | ≤ 0,25 mm | ≤ 0,25 mm |
| Residual indentation / Eindruckverhalten / Poinçonnement statique rémanent | EN ISO 24343-1 | ≤ 0,10 mm | ≤ 0,10 mm | ≤ 0,10 mm |
| Impact sound reduction / Trittschalldämmung / Isolation acoustique | EN ISO 717-2 | ΔLw = 21 dB | ΔLw = 6 dB | ΔLw = 9 dB |
| Light fastness / Lichtechtheit / Solidité lumière | EN ISO 105-B02 | ≥ 6 | ≥ 6 | ≥ 6 |
| Slip resistance / Rutschhemmung / Glissance | DIN 51130 EN 13893 | R10 DS | R10 DS | R10 DS |
| Resistance to chemicals / Chemikalienbeständigkeit / Résistance aux produits chimiques | EN ISO 26987 | Not affected (0) / Nicht verändert (0) / Non affecté (0) | | |
| Thermal resistance / Wärmewiderstand / Conductivité thermique | EN ISO 10456 | 0,04 m ² K/W | 0,02 m ² K/W | 0,04 m ² K/W |
| Curl after exposure to heat / Curling nach Wärmeinwirkung / Incurvation après exposition à la chaleur | EN ISO 23999 | ≤ 2 mm | ≤ 2 mm | ≤ 2 mm |
| Fire resistance / Brandverhalten / Classement feu | EN 13501-1 | Bfl-s1 | Bfl-s1 | Bfl-s1 |
| Electrical properties / Elektrostatische Eigenschaften / Charges électrostatiques | EN 1815 | ≤ 2kV | ≤ 2kV | ≤ 2kV |
| Resistance against staining / Bestimmung der Fleckenempfindlichkeit / Résistance aux tâches | EN 26987 | Passed / Bestanden / Haute résistance | | |
| Underfloor heating suitability / Fußbodenheizung / Compatibilité chauffage par le sol | EN 12524 | Suitable / Geeignet / Compatible - max. 27°C | | |



SOLIDE CLICK 30



ECO30



ECOCLICK30



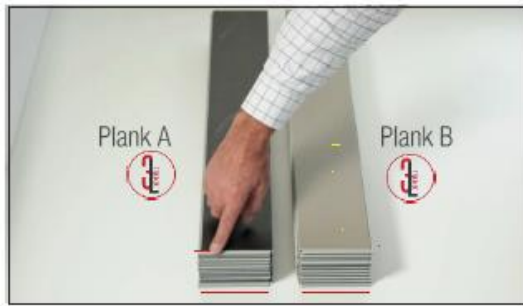

4-SIDED 3L TRIPLELOCK HERRINGBONE

One piece drop-lock system.



CUTTING PLANKS

Lay down the first plank (A) on a leveled surface and place the T-square on top. Make sure the T-square is placed exactly on the corner. While holding down, make an initial cut with the utility knife. Next, place the plank on a higher surface and push down the pre-cut part of the plank to make it snap. Pull the snapped piece upwards to remove completely.



INSTALL 2ND PLANK

Take a second plank (B) and drop it with the long side engaging against the first plank (A) on the short side.



PREPARATION

Tools needed: a tape measure, pen, utility knife, T-square, soft rubber mallet, disassembling wedge.



INSTALL 1ST PLANK

Place the first plank (A) with the cut side against the wall at a 45° angle.



ALIGN AND LOCK

Use the T-square to align the two planks perfectly. Then, tap gently with the soft rubber mallet to lock the planks.



INSTALL 3RD PLANK

Place a third plank (A) with the long side engaging against the second plank (B) on the short side. Again, use the T-square to align the two planks perfectly and tap gently with the soft rubber mallet to lock the planks. Make sure the profile of all planks is facing inwards.



ALIGN ROW AGAINST WALL

After finishing the first row of assembled planks, push it gently all the way against the wall.



FIRST PLANKS A, THEN PLANKS B

Continue each next row by placing all the planks A in a row first, followed by all the planks B. Continue in this way up to the opposite wall is reached. Fill the remaining openings as in figure 9



LAST PLANK IN ROW

Repeat the process until you reach the other wall. Once there, measure the distance from the plank to the wall (including the width of the plank). Mark the measured length of the final plank and cut the plank at a 45° angle at the measure length. Then place the plank following the previous instructions.



FILL IN THE GAPS

Continue by filling in the gaps towards the wall, cutting and measuring the planks as you have previously done. To connect the new plank to the previously assembled row, lift up the assembled planks. Slide the new plank underneath and drop down the assembled planks. Always alternate planks A and B until you have filled all gaps. Don't forget to lock the planks.

Vaata paigaldusvideot
YouTube-st

INSPIRATIONSIOON

