

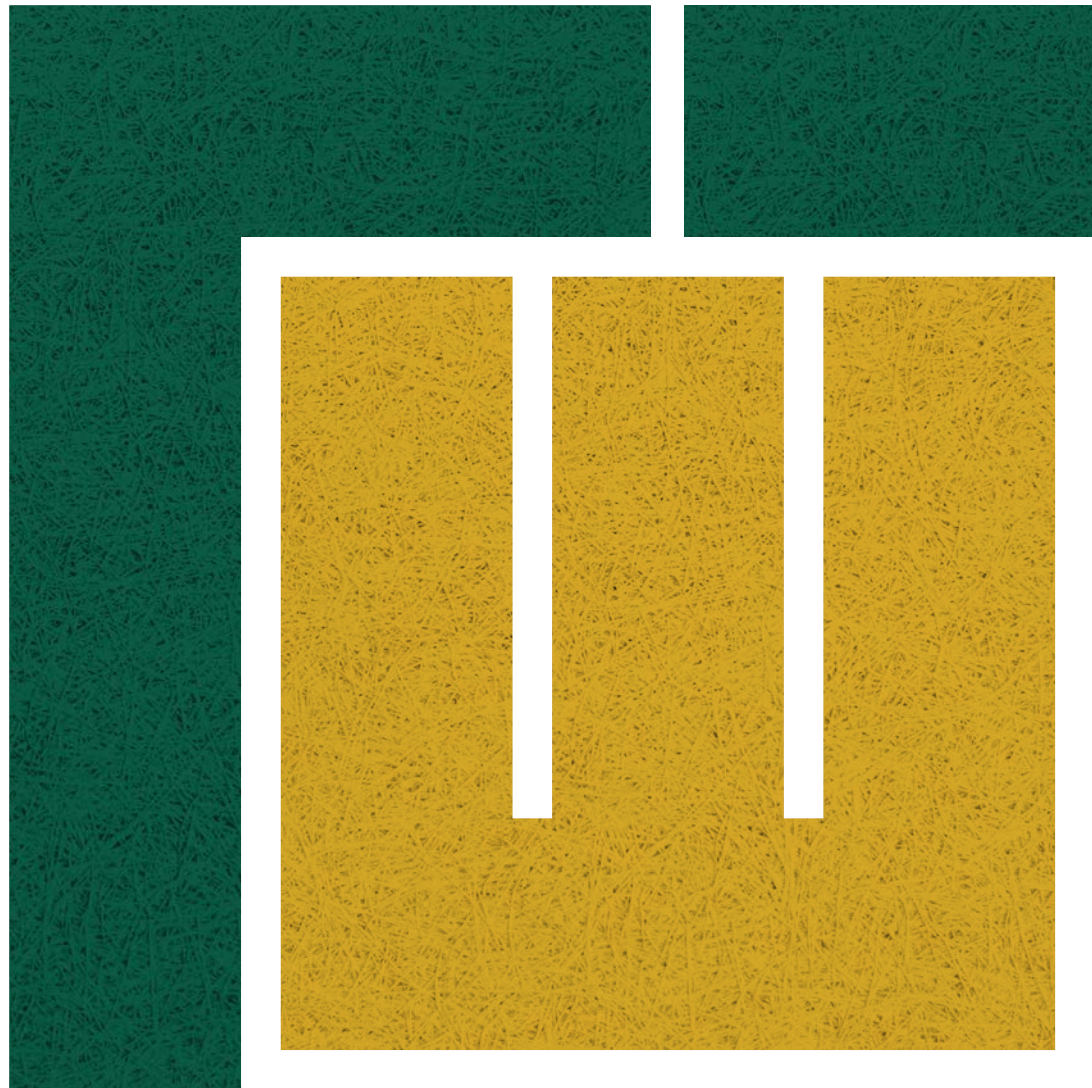

Technical Manual Ceilings





The CEWOOD production line and new factory are located in Jaunlaicene, Latvia, a forest-rich region known for its high-quality timber—the essential raw material for CEWOOD wood wool panels and a key reason for choosing this location. The factory has been purpose-built specifically for wood wool production and has recently been expanded with new factory and facilities, enabling increased production capacity, improved efficiency, and faster delivery while maintaining the highest quality standards.

With many years of experience and a strong focus on precision and sustainability, CEWOOD pays close attention to every detail of the production process. All panels are manufactured using 100% natural raw materials—wood wool, water, and a natural binder—produced in an environmentally responsible way. Continuous research, testing, and certification ensure consistent product performance, durability, acoustic efficiency, and visual quality.

CEWOOD Panels are widely used as finishing materials for acoustic and design solutions in ceilings and

walls. They are installed in a broad range of projects worldwide, including educational institutions, public and cultural buildings, sports facilities, offices, and private homes. Close cooperation with architects, designers, developers, and builders has resulted in numerous inspiring projects that combine functionality, aesthetics, and sustainability.

CEWOOD's ambition is to be among the leading wood wool panel manufacturers globally. This vision drives ongoing investment in factory development, employee training, product innovation, and partner support. Operating internationally, CEWOOD supplies panels across Europe, Scandinavia, North America, and the Middle East, providing reliable service and technical expertise in every market.

This technical manual provides detailed instructions and essential technical information for the installation of CEWOOD Panels in ceiling applications. It is intended to support builders, architects, designers, and installers in achieving high-quality, durable, and acoustically effective results in their projects.

Table of contents

2	About us
4	Benefits
5	Sustainability
6	Key properties of CEWOOD Panels
7	Certificates
8	CEWOOD products for ceilings
9	Application samples
11	Technical data
12	Technical specifications
14	CEWOOD Panels colour variations
15	Important notice on CEWOOD Panel colour tones and painted surfaces
16	CEWOOD Panel handling and installation
18	After installation & maintenance
19	Acoustics
20	Acoustic data for specific ceiling constructions
24	Acoustic values and classification
25	Panels for mounting with screws
26	Profile specifications for screw-mounted panels
27	Screwing instructions
28	Suspended ceilings on CD profile frame
30	Suspended ceilings on wooden laths
32	Ceilings on CEWOOD clips
33	Panels for suspension in T-type profile frame ceilings
34	Profile specifications for suspended ceilings panels
36	Visible T-type profile frame assembly
38	Hidden T-type profile frame assembly
40	Hallway solution
41	Integrated opening solutions and panel accessories
42	Installation of lights, speakers and similar devices into CEWOOD Panels
43	CEWOOD Ceiling layout guidelines
44	CEWOOD Inspection hatches
45	CEWOOD Panel screw

About us



CEWOOD factory in Jaunlaicene, Latvia

Values that last

Forests cover more than half of Latvia's area, offering the feeling of peaceful comfort and giving you energy to embark on new adventures.

For 55 years now, we at CEWOOD have been walking hand-in-hand with forests, respecting, preserving and making use of this impressive natural asset.

We are now among global leaders in the industry, and we have made sustainability one of our key goals, therefore we use only three natural elements in our panels. The combination of these elements offers a special strength that translates into unique benefits – our panels ensure outstanding sound absorption and thermal inertia, as well as excellent fire resistance, inspiring aesthetic result, beneficial effects on microclimate and health. Furthermore, each panel is the work of experienced craftsmen, guaranteeing premium quality, durability and longevity.

People are always striving for something new and inspiring in their ideas, which is why we work hand in hand with industry experts and scientists to find even more uses for wood wool.



Main export markets

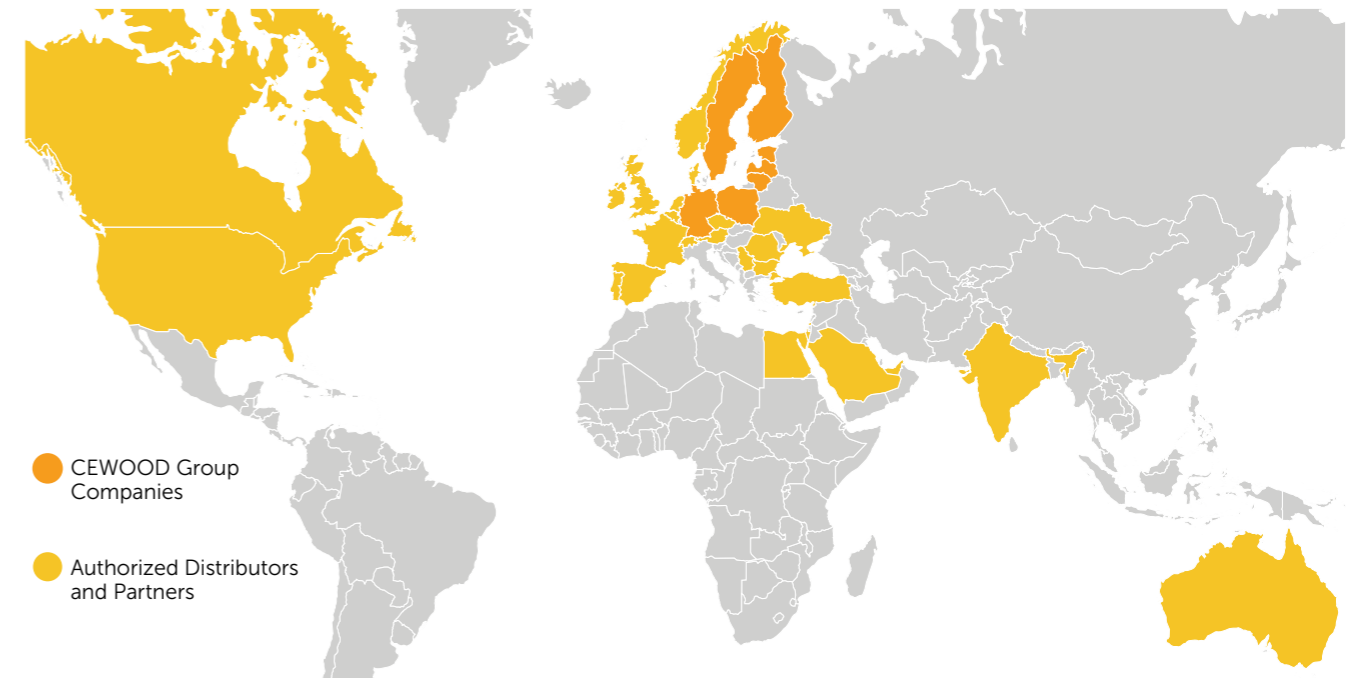

- An efficient production and logistics process allows to offer fast deliveries to the most demanded panels.
- Export deliveries are provided from the factory's warehouse, with an average of up to 20 containers and truckloads per week.





Benefits

- **ACOUSTICS** – sound-absorbing panels for a peaceful day-to-day life
- **ECOLOGY** – natural materials for the harmony of the environment and people
- **HEALTH** – clean panels for a pleasant and comfortable living space
- **AESTHETICS** – extensive design possibilities for your soaring imagination
- **LONGEVITY** – durable materials to last for generations
- **USABILITY** – easy transport and assembly for easier work
- **FIRE SAFETY** – superb fire safety for everyday peace of mind

Sustainability

Wood

The wood used in production is spruce from local forests (harvested within 100 km from production facilities). CEWOOD is certified, and certification is our priority when purchasing timber to guarantee that the wood originates from responsibly managed forests.

Wood wool

CEWOOD wood wool panels are made of 100% natural ingredients: wood wool, cement and water.

Cement

CEWOOD production uses two types of high-quality Portland cement – white and grey. White Portland cement is mainly used for CEWOOD Panels and design tiles, while grey Portland cement is used for building panels. Our suppliers extract raw materials with minimal environmental impact.



Water

Water used in the production process is from the local, 80 m deep artesian well.

Certificates & compliances

CEWOOD Panels meet internationally recognised requirements for construction, quality and sustainability. Our products comply with building regulations and industry standards, confirming safety, durability and environmental responsibility

Renewable energy certificate

CEWOOD recognises the importance of sustainability and responsible use of natural resources. Electricity used in all production facilities is sourced from 100% renewable energy, verified through a Guarantee of Origin (GO) in accordance with national regulations.

Recycling of construction and demolition waste

- Wood wool panels are very durable; they can last in buildings for more than 50 years. Therefore, proper disposal of old wood wool panels and leftover panels from the construction/installation process is very important.
- Avoid discharge to drain or surface water or any other area that is not suitable for waste disposal. Contact the local authorities regarding the proper waste disposal process.
- CEWOOD cooperates with local universities to find the best solutions for a full recycling process or reuse of used panels or their ingredients.



Key properties of CEWOOD Panels

Acoustic and aesthetic excellence in one solution

One of the most celebrated features of CEWOOD Panels is their excellent sound absorption performance. Made of fine wood fibers arranged in an open, breathable structure, the panels effectively absorb sound waves, reducing reflections and preventing echo. Instead of bouncing back into the room, sound is captured within the material's natural texture.

Spaces finished with CEWOOD Panels experience noticeably lower background noise, clearer sound, and improved speech intelligibility – creating a calmer and more comfortable atmosphere. These sound absorption benefits are combined with the panels' natural aesthetics and practical advantage: fast, straightforward installation that delivers a fully finished surface without additional steps.

In summary, CEWOOD Panels transform echoey rooms into quiet, cozy, and pleasant environments wherever controlled reverberation is needed, offering enhanced comfort without complex calculations or specialist involvement.

Reliable fire safety with natural material



CEWOOD Panels are outstandingly fire safe – an impressive feature given their natural wood fiber composition.

The cement binder encapsulates and protects the wood fibers, giving CEWOOD Panels a class-leading fire reaction rating of A2 or B, depending on type. This makes them highly resistant to ignition and flame spread, while producing very little smoke in the event of fire.

By integrating CEWOOD Panels into a building, you add an extra layer of fire protection and gain valuable time in an emergency – improving overall building resilience and providing long-term peace of mind for both occupants and designers.

Health, comfort, and a naturally balanced climate

Their wood-fiber structure keeps the air feeling just right by absorbing excess moisture when the room is damp and releasing it again when the air becomes too dry. This gentle, natural process keeps rooms feeling fresh and pleasant throughout the year.

By "working with the room," CEWOOD Panels help prevent condensation, damp corners, and mold. The cement layer around each fiber keeps the material strong and stable, so the panels do not swell, warp, or lose their shape – even in rooms with higher humidity. Their warm, natural texture remains beautiful and long-lasting.

Free from harmful chemicals, CEWOOD Panels support a healthier indoor environment, combining the comfort of natural materials with long-term durability to create interiors that feel genuinely good to live in.

Built for ease, designed for perfection. Enduring to enjoy

Despite their solid appearance, CEWOOD Panels are light and easy to handle, allowing quick and precise installation without special tools. They can be cut, drilled, and shaped with standard carpentry tools, then fastened to wooden or metal structures or fitted into ceiling grids. Their consistent dimensions ensure clean alignment and a finished look immediately after installation.

Once installed, CEWOOD Panels require minimal upkeep. Their durable structure withstands everyday use while maintaining its form and appearance, supporting long-lasting and reliable performance.

Certificates

Declaration of Performance (DoP)

The Declaration of Performance (or DoP) is an official declaration of the product's performance in terms of its essential product characteristics with identifying information about who placed the product in the European market. Certification according to standard EN 13168:2012+A1:2015

EPD (Environmental Product Declaration)

The Declaration is a document issued by third parties containing declared and available transparent information about the impact of product manufacturing cycle on the environment. This document meets the goals set forth by CEWOOD regarding sustainable products and manufacturing.

Emission classification of building materials (M1)

The M1 classification is a voluntary Finnish system for assessing emissions from building materials and interior components. It sets strict limits for volatile organic compounds (VOC), formaldehyde, ammonia, and odour levels to ensure good indoor air quality. Products awarded the M1 label are laboratory tested and verified as low-emitting. The classification is widely recognized and used to promote healthy indoor environments.

Natureplus

Natureplus is an internationally recognized certification for sustainable building materials that meet strict requirements for environmental safety, health, and functionality. It verifies that CEWOOD Panels comply with high ecological and performance standards throughout production.

Indoor Air Comfort Gold

This certification guarantees that the product meets the most stringent European requirements for indoor air quality and low VOC emissions. It combines multiple national emission labels into one high-level European certification.

CE marking

CE marking is a certification mark that indicates conformity with health, safety, and environmental protection standards for products sold within the European Economic Area (EEA). Certification according to LVS EN 13168:2012+A1:2015

FSC® (FSC-C170780)

FSC® (Forest Stewardship Council®) certification ensures that products come from responsibly managed forests providing environmental, social, and economic benefits. CEWOOD products are Chain of Custody certified under FSC Mix and FSC Controlled Wood.

PEFC™ (12-31-030)

PEFC™ (Programme for the Endorsement of Forest Certification) is an international non-profit organization promoting sustainable forest management through independent third-party certification. CEWOOD meets PEFC ST 2002:2020 and PEFC Trademark Rules – Requirements PEFC ST 2001:2020.

ISO 14001 / ISO 50001

ISO 14001 defines requirements for environmental management systems, while ISO 50001 focuses on energy management. Together they support continuous improvement in resource efficiency, sustainability, and energy performance. Standards: LVS EN ISO 14001:2015 and LVS EN ISO 50001:2012.

Renewable Energy Certificate

This certificate confirms that CEWOOD purchases and uses electricity generated from 100% renewable energy sources in Latvia. The renewable origin of the consumed electricity is verified annually through a Renewable Energy Certificate (Guarantee of Origin) issued in accordance with national regulations.

Cradle to Cradle

Cradle to Cradle Certified® is an internationally recognised certification evaluating material health, circularity and environmental performance. It confirms that CEWOOD Acoustic Panels are developed using safe materials and resource-efficient processes, supporting sustainable and circular construction.



For more information about CEWOOD certifications – including additional certificates – please visit cewood.com under the Downloads section and scan the provided QR code.

CEWOOD products for ceilings

CEWOOD Panels



Standard CEWOOD Panels combine high sound absorption with natural aesthetics. Made from wood wool and cement, they provide durable, sustainable acoustic solutions for ceilings and walls in offices, schools, and public spaces.

CEWOOD PLUS Panels



Backside



CEWOOD PLUS panels feature an integrated mineral wool layer that achieves maximum sound absorption (Class A). They are an ideal choice for spaces with high acoustic demands such as studios, auditoriums, and conference halls.

CEWOOD FLEECE Panels

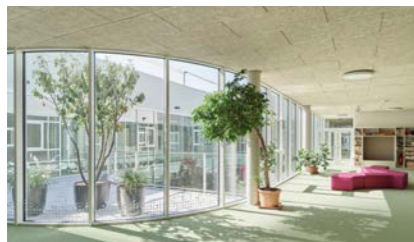

Backside



The CEWOOD FLEECE Panel includes an additional acoustic fleece backing, enhancing sound absorption while keeping a slim profile. Lightweight, easy to install, and perfect for modern interiors where both design and performance matter.

CEWOOD Barcode



CEWOOD Barcode panels feature precisely milled recessed lines that create a modern and distinctive visual accent, providing a clean and aesthetic rhythm in both ceiling and wall designs.



Application samples

CEWOOD panels are widely used in the interiors of public and residential buildings. They are highly suitable for suspended ceiling constructions and wall decoration. Owing to their natural composition and outstanding features, they are widely used in premises with increased acoustic load, where sound reverberation (reflection) time and noise absorption play an important role.

Offices, public buildings and private residences

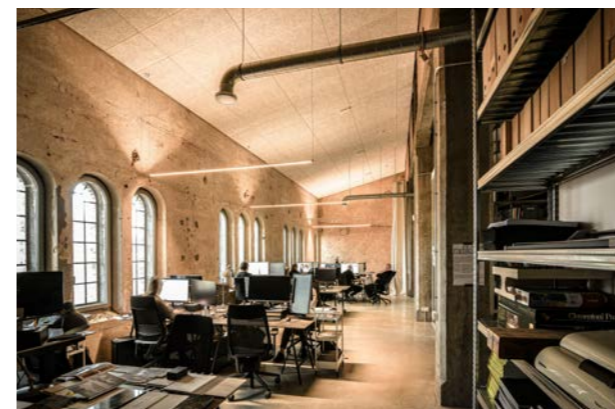

In open-plan offices, meeting rooms and public spaces, CEWOOD Panels provide sound absorption, reduce noise and improve the working environment.

Schools, kindergartens, universities

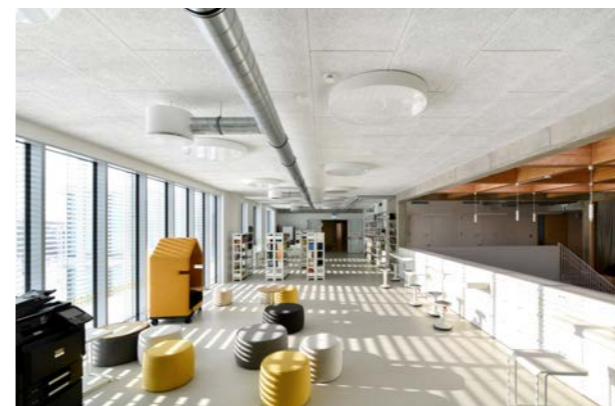

Thanks to the acoustic properties, CEWOOD Panels are widely used in educational institutions. They improve the acoustic comfort of the premises and provide a favourable microclimate.

Sport centres, swimming pools, spa



CEWOOD Panels not only provide sound absorption, but also absorb excess moisture and do not change their properties in rooms with elevated humidity.

Culture centres, theaters, cinemas



In the public entertainment rooms, CEWOOD Panels finishing provides a significant increase in the acoustic microclimate to meet the highest industry standards.

Record studios, TV and radio stations



CEWOOD Panels offer professional-grade soundproofing to effectively absorb noise and minimize sound reflection.

Industrial premises, warehouses, parking lots



CEWOOD Panels are a great noise reduction solution for production facilities and parking lots, as they absorb sound thus reducing noise levels and increasing acoustic comfort.

Technical data

- 12 Technical specifications
- 14 CEWOOD Panels colour variations
- 15 Important notice on CEWOOD Panel colour tones and painted surfaces
- 16 CEWOOD Panel handling and installation
- 18 After installation & maintenance



Technical specifications

CEWOOD Panels are a durable and nature-friendly material made of top-quality wood wool and cement. By combining low fire reaction with good acoustic and heat inertia properties, the product offers the widest variety of design solutions.

CEWOOD Panels



*Available panel thickness depending on wood wool width

Thickness	mm	15	25	35	50
Size (standard panel)	mm	2400x600; 1200x600; 600x600			
Size (for suspended ceilings)	mm	1195x595; 595x595			
Dimensional tolerance (EN 13168)		L4; W2; T2; S2; P2			
Weight	kg/m ²	7.0	10.5	14.5	19.5
Density	kg/m ³	470	420	410	390

Thermal resistance (Ro)	m ² ·K/W	0.20	0.35	0.50	0.70
Thermal conductivity (λD)	W/m·K	0.069			
Bend (EN 12089)	kPa	≥ 1700	≥ 1300	≥ 1000	≥ 700
Compression (EN 826)	kPa	≥ 300	≥ 300	≥ 200	≥ 200
Chloride content (EN 13168)	%	≤ 0,06 class Cl3			
Reaction to fire (EN 13501-1:2007)		B-s1, d0			



For more information about CEWOOD Panels specification please scan the provided QR code.

CEWOOD A2 Panels - improved fire safety class

CEWOOD A2 Panels are intended for ceiling and wall applications where large interior surface areas require a higher reaction to fire class, with ceiling solutions as the primary application. According to EN 13501-1, classification A2-s1, d0 defines a practically non-combustible material with very limited heat release, minimal smoke development, and no flaming droplets or particles.

Fire performance of CEWOOD A2 Panels is achieved through a mineral cement binder that encapsulates the wood wool fibres, ensuring predictable and stable behaviour under fire exposure, limiting fire development from ceiling and wall surfaces, and supporting safer evacuation by reducing smoke and secondary fire risks.

CEWOOD A2 Panels are particularly suitable for applications with increased fire safety requirements, such as educational buildings, healthcare facilities, and industrial spaces.



*Available panel thickness depending on wood wool width

Thickness	mm	15	25	35
Size (standard panel)	mm	2400x600; 1200x600; 600x600		
Size (for suspended ceilings)	mm	1195x595; 595x595		
Dimensional tolerance (EN 13168)		L4; W2; T2; S2; P2		
Weight	kg/m ²	12.5	14.5	20.5
Density	kg/m ³	830	580	585

Thermal resistance (Ro)	m ² ·K/W	0.15	0.25	N/A
Thermal conductivity (λD)	W/m·K	0.087		
Bend (EN 12089)	kPa	≥ 1700	≥ 1300	≥ 1000
Compression (EN 826)	kPa	≥ 500	≥ 500	≥ 200
Chloride content (EN 13168)	%	≤ 0,06 class Cl3		
Reaction to fire (EN 13501-1:2007)		A2-s1, d0		

CEWOOD Panels colour variations

CEWOOD wood wool panels are available:

- non-painted,
- in standard colours,
- in any other colour upon client's request according to RAL or NCS paint catalogues.



The standard colour range for CEWOOD wood wool panels includes non-painted natural, natural painted, white, grey, and black finishes. The palette has now been expanded with two new shades of grey.



*The RAL colour code is indicative and intended for information only. Colour tones may vary on different surfaces and under different lighting conditions.

**The tone of unpainted panels may vary due to the natural characteristics of the wood. If an even tonality is essential, we recommend natural painted (NP) panels.

Light reflectance value

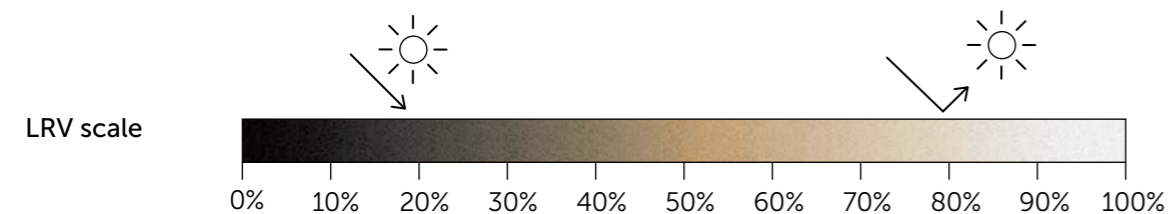

When selecting CEWOOD Panel colour, it's important to consider the Light Reflectance Values (LRV). LRV is measured on a scale that ranges from zero (absolute black, absorbing all light) to 100 percent (pure white, reflecting all light).

Important notice on CEWOOD Panel colour tones and painted surfaces

Colour tone warning for non-painted CEWOOD Panels

CEWOOD Panels are made from high-quality Latvian wood, a natural material whose tone may vary due to species, growth conditions, drying rate, and manufacturing process.

- ⓘ When choosing unpainted CEWOOD Panels, note that each panel may vary slightly in tone – a natural characteristic of real wood that gives the surface its authentic look. For a more uniform appearance, CEWOOD recommends panels painted in natural colour. In both cases, the panels meet all quality requirements.

Sample with CEWOOD non-painted panels



Sample with CEWOOD natural painted panels



Precautions and guidelines for panels in dark colours

CEWOOD Panels are produced with great care, but dark-coloured panels require extra caution due to the strong contrast between paint and the natural wood wool texture. Slight tone or texture variations are natural, and the wood wool texture may remain visible under dark paint. Because of their dark finish, these panels are more sensitive to dust and handling marks and should be installed last, after all other construction works. For the best appearance, minor retouching may be needed – CEWOOD recommends using original CEWOOD paint to ensure a perfect tone match. Panels are packed face-to-face with protective foil; keep the foil between panels and handle them in pairs to avoid surface damage.

For more detailed information, please refer to the "CEWOOD Panel handling and installation" and "After installation & maintenance" sections.



CEWOOD Panel handling and installation

1. General safety precautions

1.1 Personal protective equipment (PPE):

- Always wear suitable PPE, including gloves and safety goggles. ①

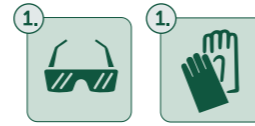

1.2 Delivery inspection:

- Upon receiving the delivery, visually inspect the load before unloading to ensure there are no transport-related damages such as impacts, broken edges, or visible moisture. ②



2. Transportation

2.1 Loading and unloading:

- Use appropriate mechanical lifting equipment (forklift or crane) with proper lifting attachments. ③
- Ensure all pallets are securely strapped and protected to prevent shifting, vibration, or edge damage during transportation.



3. Storage

3.1 Storage environment:

- Store panels in a dry, well-ventilated area, away from direct sunlight and extreme temperatures. Prevent contact with water or damp surfaces. ④
- Avoid exposing panels to direct heat sources or uneven drying conditions, as this may cause the material to deform or dry irregularly.



3.2 Stacking and protection:

- Stack panels horizontally on flat, stable, level surfaces.
- Use pallets or raised platforms to keep the panels off the ground, and place spacers or battens between layers to allow air movement during acclimatization to the room's ambient conditions. ⑤
- Cover stacked panels with waterproof breathable sheeting to protect from dust and moisture.



3.3 Acclimatization requirements:

- Remove packaging material to avoid condensation buildup during acclimatization.
- Recommended acclimatization conditions: +23°C (±2°C) and 50% (±5%) relative humidity. ⑥
- Keep panels stored horizontally throughout acclimatization.
- Panels must adjust to the natural indoor climate of the building for 1–2 weeks before installation. During this period, heating systems must remain switched off to prevent uneven drying or deformation. ⑦

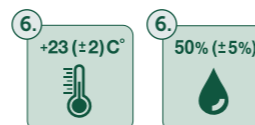

3.4 Additional precautions:

- Dark-coloured panels require extra care due to the contrast between natural texture and paint.
- Avoid dust, humidity, and direct sunlight during storage.
- Keep protective foil between panels as long as possible.

4. Handling

4.1 Manual handling:

- Do not lift large panels alone. Lift one side of the panel so it is supported by the long edge on a solid surface. This way you can move the panel around, thereby preventing bending or cracking. ⑧
- Hold the panels by the edges to maintain balance and avoid flexing.
- Avoid sudden movements or impacts that may cause chipping or surface damage.
- Ensure the carrying path is clean and free of obstacles to prevent accidental impacts.



5. Installation

5.1 Site preparation:

- Ensure the installation site is dry, clean, and the substructure is level. ⑨
- Plan the layout and cutting to reduce excess handling and material waste.



5.2 Cutting:

- Wear suitable PPE, including a dust mask and safety glasses, during all cutting operations.
- Use proper cutting tools such as angle saw, undamaged hand saw or circular saws with dust extraction systems to minimize dust accumulation.
- For the best edge quality, cut panels with the reverse side facing down and use a fine-toothed blade
- To recreate beveled edges, sand the edges with sandpaper wrapped around a straight piece or use a sanding block. ⑩



5.3 Attachment:

- Follow CEWOOD technical guidelines for attachment methods. ⑪
- Pre-drill holes if necessary to prevent misalignment of screws.
- Do not over-tighten the screws. The screw head must be flush with the panel surface. ⑫



5.4 Finishing:

- Follow CEWOOD recommendations in the "After installation & maintenance" section for any additional treatments and finishing touches.

After installation & maintenance

1. General information

1.1 Initial cleaning:

- A few weeks after installation, small dust particles may be present due to the mounting process. Remove any dust using a vacuum cleaner with a brush nozzle. **13**
- If the panels become slightly dusty or marked during installation, clean the surface gently with a damp cloth. **14**
- If any mounting works cause minor surface defects, they can be treated with fine sandpaper, following the panel structure. **14**



1.2 Repainting:

- If necessary, the colouring of the panels can be refreshed using a brush or a long-haired paint roller. It is recommended to use a water-based paint for repainting. **15**



1.3 Regular maintenance:

- Once installed, CEWOOD Panels do not require any specific additional maintenance.
- Surface cleaning can be carried out together with the general cleaning of the premises.
- General cleaning is simple and can be performed with a vacuum cleaner with a brush nozzle. If extra cleaning is required, use a damp cloth. **16**
- For repainting or refreshing the colour, use original CEWOOD paints to ensure an identical colour tone and surface structure. **16**



1.4 Additional precautions:

- After installation, dark-coloured panels may require minor post-treatment due to the strong contrast between paint and natural wood texture. Small scratches, dust marks or light handling traces may become visible after mounting; these can be retouched using a brush for small areas or a roller for larger surfaces.
- Natural wood fibres may still be slightly visible under certain lighting conditions – this is a normal feature of the material and does not affect product quality or performance.
- Substantial filling of the panel structure with paint may reduce sound-absorbing properties.
- When repainting, use the exact colour tone. If in doubt, contact the manufacturer or distributor.

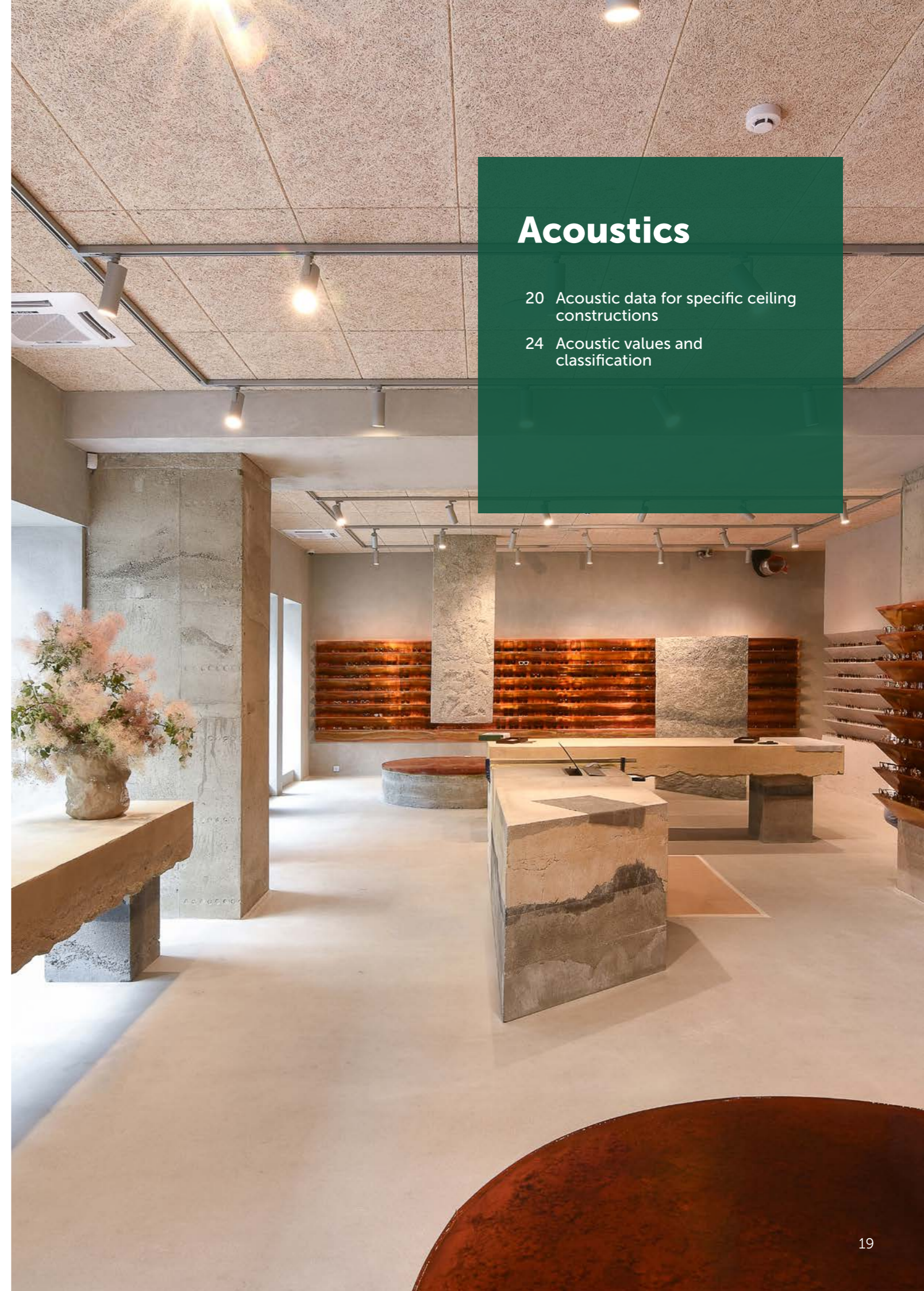

Acoustics

- 20 Acoustic data for specific ceiling constructions
- 24 Acoustic values and classification

Acoustic data for specific ceiling constructions

The acoustic performance values correspond to suspended ceiling installation.

- 15 mm panels for T-type profile ceilings only
- (MW) - Mineral wool density 70–90 kg/m³



Direct fixing without air gap

Installation Cross-Section	Panel thickness A (mm)	Description	Absorption		Frequency					
			Class	α _w	125 Hz	250 Hz	500 Hz	1000 Hz	2000 Hz	4000 Hz
Direct fixing without mineral wool										
	15	CEWOOD Panel 15 mm	D	0.30	0.05	0.10	0.20	0.35	0.60	0.85
	25	CEWOOD Panel 25 mm	D	0.40	0.05	0.20	0.35	0.55	0.90	0.75
	35	CEWOOD Panel 35 mm	D	0.50	0.15	0.25	0.45	0.80	0.90	0.85
	25	CEWOOD Barcode 25 mm	D	0.35	0.05	0.15	0.25	0.45	0.80	0.75
	35	CEWOOD Barcode 35 mm	D	0.45	0.05	0.20	0.40	0.75	0.80	0.95
Direct fixing with mineral wool										
	25	CEWOOD Panel 25 mm, mineral wool 40 mm, H - 65 mm	A	1.00	0.25	0.75	1.00	1.00	0.90	1.00
	35	CEWOOD Panel 35 mm, mineral wool 40 mm, H - 75 mm	A	1.00	0.30	0.80	1.00	1.00	0.95	1.00
	25	CEWOOD Barcode 25 mm, mineral wool 40 mm, H - 65 mm	A	0.95	0.25	0.75	1.00	1.00	0.90	1.00
	35	CEWOOD Barcode 35 mm, mineral wool 40 mm, H - 75 mm	A	0.95	0.25	0.75	1.00	0.95	0.90	1.00

Installation with an air gap

Installation Cross-Section	Panel thickness A (mm)	Description	Absorption		Frequency					
			Class	α _w	125 Hz	250 Hz	500 Hz	1000 Hz	2000 Hz	4000 Hz
Installation without mineral wool										
	15	CEWOOD Panel 15 mm, Air gap - 185 mm	D	0.50	0.20	0.35	0.50	0.40	0.50	0.60
	25	CEWOOD Panel 25 mm, Air gap - 175 mm	C	0.60	0.20	0.45	0.60	0.50	0.60	0.80
	35	CEWOOD Panel 35 mm, Air gap - 165 mm	D	0.55	0.25	0.45	0.55	0.45	0.65	0.80
	25	CEWOOD Barcode 25 mm, Air gap - 175 mm	D	0.60	0.20	0.45	0.60	0.45	0.55	0.80
	35	CEWOOD Barcode 35 mm, Air gap - 165 mm	C	0.55	0.25	0.55	0.65	0.50	0.70	0.90

Installation with an air gap

Installation Cross-Section	Panel thickness A (mm)	Description	Absorption		Frequency					
			Class	α _w	125 Hz	250 Hz	500 Hz	1000 Hz	2000 Hz	4000 Hz
Installation with mineral wool – air gap 100 mm										
	15	CEWOOD Panel 15 mm, mineral wool 20 mm, H - 135 mm	A	0.95	0.35	0.70	1.00	1.00	0.90	0.80
	25	CEWOOD Panel 25 mm, mineral wool 20 mm, H - 145 mm	A	1.00	0.30	0.75	1.00	1.00	0.95	1.00
	35	CEWOOD Panel 35 mm, mineral wool 20 mm, H - 155 mm	A	1.00	0.35	0.80	1.00	1.00	0.90	1.00
	25	CEWOOD Barcode 25 mm, mineral wool 20 mm, H - 145 mm	A	1.00	0.30	0.75	1.00	1.00	0.95	0.95
	35	CEWOOD Barcode 35 mm, mineral wool 20 mm, H - 155 mm	A	0.95	0.35	0.80	1.00	0.95	0.90	1.00
Installation with mineral wool – total construction height 200 mm										
	15	CEWOOD Panel 15 mm, mineral wool 20 mm, air gap - 165 mm	A	0.95	0.45	0.80	1.00	1.00	0.95	0.80
	25	CEWOOD Panel 25 mm, mineral wool 20 mm, air gap - 155 mm	A	1.00	0.45	0.80	1.00	1.00	0.95	1.00
	35	CEWOOD Panel 35 mm, mineral wool 20 mm, air gap - 145 mm	A	1.00	0.40	0.80	1.00	1.00	0.90	1.00
	25	CEWOOD Panel 25 mm, mineral wool 20 mm, air gap - 155 mm	A	1.00	0.40	0.80	1.00	1.00	0.95	0.95
	35	CEWOOD Panel 35 mm, mineral wool 20 mm, air gap - 145 mm	A	1.00	0.40	0.80	1.00	0.95	0.90	1.00
Installation with FLEECE – air gap 100 mm										
	15	CEWOOD Panel 15 mm, FLEECE, H - 115 mm	B	0.80	0.25	0.50	0.85	0.85	0.80	0.85
	25	CEWOOD Panel 25 mm, FLEECE, H - 125 mm	A	0.90	0.25	0.60	0.95	0.95	0.90	0.90
	35	CEWOOD Panel 35 mm, FLEECE, H - 135 mm	A	0.95	0.35	0.65	0.95	1.00	0.95	0.90
Installation with FLEECE – total construction height 200 mm										
	15	CEWOOD Panel 15 mm, FLEECE, air gap - 185 mm	B	0.80	0.40	0.70	0.90	0.75	0.80	0.85
	25	CEWOOD Panel 25 mm, FLEECE, air gap - 175 mm	A	0.90	0.35	0.75	0.95	0.85	0.90	0.95
	35	CEWOOD Panel 35 mm, FLEECE, air gap - 165 mm	A	0.95	0.45	0.75	0.95	0.95	0.95	0.90



The following acoustic data applies to the **A2 panels** - version with an improved fire safety class.

Direct fixing without air gap

Installation Cross-Section	Panel thickness A (mm)	Description	Absorption		Frequency					
			Class	α_w	125 Hz	250 Hz	500 Hz	1000 Hz	2000 Hz	4000 Hz
Direct fixing without mineral wool										
	15	CEWOOD A2 Panel 15 mm	D	0.30	0.05	0.10	0.20	0.35	0.65	0.90
	25	CEWOOD A2 Panel 25 mm	D	0.35	0.05	0.15	0.30	0.55	0.90	0.75
	35	CEWOOD A2 Panel 35 mm	D	0.40	0.05	0.20	0.35	0.65	0.75	0.75
	25	CEWOOD A2 Barcode 25 mm	D	0.35	0.10	0.15	0.30	0.55	0.90	0.80
Direct fixing with mineral wool										
	25	CEWOOD A2 Panel 25 mm, mineral wool 40 mm, H - 65 mm	A	0.95	0.25	0.80	1.00	0.95	0.85	1.00
	35	CEWOOD A2 Panel 35 mm, mineral wool 40 mm, H - 75 mm	A	1.00	0.35	0.80	1.00	1.00	0.90	1.00
	35	CEWOOD A2 Barcode 35 mm, mineral wool 40 mm, H - 75 mm	A	1.00	0.25	0.85	1.00	0.95	0.90	1.00

Installation with an air gap

Installation Cross-Section	Panel thickness A (mm)	Description	Absorption		Frequency					
			Class	α_w	125 Hz	250 Hz	500 Hz	1000 Hz	2000 Hz	4000 Hz
Installation without mineral wool										
	15	CEWOOD A2 Panel 15 mm, Air gap - 185 mm	D	0.45	0.20	0.30	0.45	0.35	0.45	0.55
	25	CEWOOD A2 Panel 25 mm, Air gap - 175 mm	D	0.50	0.20	0.40	0.50	0.40	0.50	0.70
	35	CEWOOD A2 Panel 35 mm, Air gap - 165 mm	D	0.55	0.20	0.50	0.60	0.45	0.65	0.85
Installation with mineral wool – air gap 100 mm										
	15	CEWOOD A2 Panel 15 mm, mineral wool 20 mm, H - 135 mm	A	0.95	0.35	0.70	1.00	1.00	0.95	0.80
	25	CEWOOD A2 Panel 25 mm, mineral wool 20 mm, H - 145 mm	A	0.95	0.35	0.75	1.00	1.00	0.90	0.95
	35	CEWOOD A2 Panel 35 mm, mineral wool 20 mm, H - 155 mm	A	1.00	0.35	0.80	1.00	1.00	0.90	1.00

Installation with an air gap

Installation Cross-Section	Panel thickness A (mm)	Description	Absorption		Frequency					
			Class	α_w	125 Hz	250 Hz	500 Hz	1000 Hz	2000 Hz	4000 Hz
Installation with mineral wool – total construction height 200 mm										
	15	CEWOOD A2 Panel 15 mm, mineral wool 20 mm, air gap - 165 mm	A	0.95	0.45	0.80	1.00	1.00	0.95	0.80
	25	CEWOOD A2 Panel 25 mm, mineral wool 20 mm, air gap - 155 mm	A	1.00	0.45	0.80	1.00	1.00	0.90	0.95
	35	CEWOOD A2 Panel 35 mm, mineral wool 20 mm, air gap - 145 mm	A	1.00	0.40	0.80	1.00	1.00	0.90	1.00
Installation with FLEECE – air gap 100 mm										
	15	CEWOOD A2 Panel 15 mm, FLEECE, H - 115 mm	B	0.80	0.25	0.50	0.85	0.90	0.80	0.85
	25	CEWOOD A2 Panel 25 mm, FLEECE, H - 125 mm	B	0.85	0.30	0.55	0.90	0.95	0.90	0.85
	35	CEWOOD A2 Panel 35 mm, FLEECE, H - 135 mm	A	0.95	0.35	0.65	1.00	1.00	0.95	0.95
Installation with FLEECE – total construction height 200 mm										
	15	CEWOOD A2 Panel 15 mm, FLEECE, air gap - 185 mm	B	0.80	0.45	0.70	0.90	0.75	0.80	0.90
	25	CEWOOD A2 Panel 25 mm, FLEECE, air gap - 175 mm	A	0.90	0.45	0.70	0.95	0.85	0.90	0.85
	35	CEWOOD A2 Panel 35 mm, FLEECE, air gap - 165 mm	A	0.95	0.45	0.75	1.00	0.95	0.95	0.95



More detailed information about the acoustic performance of CEWOOD Panels in different constructions is available by scanning the provided QR code.

Acoustic values and classification

CEWOOD Panels combine reliable durability with excellent acoustic performance, effectively absorbing sound, reducing echo, and unwanted reflections. Their open wood-wool structure supports a pleasant indoor atmosphere and clearer sound, improving overall acoustic quality.

For higher acoustic efficiency, particularly in large spaces, CEWOOD Panels can be designed as three-dimensional elements such as pyramids or profiled surfaces. These shapes increase sound diffusion and diffraction around edges, resulting in improved sound absorption across a wider frequency range and better reverberation control.

The acoustic performance of CEWOOD Panels is determined according to EN ISO 11654 and EN ISO 354. EN ISO 11654 expresses sound absorption as a weighted coefficient, a_w , which reflects the overall effectiveness of the material; for example, $a_w = 0.90$ indicates that approximately 90% of incoming sound energy is absorbed. The standard also defines absorption classes from A to D. EN ISO 354 describes how sound absorption is measured across low, mid, and high frequencies.

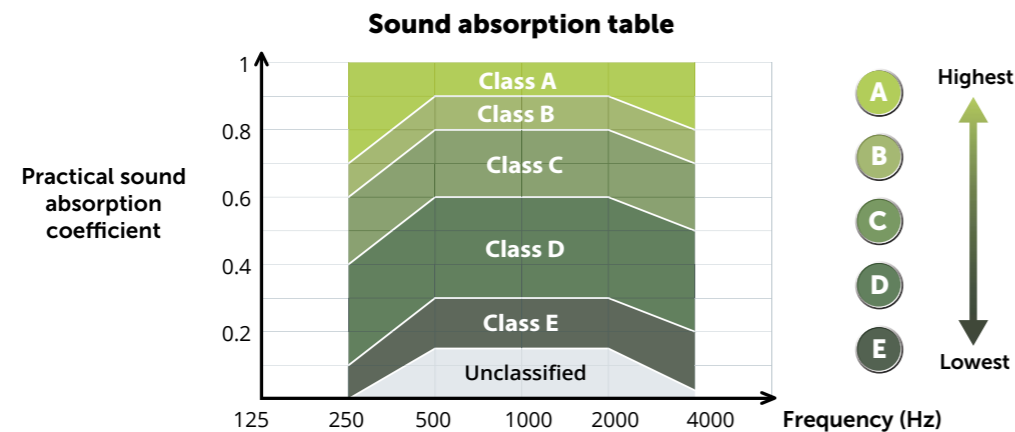

Sound absorption classes characterize a material's ability to absorb sound and make it easier to compare the acoustic effectiveness of different materials:

- Class A** – Highest sound absorption ($0.90 \leq a_w \leq 1.00$); typically equivalent to absorbing ~90% or more of incident sound per m^2 , suitable for spaces with high acoustic requirements (e.g., concert halls, studios).
- Class B** – Good sound absorption ($0.80 \leq a_w < 0.90$), suitable for offices, schools and other public spaces.
- Class C** – Moderate sound absorption ($0.60 \leq a_w < 0.80$), suitable for areas with medium acoustic requirements.
- Class D** – Lower sound absorption ($0.30 \leq a_w < 0.60$), often chosen for other properties such as design or structural considerations.

Depending on the installation method, CEWOOD Panels achieve sound absorption performance ranging from **Class D** up to **Class A**, providing solutions suitable for both standard and high-demand acoustic environments.

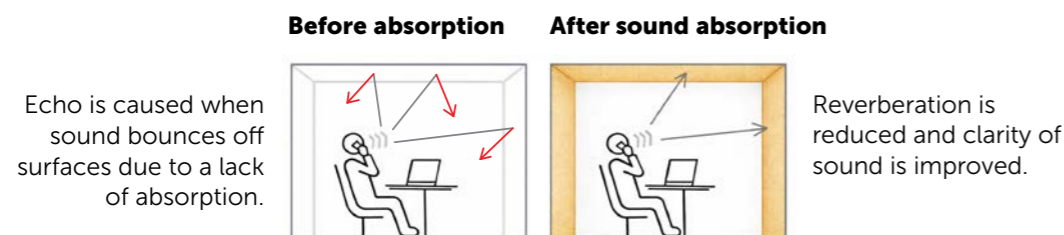

Panels for mounting with screws

- 26 Profile specifications for screw-mounted panels
- 27 Screwing instructions
- 28 Suspended ceilings on CD profile frame
- 30 Suspended ceilings on wooden laths
- 32 Ceilings on CEWOOD clips



Profile specifications for screw-mounted panels

P0 - Panel without chamfer

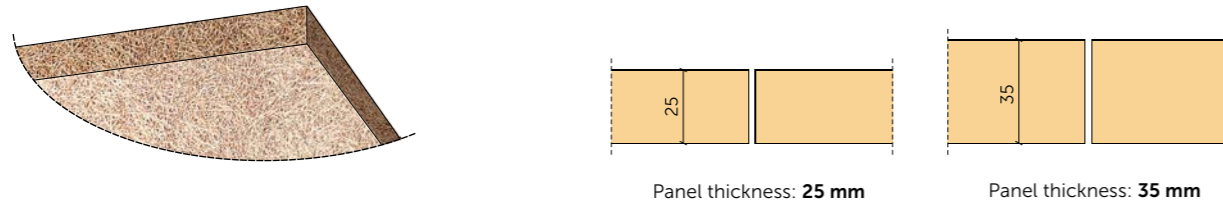

P5 - Panel with 5 mm chamfer

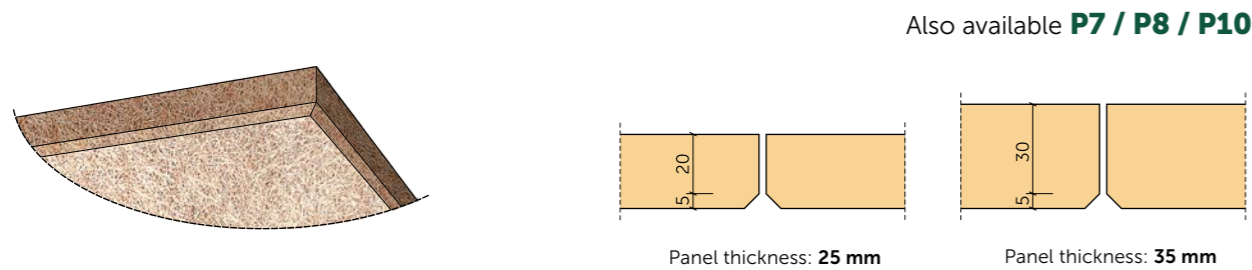

P5H - Hidden suspended ceiling profile with 5 mm chamfer

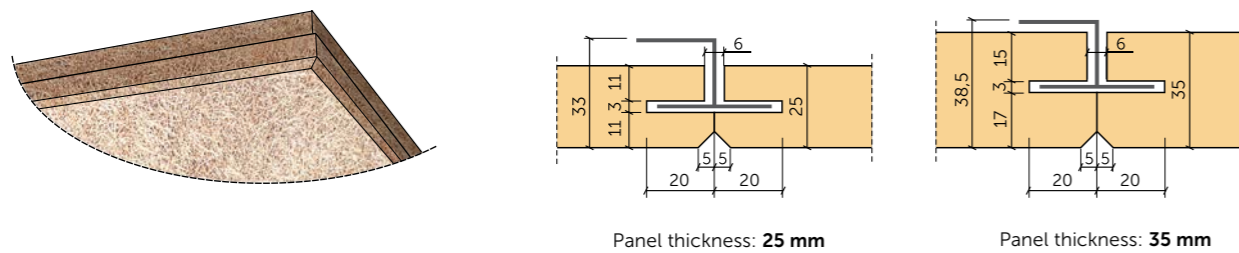

CEWOOD clips

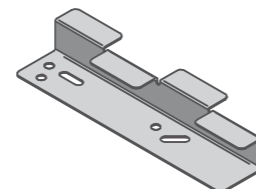

Only this profile is compatible with a clip-based mounting solution.

Screwing instructions

The frame assembly element spacing must be 600 mm, corresponding to the width of the CEWOOD Panels. The distance from the edge of the panel to the screw must not exceed 25 mm. Self-drilling screws for metal constructions or wood screws for wooden constructions are recommended if CEWOOD screws are not used. The screw head should have a head diameter of at least $\varnothing \geq 9$ mm.

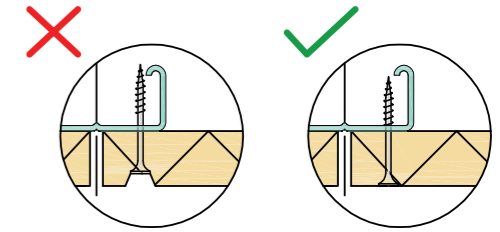

Do not submerge the screws into the CEWOOD Panels – the screw head must remain level with the visible surface of the panel!

Screw location

The connection seam between panels must always be formed under the frame assembly element.

Standard screw pattern for CEWOOD Panels

Fastening of 25 mm and 35 mm thick CEWOOD Panels with screws onto metal CD assembly profiles or wooden assembly laths.

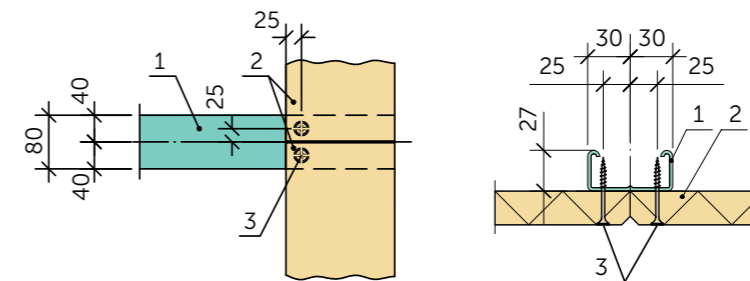
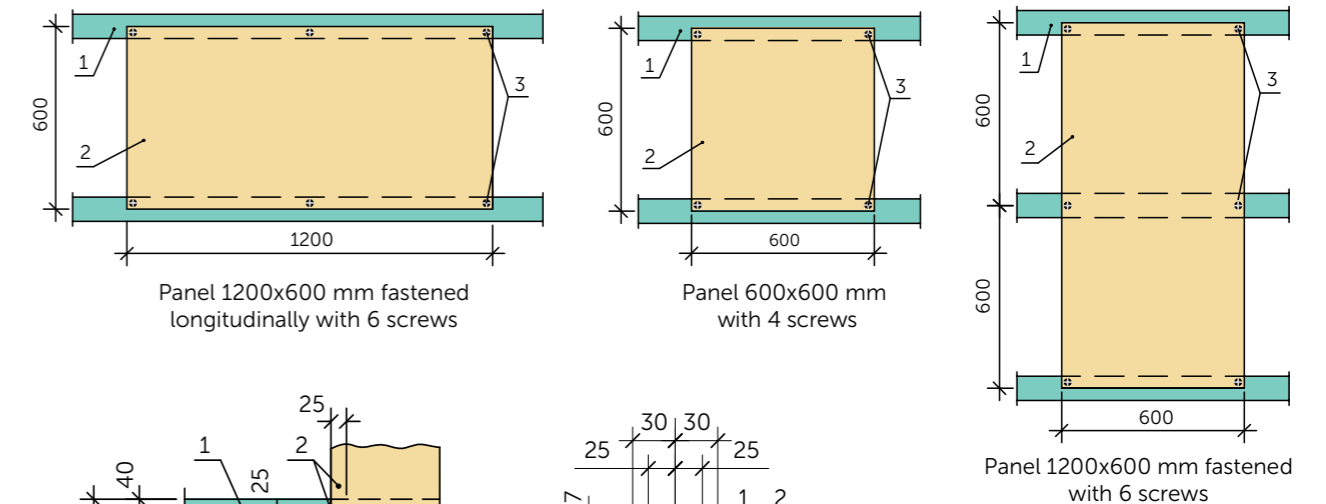

Explanation of numbering

1. Frame assembly element (CD profile or wooden lath)
2. CEWOOD Panels
3. CEWOOD screws 4,65x45 mm or galvanized woodscrews with head $\varnothing \geq 9$ mm

Minimal screw dimensions depending on frame structure and panel thickness

Minimal screw dimensions		
Frame structure/CEWOOD Panel thickness	25 mm	35 mm
CD metal profile frame – self-drilling screws	4.5x45 mm	4.5x50 mm
Wooden lath frame – wood screws	4.5x50 mm	4.5x60 mm

Suspended ceilings on CD profile frame

General instructions

The frame is made of CD-type metal profiles 60/27/0.6 mm arranged perpendicularly. The placement of the CD profiles, their fastening to the load-bearing structure, and the connections between the elements must follow the guidelines provided by the CD profile manufacturer. The placement of suspension elements and the frame load-bearing capacities are shown in the table below.

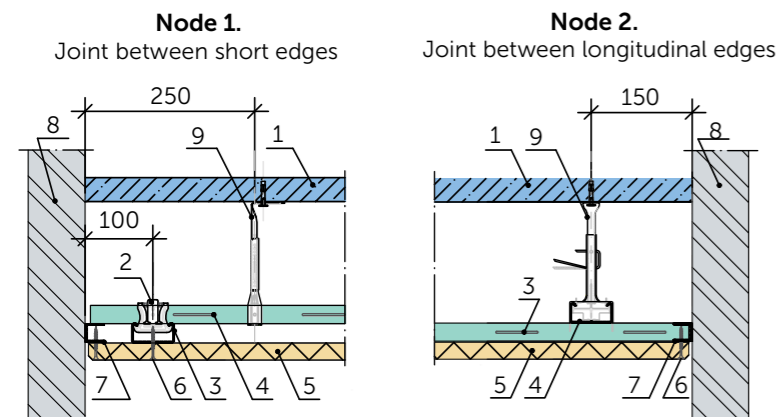
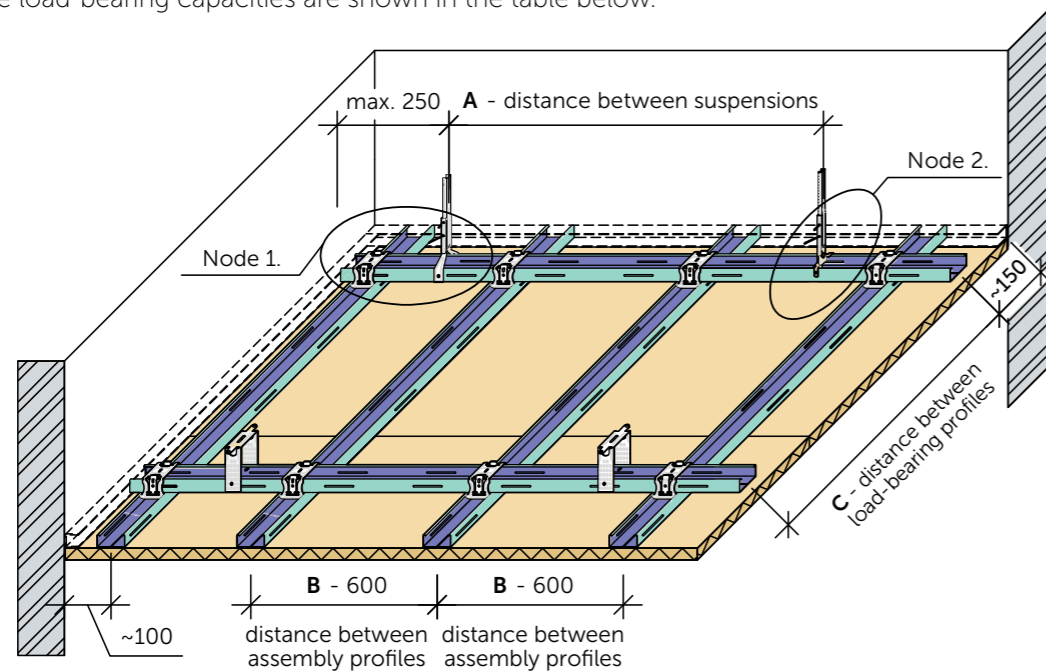

Explanation of numbering

1. Load-bearing structure
2. Cross connector for CD profile
3. CD assembly profile 60/27/0.6 mm
4. CD load-bearing profile 60/27/0.6 mm
5. CEWOOD Panels
6. CEWOOD screws 4.65x45 mm or galvanized woodscrews with head $\varnothing \geq 9$ mm
7. UD perimeter profile 28/27
8. Existing wall structure
9. Nonius suspension
10. U-type clamp

Maximum mounting distances of frame elements

Load-bearing profile CD 60/27/0,6 mm	Assembly profile CD 60/27/0,6 mm	A - distances between suspension elements/fastenings depending on load class	
Distance C - mm	Distance B - mm	Up to 15 kg/m ²	Up to 30 kg/m ²
600	600	1150	900
900	600	1000	800
1000	600	950	700
1200	600	900	

Must use suspensions with load-bearing capacity ≥ 0.40 kg

Fastening types of CD profiles onto the load-bearing structure

Assembly profiles are connected to load-bearing CD profiles using cross connectors. The CD profile frame is fixed to the load-bearing structure with U-type clamps or Nonius suspensions. Detailed explanations are provided below.

Nonius type suspension with adjustable height

Load-bearing capacity 40 kg

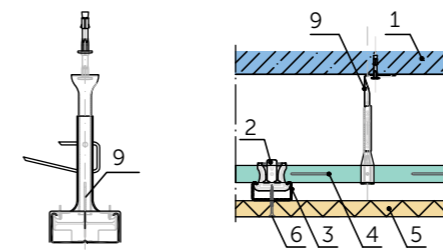

Joint between longitudinal edges

U-type clamp for direct fastening

Load-bearing capacity 40 kg

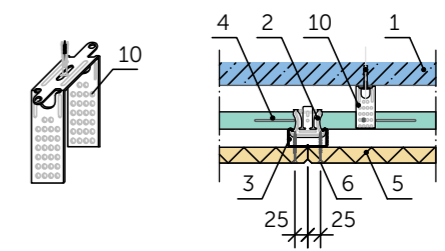

Joint between longitudinal edges

Impact resistance guidelines for metal profile frame

CEWOOD ceiling structures have passed ball-impact tests and can therefore be safely installed in various sports facilities. All tested ceiling types may be used only with the substructure spacing specified in the test results, depending on the ceiling configuration.

Description	Distance A	Distance B	Distance C	Screws	Impact resistance class
According DIN18032-PART3 and EN 13694/ANNEX D					
CEWOOD A2 25 mm panel	900 mm	300 mm	900 mm	9 pcs - 1200x600 panel, 6 pcs - 600x600 panel	1A
CEWOOD 35 mm panel	900 mm	300 mm	900 mm		1A
CEWOOD A2 35 mm panel	900 mm	600 mm	900 mm		1A
CEWOOD 35 mm panel	900 mm	600 mm	600 mm	6 pcs - 1200x600 panel, 4 pcs - 600x600 panel	2A
CEWOOD 25 mm panel	900 mm	600 mm	600 mm		2A

Screw locations and count

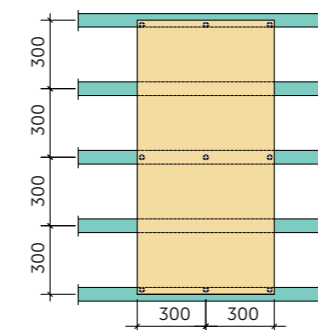

Impact resistance class 1A, 1200 x 600 mm panel fastened with 9 screws

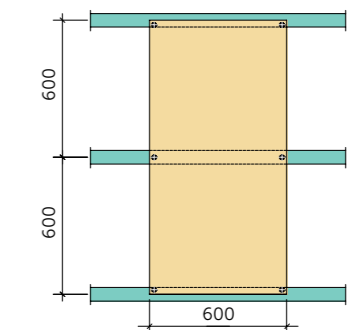

Impact resistance class 2A, 1200 x 600 mm panel fastened with 6 screws



For more information about CEWOOD Panel impact resistance guidelines please scan the provided QR code.

Suspended ceilings on wooden laths

General instructions

The frame is made of perpendicularly arranged wooden laths. Placement of suspension elements and frame-bearing capacities are stated in the table below.

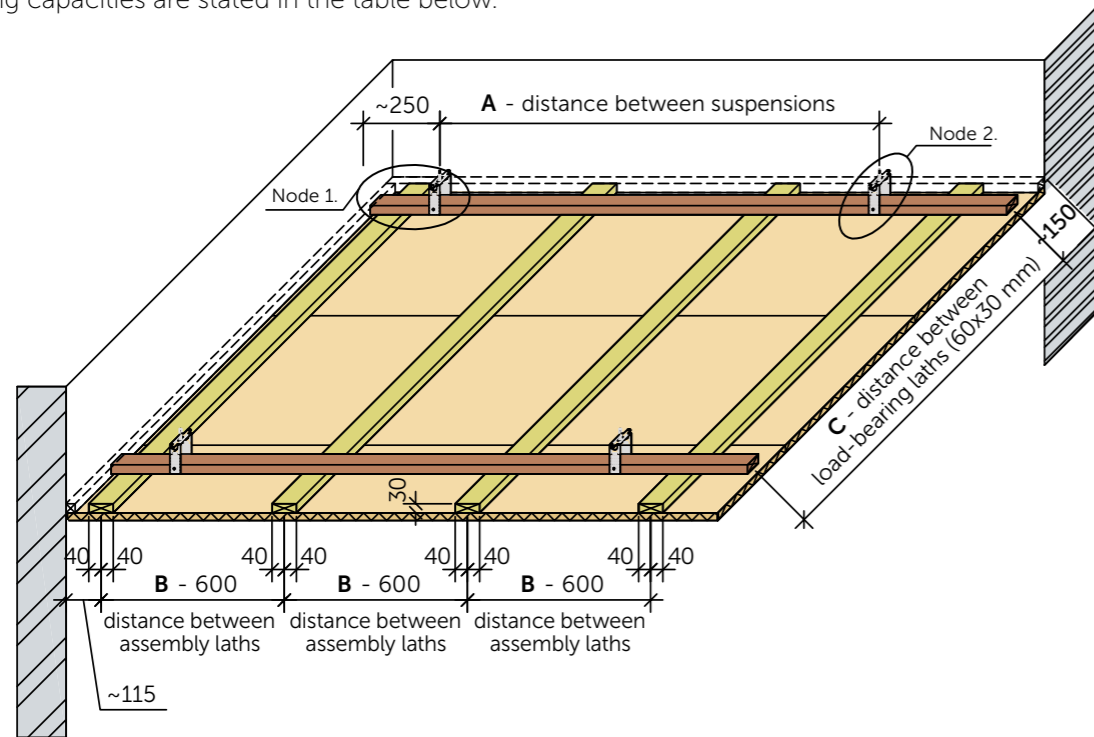

Node 1.
Joint between short edges

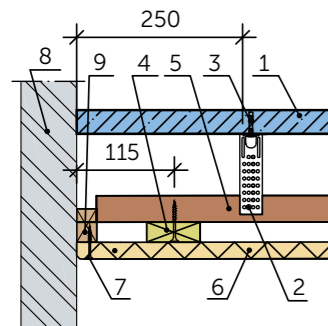

Node 2.
Joint between longitudinal edges

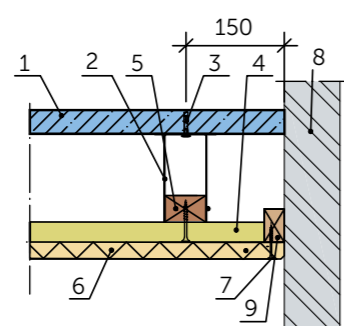

Explanation of numbering

1. Load-bearing structure
2. U-type clamp
3. Conical anchor $\geq M6$
4. Assembly lath min. 80x30(h) mm
5. Load-bearing lath min 60x30(h) mm
6. CEWOOD Panels
7. CEWOOD screws 4.65x45 mm or galvanized woodscrews with head $\varnothing \geq 9$ mm
8. Existing wall structure
9. Perimeter wooden lath 30x50(h) mm
10. Suspension anchor
11. Mineral wool

Maximum mounting distances of frame elements

Load-bearing lath, min. cross section 60/30 mm	Assembly lath, min. cross section 80/30 mm	A – distances between suspension elements/fastenings depending on load class	
Distance C - mm	Distance B - mm	Up to 15 kg/m ²	Up to 30 kg/m ²
600	600	1150	900
900	600	1000	800
1000	600	950	
1200	600	900	

Must use suspensions with load-bearing capacity ≥ 0.40 kg

Fastening types of wooden laths onto a load-bearing structure

Assembly laths are attached to load-bearing laths using wood screws. A wooden lath frame is fastened onto the load-bearing structure using quick suspension, U-type clamp or with anchors directly to load-bearing structure. Detailed explanations are provided below.

U-type clamp for direct fastening

Load-bearing capacity 40 kg

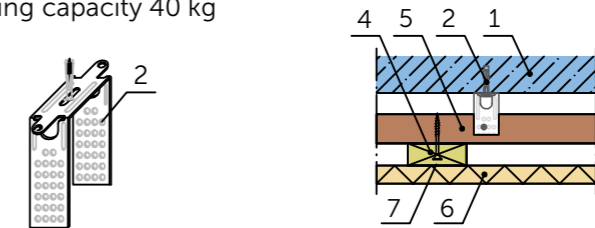

Joint between longitudinal edges

Direct fastening with anchor (single- or double-layer frame)

Anchor fastening can be used for both single-layer and double-layer frame systems. The anchor must always be fixed directly into a load-bearing structure.

Single-layer fastening is suitable where no ceiling leveling is required.

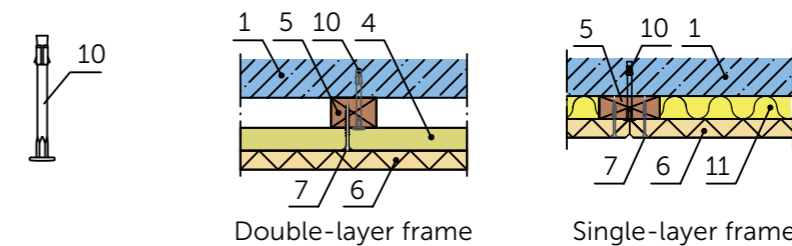

Impact resistance guidelines for wooden frame

These solutions are intended for wooden frame constructions. All tested ceiling types may be used only with the substructure spacing specified in the ball-impact test results, depending on the ceiling configuration.

Description	Distance A	Distance B	Distance C	Screws	Impact resistance class
According DIN18032-PART3					
CEWOOD 35 mm panel	900 mm	300 mm	600 mm	15 pcs - 1200x600 panel, 9 pcs - 600x600 panel	1A

Screw locations and count

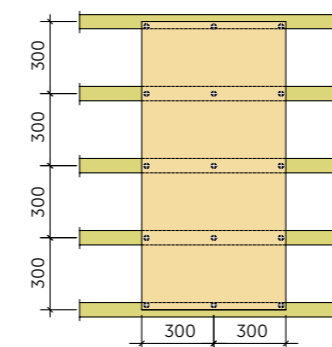

1200 x 600 mm panels fasten with 15 screws

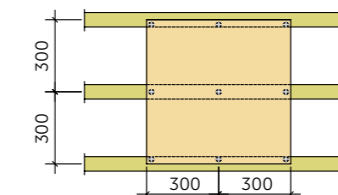

600 x 600 mm panels fasten with 9 screws

CEWOOD Panel impact resistance guidelines:



Ceilings on CEWOOD clips

CEWOOD clip assembly guidelines on metal CD profile and lath frame

Each CEWOOD Panel 25 mm or 35 mm with dimensions 1200 x 600 mm is supported with 6 clips, and 600x600 mm panels are supported with 4 clips. Long edges use profile P5H, short edges use profile P5. The substructure follows the same principles as standard CD or wooden frame ceilings, and the clip layout must be adapted to the chosen frame construction.

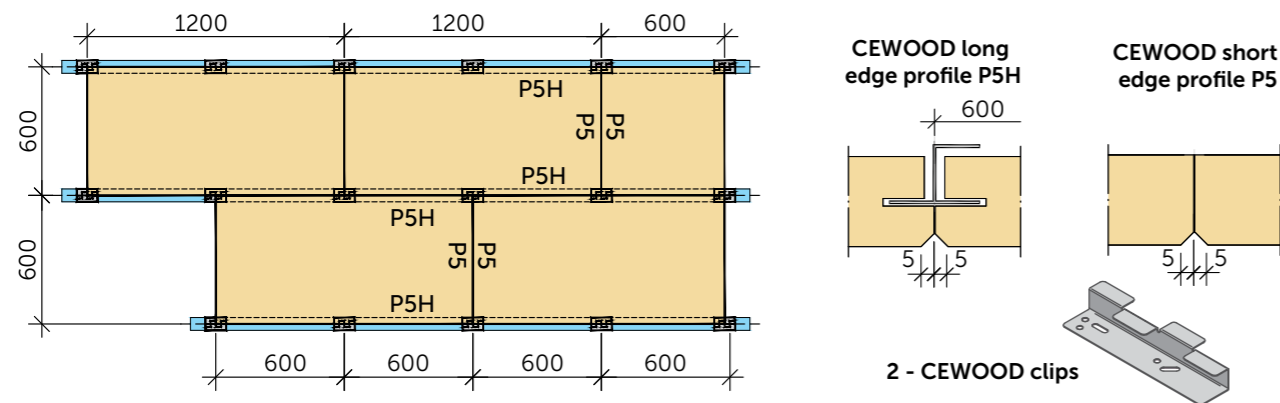

CEWOOD clip fastening on different substructure

CEWOOD clip fastening on CD profile

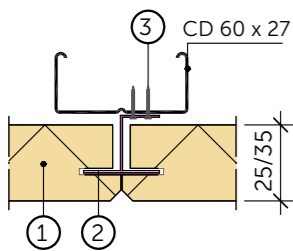

CEWOOD clip fastening on wooden lath

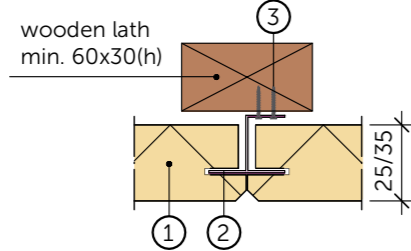

Explanation of numbering

1. CEWOOD Panels
2. CEWOOD clip
3. Fastening screw 4,0x25 mm
4. Conical anchor \geq M6
5. Wall L profile L35/35 mm
- E - Spring type support

Ceiling perimeter fastening when ceilings fastened with CEWOOD clips

Fastening on perimeter metal profile

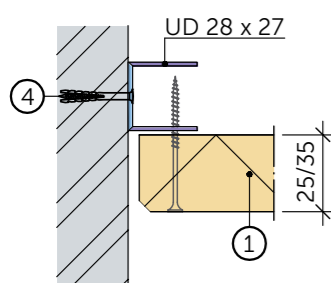

Fastening on perimeter wooden lath

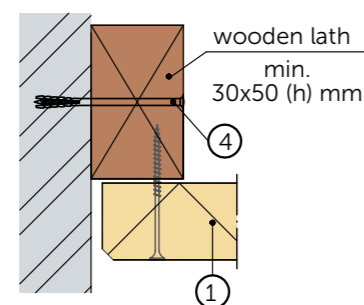

Supporting perimeter with wall L profile L35x35 mm

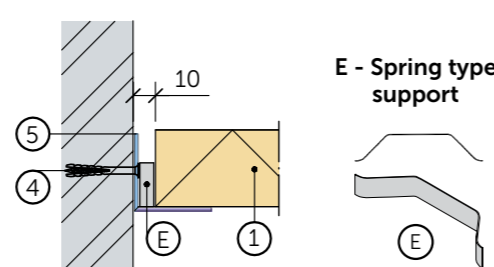

E - Spring type support

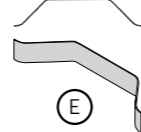

Panels for suspension in T-type profile frame ceilings



- 34 Profile specifications for suspended ceilings panels
- 36 Visible T-type profile frame assembly
- 38 Hidden T-type profile frame assembly
- 40 Hallway solution

Profile specifications for suspended ceilings panels

P0-T24 - Standard T24 ceiling profile

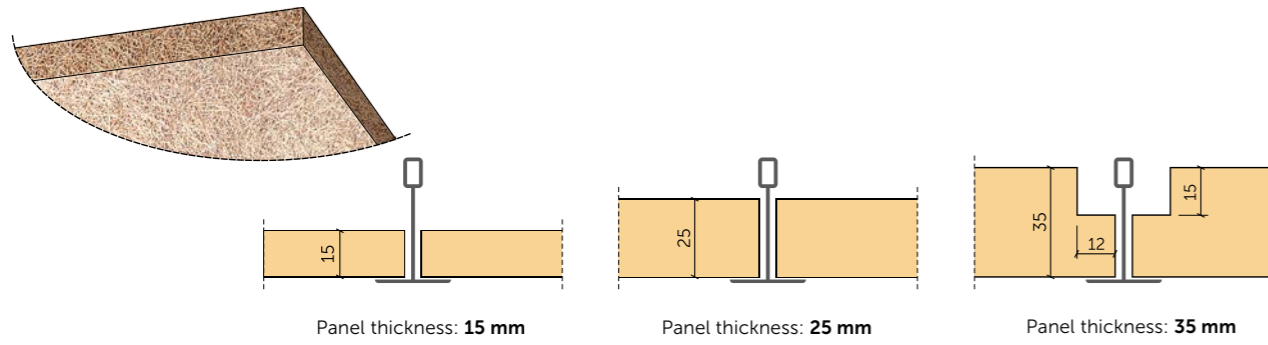

P0G-T24 - Immersed T24 ceiling profile

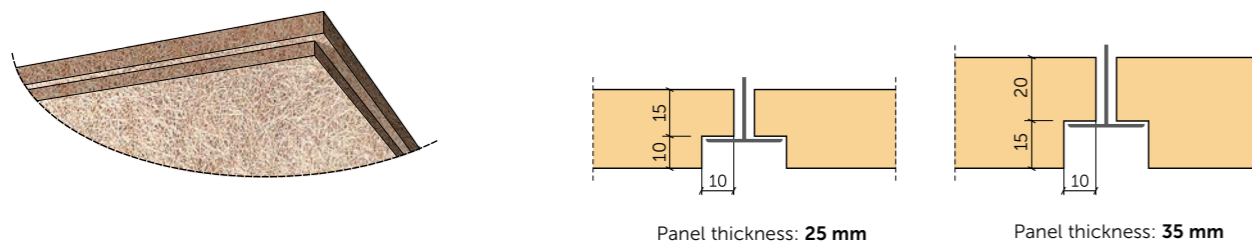

P5G-T24 - Immersed T24 ceiling profile with 5 mm chamfer

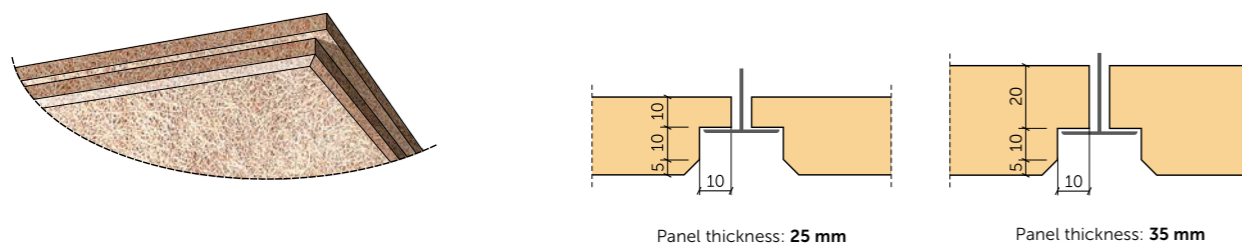

P5S-T35 - T35 hidden profile with overhang, 5 mm chamfer

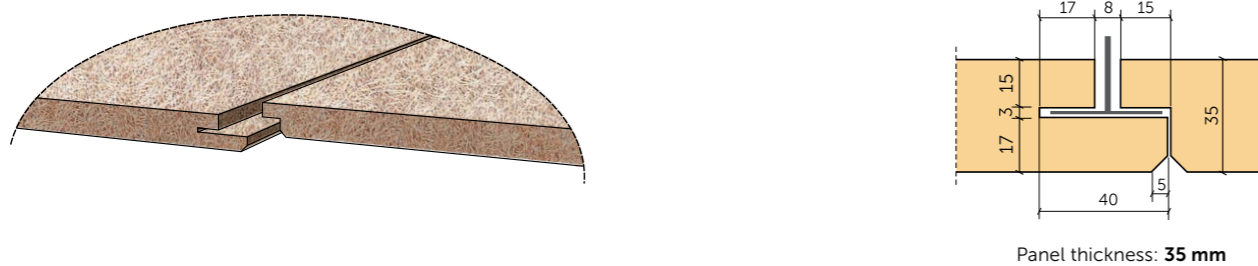

CEWOOD suspended ceilings panels



Visible T-type profile frame assembly

General instructions

The procedure and methods of assembling the ceiling frame are determined by the manufacturer of structures. This informative material shows some examples of mounting solutions to create safe structures for CEWOOD Panel suspension. The T-type profile step is defined depending on the structural load provided the permissible flexure of 1/500 length. The step between the load-bearing profiles for CEWOOD Panel ceilings – 1200 or 600 mm, distance between mounting profiles – 600 mm. Permissible distances for suspension elements are provided in the table below.

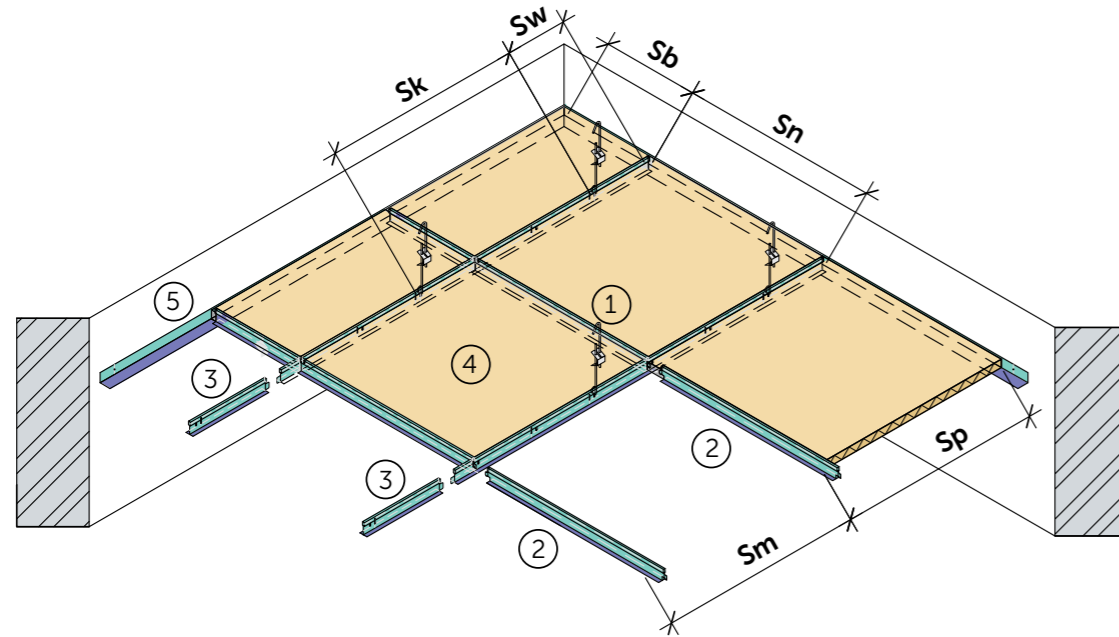

CEWOOD compatible profiles for visible T-type ceilings

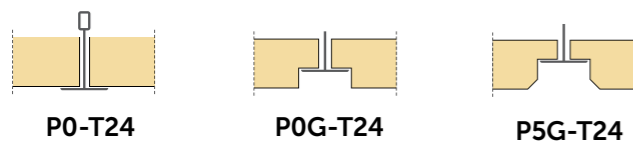

Explanation of numbering

1. Suspensions
2. Cross profile
3. Load bearing profile
4. CEWOOD Panels
5. Perimeter profile

Maximum mounting distances of frame elements

Frame load capacity	15 kg/m ²		25 kg/m ²	
	Step between load-bearing profiles Sn , mm	600	600	600
Step between suspensions Sk , mm	≤1100	≤1100	≤1000	≤1000
Distance from suspension to wall Sw , mm	≤250	≤250	≤200	≤200
Step between cross profiles Sm , mm	1200	600	1200	600

The dimensions of **Sb** and **Sp** shall be determined depending on the room size. Max. distance from wall must not exceed 600 mm. With higher loads, the step between suspensions must be accordingly reduced.

T-type profile frame elements and placement options

Profile placement for 595x595 mm panel assembly

a) Distance between load-bearing profiles

Sn = 600 mm

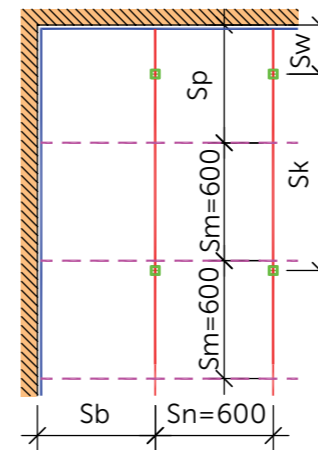

Profile placement for 1195x595 mm panel assembly

a) Distance between load-bearing profiles

Sn = 600 mm

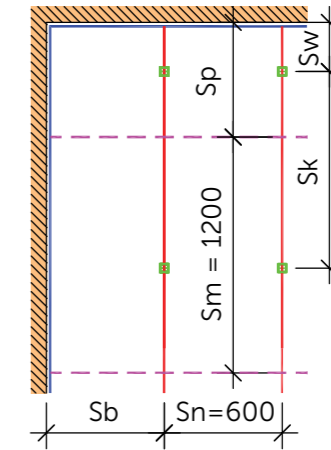

Explanation of marking:

- Suspensions
- Cross profile
- Load-bearing profile
- Perimeter profile

T-type profile element connection and explanation

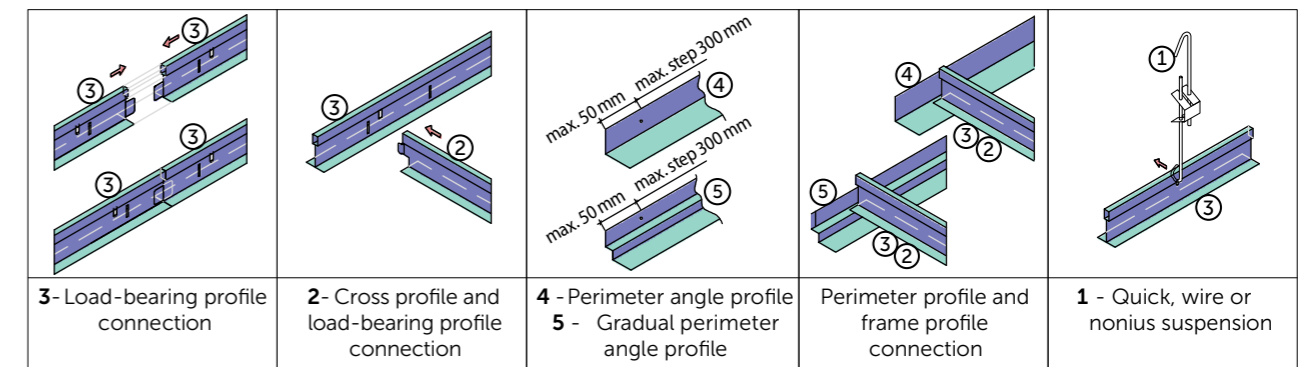

Fastening of T-type profiles onto a load-bearing structure

Quick suspension with adjustable height

Load-bearing capacity 15 kg

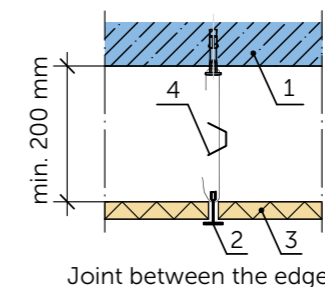

Explanation of numbering

1. Load-bearing slab or foundation structure
2. Load-bearing profile
3. CEWOOD Panels
4. Adjustable ceiling hanger

Hidden T-type profile frame assembly

General instructions

CEWOOD Panels on a hidden T-type profile create a continuous ceiling surface without visible fasteners. For this system, P5S edge panels must be used. Panels rest on T35 mm T-profiles or equivalent profiles with adequate load-bearing capacity. The ceiling is easy to open by lifting the designated panel edge; for larger access openings, the corresponding distance profiles B must be removed.

! Panel size available 1200x600 mm or 600x600 mm. Minimal panel thickness 35 mm.

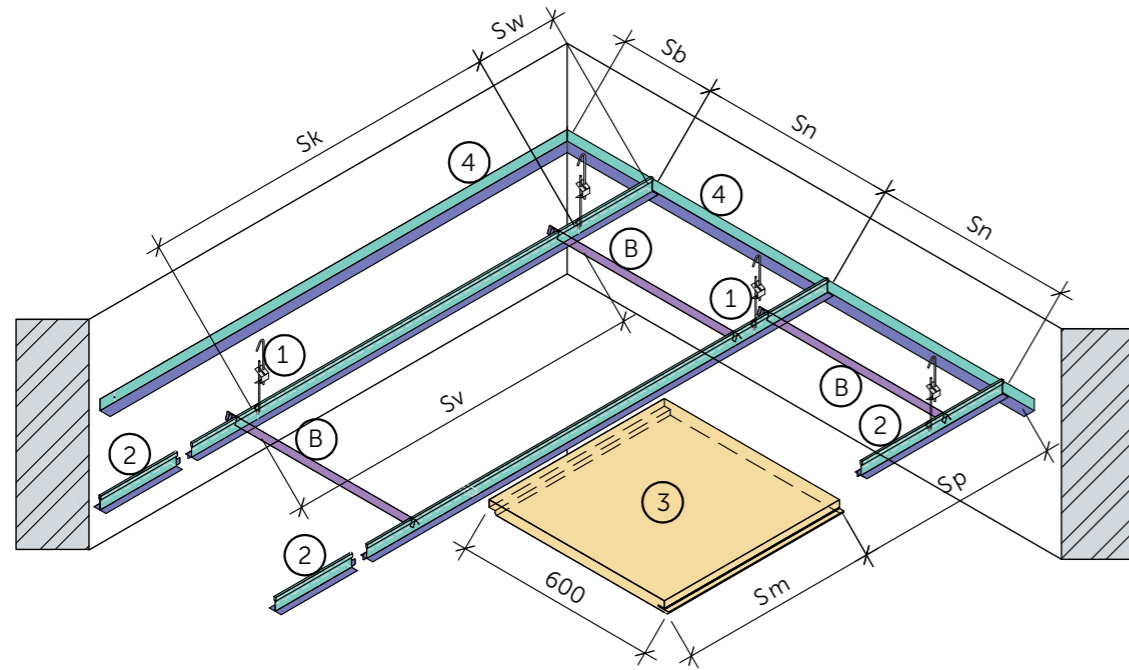

CEWOOD compatible profiles for hidden T-type ceilings

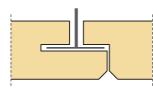

P5S-T35

Explanation of numbering

1. Suspensions
2. Load bearing profile T35
3. CEWOOD Panels
4. Perimeter profile
- B. Distance profile

Maximum mounting distances of frame elements

Frame load capacity	20 kg/m ²	30 kg/m ²
Step between load-bearing profiles Sn , mm	600	600
Step between suspensions Sk , mm	≤1000	≤800
Distance from suspension to wall Sw , mm	≤200	≤200
Step between cross profiles Sm , mm	1200	1200
The dimensions of Sb and Sp are determined depending on the room size. Max. distance from wall must not exceed 600 mm. With higher loads, the step between suspensions must be accordingly reduced.		

Hidden T-type profile frame elements and placement options

Profile placement for 600x600 mm panels

a) Distance between load-bearing profiles

Sn = 600 mm

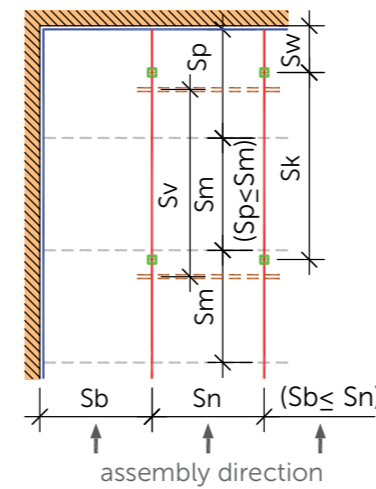

Profile placement for 1200x600 mm panels

a) Distance between load-bearing profiles

Sn = 600 mm

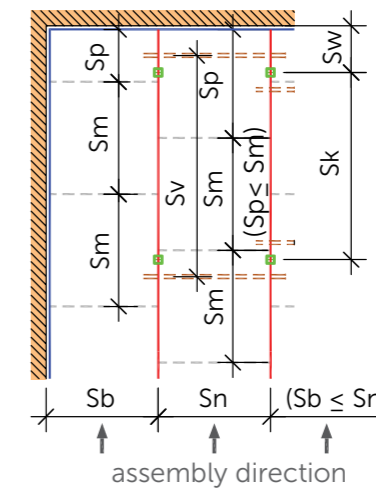

Explanation of marking:

- Suspensions
- Cross profile
- Load-bearing profile T35
- Perimeter profile
- Distance profile

T-type profile element connection and explanation

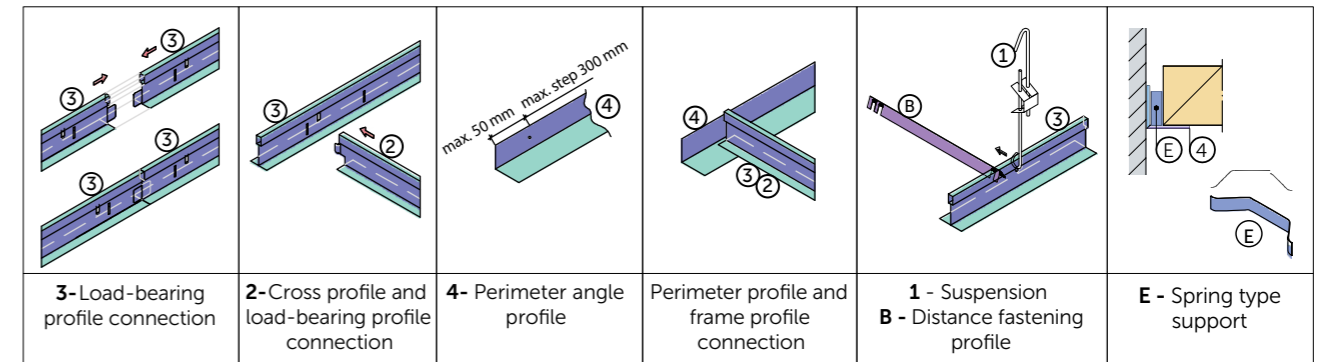

Fastening of T-type profiles onto a load-bearing structure

Quick suspension with adjustable height

Load-bearing capacity 15 kg

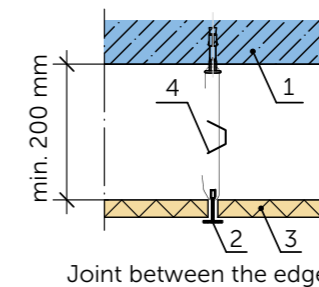

Explanation of numbering

1. Load-bearing slab or foundation structure
2. Load-bearing profile
3. CEWOOD Panels
4. Adjustable ceiling hanger

Hallway solution

Benefits



This system features a support profile and perimeter angle, ensuring an easy installation and a sleek, finished look. As a free-span system, it includes all necessary components, eliminating the need for extra hangers. The concealed installation creates a clean, grid-free ceiling that is both functional and aesthetically pleasing. Panels are fully customizable in both length and color, allowing them to seamlessly complement the hallway design. Additionally, the system offers easy access for maintenance or future adjustments.

Technical specifications

Wood wool width	1.0 mm, 1.5 mm, other wood wool upon request
Panel thickness	25 mm
Panel size	2400x600 mm; 1200x600 mm; 600x600 mm. Custom sizes - upon request
Weight	10.5 kg/m ² (14.5 kg/m ² - A2-s1, d0)
Thermal conductivity	$\lambda = 0.069 \text{ W/m-K}$
Fire reaction class	B-s1, d0; A2-s1, d0
Colour tone	natural painted, white, black, grey and any shade in RAL or NCS system upon request

Ceiling system hardware specification

Required profile type	T35 support profile
Minimum profile height	70 mm
Perimeter angle	Minimum size 40x20 mm, made from 1.5 mm thick metal
Screws for perimeter angle	3.5x30 mm for wood walls; 3.5x40 mm + dowels for concrete walls

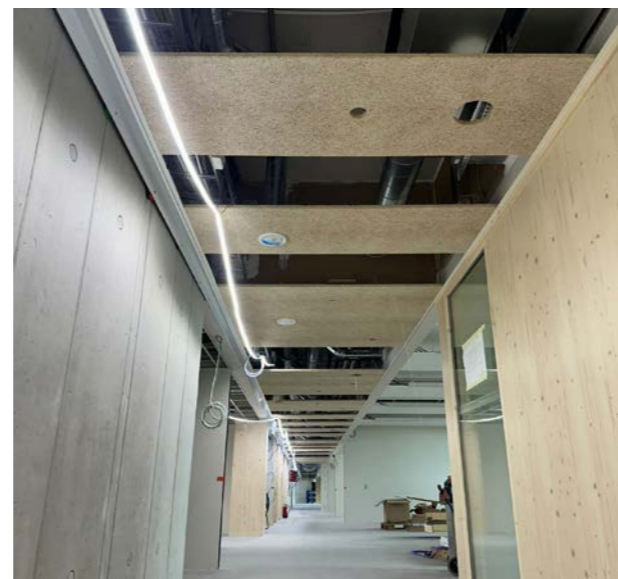
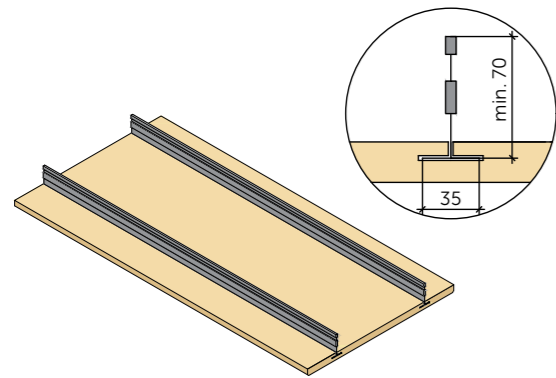

For more information about CEWOOD System For Hallway please scan the provided QR code.



Integrated opening solutions and panel accessories

- 42 Installation of lights, speakers and similar devices into CEWOOD Panels
- 43 CEWOOD Ceiling layout guidelines
- 44 CEWOOD Inspection hatches
- 45 CEWOOD Panel screw

Installation of lights, speakers and similar devices into CEWOOD Panels

The placement and type of ceiling lights, speakers and similar devices in CEWOOD Panels are determined by the construction project. Devices which are intended for installation in the suspended ceiling must be used. The device must be assembled according to the device manufacturer's assembly instructions. The assembly instructions must indicate the device's dimensions, weight and dimensions of the required mounting openings and they must not exceed the limits stated below.

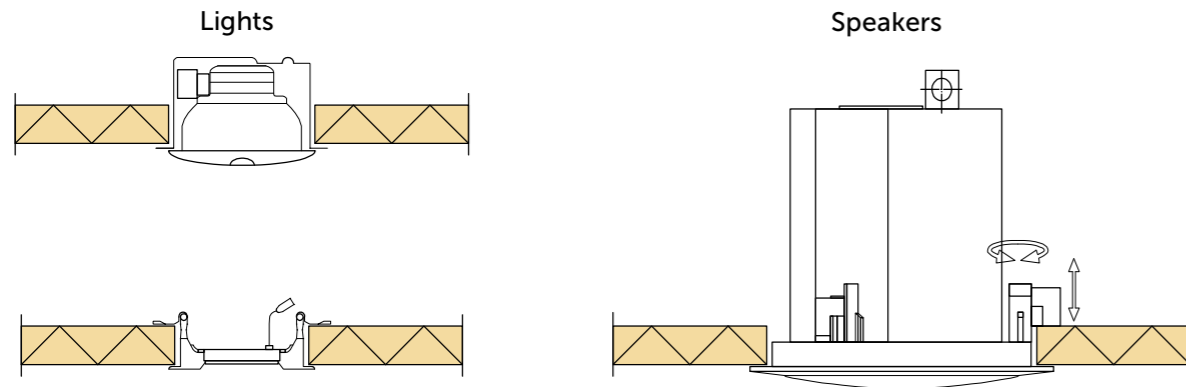

⚠ Ceiling frames are designed for a total calculated load of up to 0.1 kN (~10kg) per frame element running meter.

Permissible openings made into CEWOOD Panels and load-bearing capacity of fasteners

CEWOOD Panel thickness, mm	Permissible weight of the built-in device, kg	Permissible dimensions of an opening		Fastener load-bearing capacity, kg	
		Diameter, mm	Edge length, mm	Self-drilling dowel with wood screw Ø 4.5 mm	Wood screw Ø 4.5 mm
15	1.2	150	120	~ 1.0	~ 1.0
25	3.5	200	175	~ 3.0	~ 2.0
35	6	300	275	~ 4.0	~ 2.5

Heavier devices can be attached directly to the load-bearing structure or an additional support structure can be created. An opening for inserting the device can be cut with a jigsaw or circular hole saw. The edges of an opening must be smoothed and painted. Holes or cut-outs should be placed in the center of the panel.

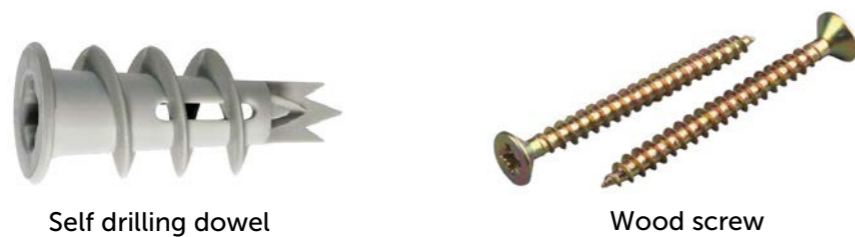

Self drilling dowel

Wood screw

CEWOOD Ceiling layout guidelines

Panel placement patterns

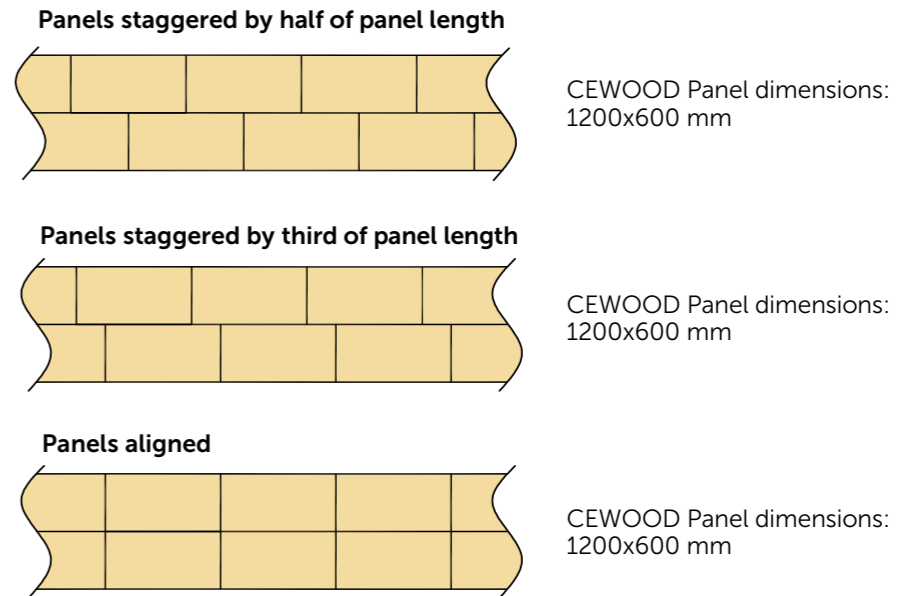

Installation reference plane

Option 1 is recommended, as the starting ceiling panel is positioned in the center of the ceiling. This approach ensures even and symmetrical cut panels along the ceiling perimeter, creating a visually balanced ceiling layout.

Layout options 2 and 3 are also acceptable but may result in uneven perimeter panel widths, which can be visually noticeable, particularly in larger or visually exposed ceiling areas.

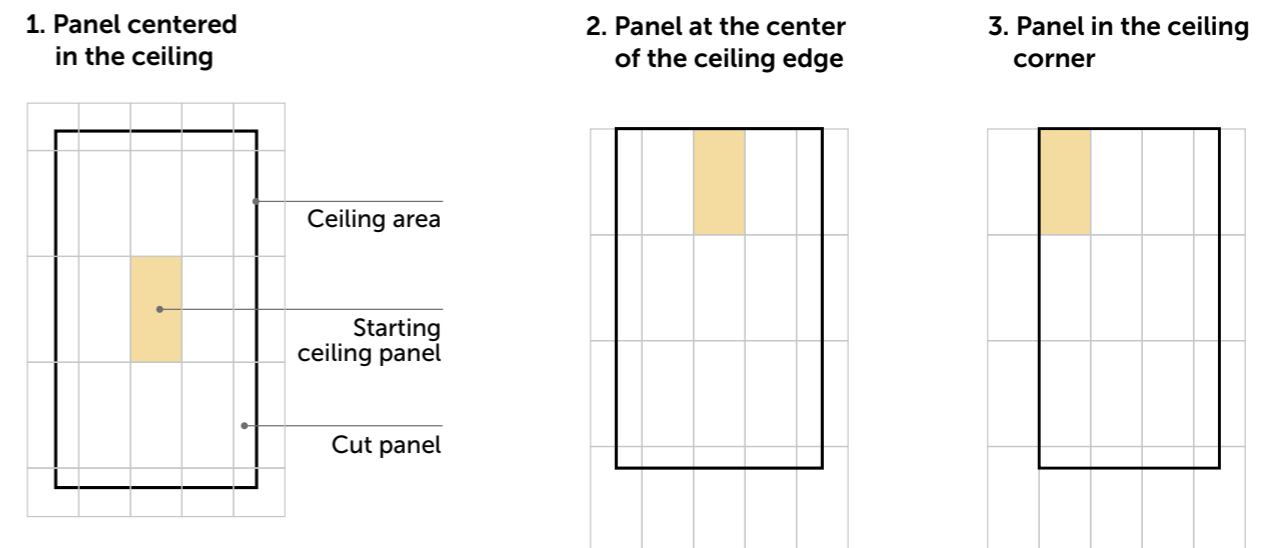

CEWOOD Inspection hatches

CEWOOD manufactured inspection hatches are available at various sizes. They are built in elements into the ceiling panels without any additional frame. Hatches are designed for access to any kind of communications, that are located behind the ceilings. Panels with inspection hatches are mounted with the same guidelines as the standard acoustic ceiling panels. Hatch door is fully removable and reinsertable at any moment necessary. Visually, the hatches merge with the ceilings and form a smooth ceiling surface.



Technical properties

Wood wool width	1.0 mm; other wood wool upon request
Panel thickness	25 mm; 35 mm
Size (standard panels)	1200x600 mm; 600x600 mm
Size (for suspended ceiling)	595x595 mm; 1195x595 mm
Colours	natural painted, white, black, grey and any shade in RAL or NCS system upon request
Profiles	P0; P5; other edge profiles upon request
Fire reaction class	B-s1, d0

Maximum opening dimensions for hatches in CEWOOD Panels

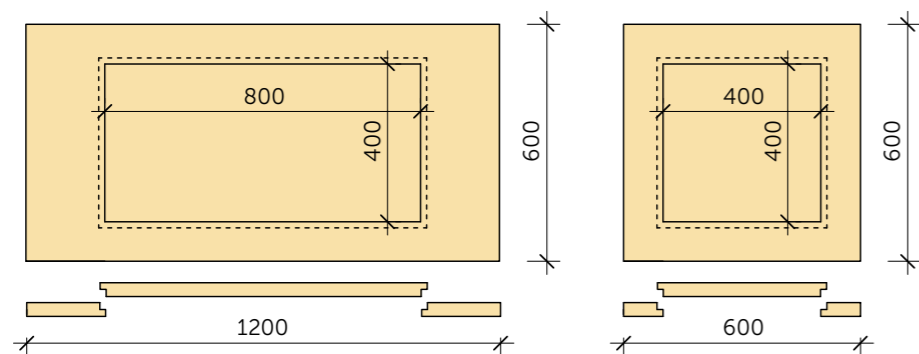

! Inspection hatches can be integrated into both CEWOOD Panels and Barcode panels and fixed with screws to a metal or wooden substructure, or into a T-profile grid. Panels with inspection hatches must be installed in accordance with the CEWOOD Panel installation requirements.



For more information about Installation of CEWOOD Inspection Hatches scan the provided QR code.

CEWOOD Panel screw

Product data

Technical data	
Head:	Ø13.8 mm flat head with TX20 recess
Diameter:	Ø4.65 mm
Shaft:	12 mm
Drill point:	#1S
Drill capacity:	0.5 - 1.5 mm (Steel S280GD)
Material:	Hardened steel
Surface treatment:	ZYTEC™ GX
Corrosivity category:	C3 (high) according to EN ISO 12944-2

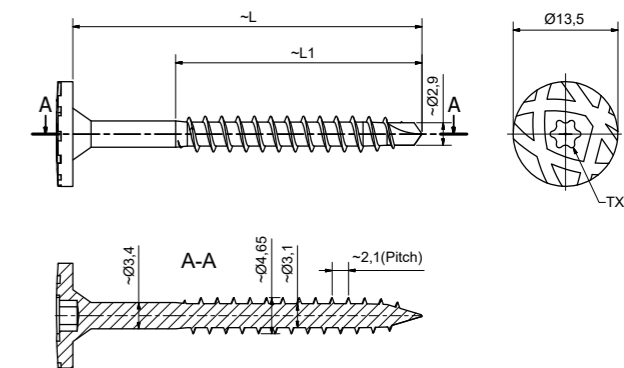

Product range

Art.no.	Item name	Thread [mm]	Length L [mm]	Shaft [mm]	Drill point	Drill cap. [mm]	Head [mm]	Unit
17770	TRABO FH 4.65 X 45 #1S TX20	Ø4.65	45/64	12	#1S	0.5 - 1.5	Ø13.5 TX20	250

Advantages

- Suitable for fastening of CEWOOD Panels to steel or wood
- Large head for better load distribution
- Specially designed pattern on the head for better concealing
- Surface treated with ZYTEC™ GX for optimal corrosion protection
- Available in more than 500 colours (Qualicoat certified facade quality powder)



Inspiring Solutions with CEWOOD Panels



Volksschule 44 and Hort Pichling, Austria



Optical Store, Lithuania



Campus Kristiansund, Norway



5* Falkensteiner Hotel Montafon, Austria

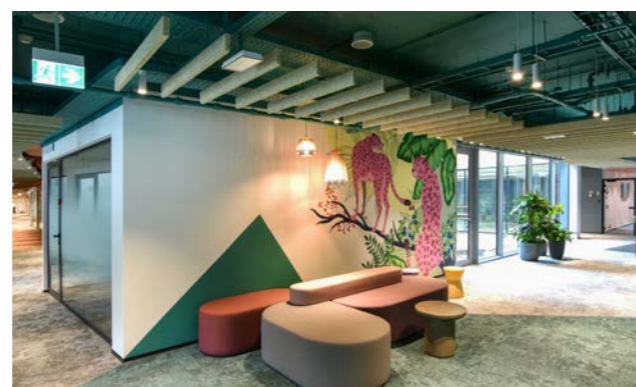

Workland Galleria Riga, Latvia



Office Building, Latvia

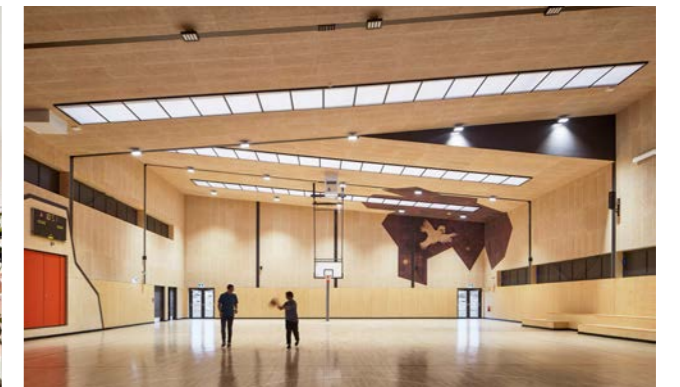

VSBA School Bundle (ARM TARNIET), Australia

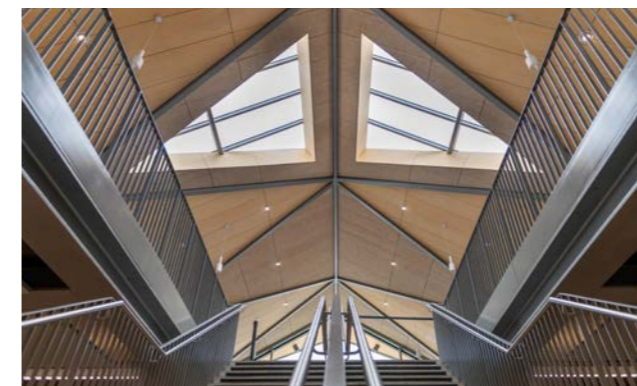

Black Country Living Museum, United Kingdom



Zunda Towers, office HRMNY, Latvia



Šilainiai Swimming Pool, Lithuania



Lufthansa InTouch, Brno, Czechia

“ The design reimagines the call centre’s shared spaces as a **welcoming oasis**. Through the use of natural colours and soft materials, it creates a deliberate contrast to the highly technical environment of the open-plan offices.

The space is conceived as a dedicated **relaxation zone**, enriched with greenery that enables employees to unwind, recharge, and momentarily step away from their work.

Natural textures, a variety of ergonomic seating options, and discreet **acoustic panels** are thoughtfully integrated into the interior. Together, these elements **reduce ambient noise** and **support employees’ well-being** and mental equilibrium throughout the working day.



” **TJ ARCHITEKTI**
Ing. arch. Zuzana Juráková
Lufthansa InTouch, Brno



MATERIAL FOR COMFORT AND HEALTH

www.cewood.com

CEWOOD Factory
Galdusalas-1, Jaunlaicene, Aluksne, LV-4336, Latvia

CEWOOD Office/warehouse
Daugavgrivas soseja 1, Riga, LV-1007, Latvia

E-mail: info@cewood.com