

## CEWOOD FLEECE

CEWOOD Fleece is a two-layer sound-absorbing panel that combines a CEWOOD panel with an ultra-thin layer of non-woven acoustic fleece on the back. This innovative design improves sound absorption capabilities without altering the panel's thickness, enabling it to achieve top sound absorption performance. CEWOOD Fleece panels in addition to improved acoustic performance also increases efficiency of handling, storage and installation.



### Technical properties

Wood wool width	1.0 mm; other wood wool upon request
Panel thickness	15 mm; 25 mm; 35 mm
Size (standard panels)	1200x600 mm; 600x600 mm; other sizes upon request
Size (for suspended ceiling)	595x595 mm; 1195x595 mm
Colours	natural painted, white, black, grey and any shade in RAL or NCS system upon request
Profiles	P0; P5; other edge profiles upon request
Fire reaction class	B-s1, d0; A2-s1, d0

#### Acoustic fleece

Thickness	0.4 mm
Weight	115 g/m <sup>2</sup>
Fire reaction class	A2-s1, d0

### Acoustic properties

CEWOOD Fleece panels provide the highest sound absorption class by simply adding a layer of non-woven fleece behind the panels, without altering their thickness. These panels can be installed with screws or incorporated into suspended ceiling systems. The dual-layer design effectively reduces sound reverberation, enhances acoustic comfort, and improves speech clarity in both private and public spaces, including apartments, homes, schools, offices, and conference rooms. Additionally, employees working in technical environments will experience significant benefits from reduced noise levels caused by production machinery.

### Sound absorption coefficient, $\alpha_w$

	Air gap, A		Total construction height, H
	50 mm	100 mm	200 mm
CEWOOD Fleece, 15 mm	0.55	0.80	0.80
CEWOOD Fleece A2, 15 mm	0.60	0.80	0.80
CEWOOD Fleece, 25 mm	0.70	0.90	0.90
CEWOOD Fleece A2, 25 mm	0.65	0.85	0.90
CEWOOD Fleece, 35 mm	0.75	0.95	0.95
CEWOOD Fleece A2, 35 mm	0.70	0.95	0.95

A2 – reaction to fire class according to EN 13501-1.

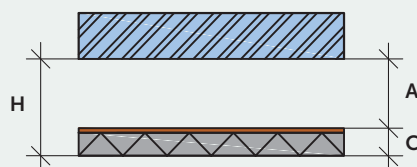

A – air gap  
 H – total construction height  
 C – CEWOOD Fleece panel