



AruAL patio PARALLEL 88 INOWA EX Outside opening sliding alu-clad window/door

- Made to measure sizes
- Innovative closing movement perpendicular to the frame profile
- Uniform closing movement with positive control through locking points controlled on all 4 sides
- Continuous gasket all around
- Locking points in the mullion as well
- All locking points controlled by the handle



To open the door, the handle must be turned up and then the door can be pushed aside.

To close the door, the handle must be turned down.

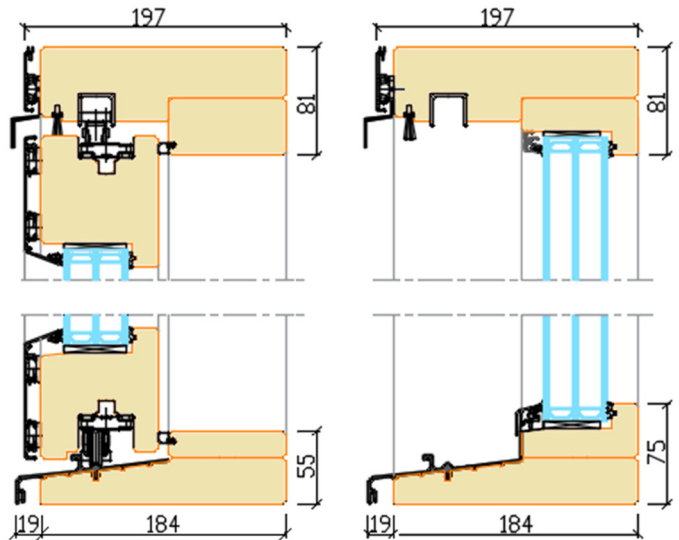

Sliding part

Fixed part

- Jamb width 197 mm
- Frame and sash material - pine or oak
- Timber finishing with waterbased paint or stain. Paint according to RAL color chart, stain according to manufacturer's samples
- Powder coated aluminium cover
- Triple glazed
- Glazing bar options:
 1. Glued on both sides of the glass+slats inside the glazing (Norwegian style)
 2. Glued on both sides of the glass (Georgian style)
 3. Decorative bars inside the glazing

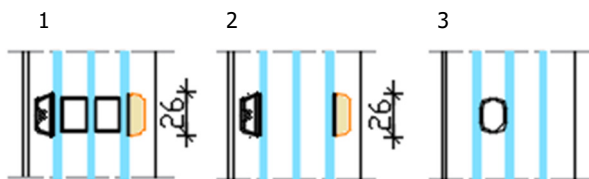
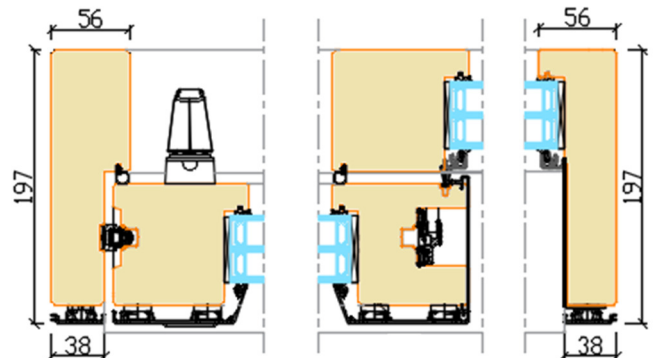

Sash width 756 ... 3000 mm
 Sash height 646 ... 2545 mm
 Sash weight max 400 kg
 Sash height/width ratio max 2:1
 Jamb width 1500 ... 6400 mm
 Jamb height 750 ... 2650 mm

- Standard locking system: handle inside and finger pull outside
- Extras:
 - different handle styles
 - 2-sided key lock (Euro DIN)
 - Soft close
 - special glasses (toughened, laminated, sun protection, self cleaning etc)

OPENING SCHEMES viewed from outside

Schema A

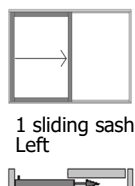

1 sliding sash Left

Schema K

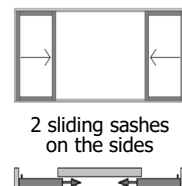

2 sliding sashes on the sides

Schema C

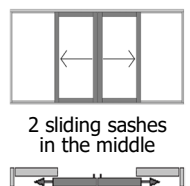

2 sliding sashes in the middle



The non-opening part of the sliding door is divided into multiple fields by a vertical post

- Product U-value 0,80W/m²K (2500x2100mm; Ug-0,53)