



“Aru ED 50 PROF EX” is an outward opening insulated external door with a 50 mm timber sash and a profile blanking. The design is suitable for use in renovated buildings, country houses and cottages. Using this method the customer can achieve a bespoke design.

Painted or stained external doors with profile blanking.



An external double door.



The top of the profile blanking is covered with a timber



A stained external door made of selected



A stained external door made of knotted pine

Aru ED 50 PROF EX

Aru ED 50 PROF EX

CE
ISO 9001:2008

OUTWARD OPENING PROFILE BLANKING EXTERNAL DOOR

- Doorleaf thickness 50 mm
- Finishing with water-based paint or stain
- Frame 92x42 mm
- Threshold 42 mm oak
- Glazing double or triple glazing panel 23 mm
- Gasket in the frame
- Hinges 2D adjustable, 3 pcs
- Panelling profiled blanking on both sides (fixed with screws)
- Lock according to the customer's wishes (Assa, Abloy, KFV, etc.)

Outside dimensions according to the customer's wishes

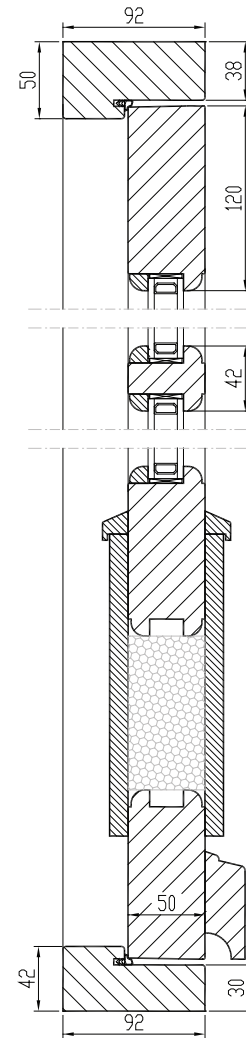
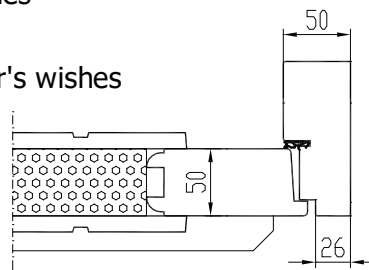

MODELS:

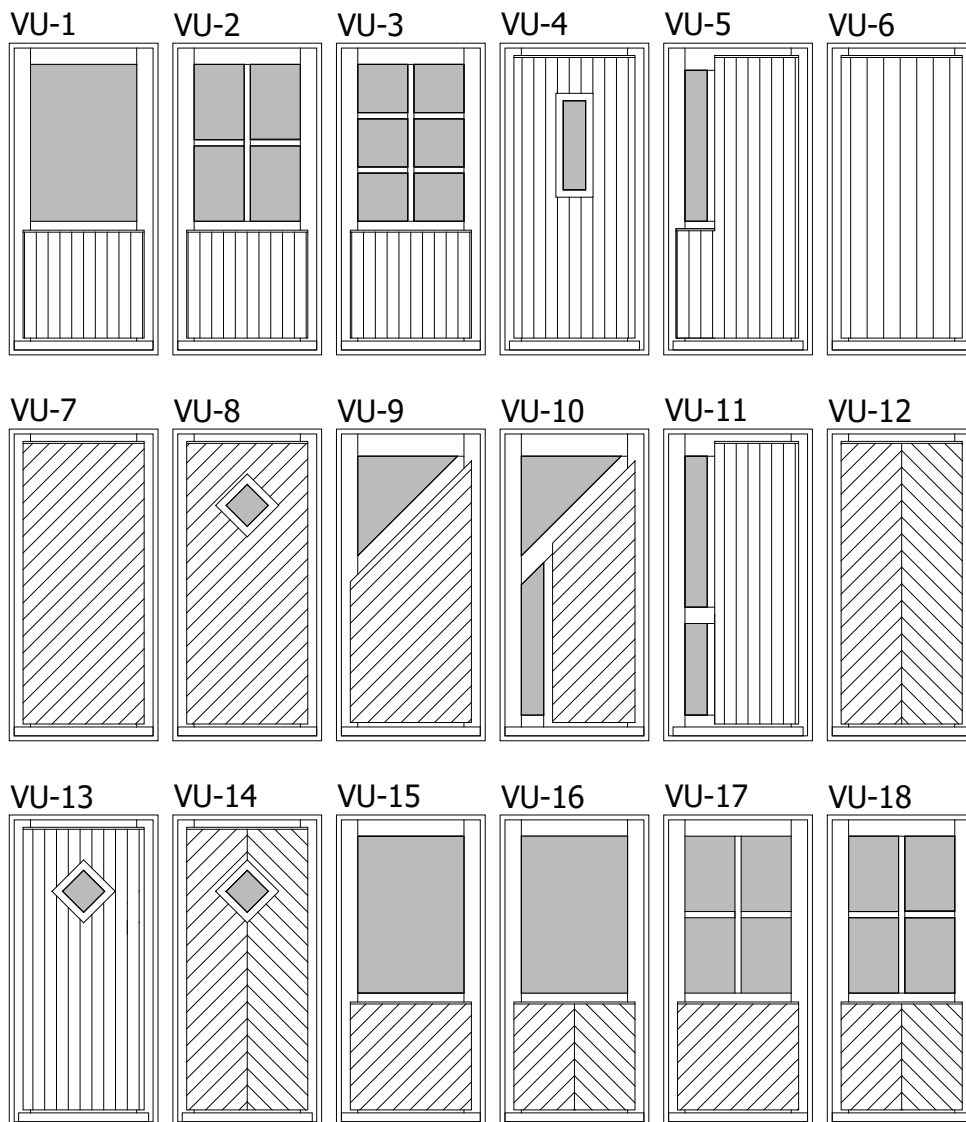

OPENING

