



The "Aru 68 CLASSIC IN" window with the bevelled edged sash and frame (rustical profile) is a suitable solution for buildings with a more classical architecture using a double glazed unit. The choice of timber includes knotted and knot free pine, finger jointed Pine, Meranti Oak.



A three-layered window, the frame is protected with an aluminium glazing bead. The Georgian style bars also have a rustical profile. There's an option of using concealed hinges. Available with a choice of handles.

Aru 68 CLASSIC IN

Aru 68 CLASSIC IN

INWARD OPENING, TILT AND TURN WOODEN WINDOW

PROFILE IV68

Jamb: 68 x 68 mm

Frame: 68 x 68 mm

Inside groove for windowcill, outside for aluminium cill
Aluminium slat on the lower part of the frame

FURNITUR

Fittings: ROTO NT

Handle: ROTO, HOPPE



GLASS

24 mm double or triple glazed units ($U_g \geq 1,1W/m^2K$)

Glazing from the inside with wooden glazing bead

Fastened with hidden nails, sealed with silicone

SEAL

2-chamber seal surrounding middle frame rebate

FINISHING

with water-based paint or stain

Handle positions

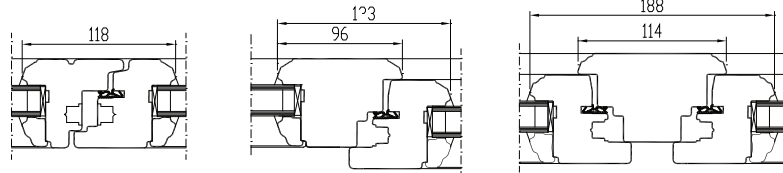
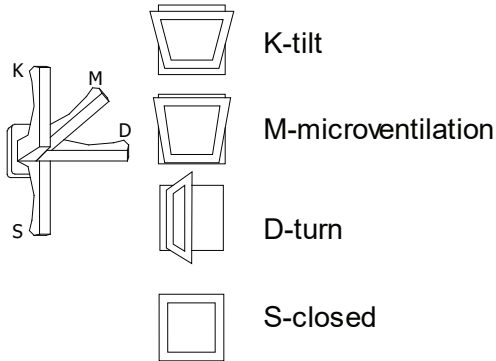

GLAZING BAR OPTIONS

1. Penetrating bars 50 mm
2. Taped bars Norwegian style
3. Taped bars Georgian style
4. Bars inside the glazing

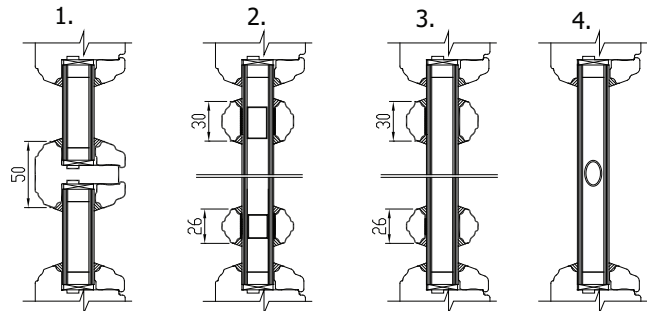

OPENING:

Inside view



F - FIXED

2x or 3x glazing in the frame. Aluminium slat on the lower part of the frame
min measures 330 x 330 mm

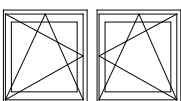

DK - TILT AND TURN (LEFT / RIGHT)

min max L=401...1710 mm H=409...2527 mm, weight max 130 kg

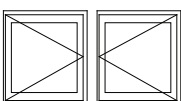

D - SIDEHUNG (LEFT / RIGHT)

min max L=401...1710 mm H=409...2527 mm, weight max 130 kg

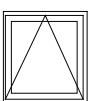

KIPP - TOPHUNG (Handle above)

weight max 80 kg

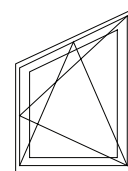

Round-headed window

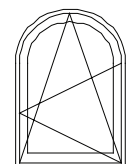

NB! Maximum and minimum dimensions and opening possibilities also depend on the aspect ratio. Please ask our specialists for additional information.