

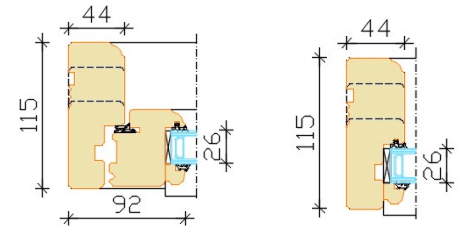

## Aru 60 Classic EX Outwards opening wooden window

- Made to Measure Sizes
- Thermal performance of window  $U_w 1,3 \text{ W/m}^2\text{K}$   
(openable window 1230x1480 mm; glass  $U_g-1,1$ )
- Frame width 115 mm (also available 95 mm or 68 mm)
- Sash profile thickness 60 mm
- Timber selection: laminated pine timber, laminated oak timber
- Timber finishing with waterbased paint or stain. Paint according to RAL colour chart, stain according to manufacturer's samples.
- Double glazing ( $U_g > 1,06 \text{ W/m}^2\text{K}$ )
- Glazing with glazing beads outside, fastened with hidden nails, sealed with internal and external gasket
- Glazing bar options:
  1. penetrating bars
  2. glued on both sides of glass+slats inside the glazing (Norwegian style)
  3. glued on both sides of glass (Georgian style)
  4. decorative bars inside the glazing
  5. removable on the outside
  6. bar frame on the hinges (outside)

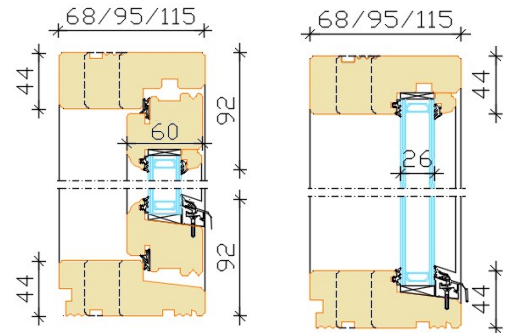
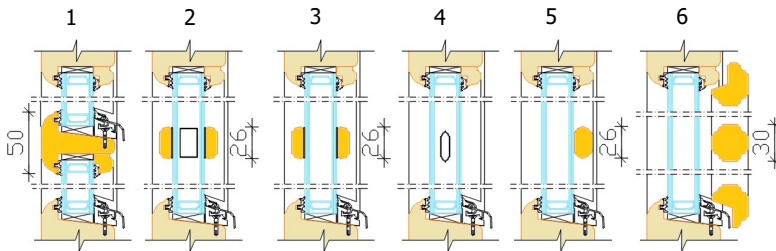

Openable window

Fixed window

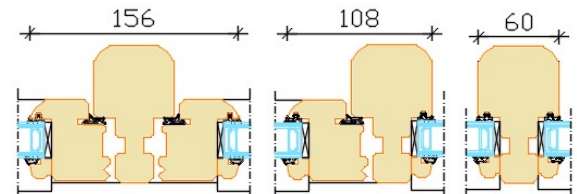

Openable+openable

Openable+Fixed

Fixed+Fixed

- Extras:
  - jamb extensions;
  - grooves for the extension (10x10 mm grooved frame);
  - window boards;
  - vents;
  - special glasses (toughened, laminated, sun protection, self cleaning, pattern etc.);
  - various glass spacers;
  - key lockable handles, design handles;
  - child restrictors
- Different combinations of openable and fixed parts are possible in the common frame
- Triangular, arched windows

### OPENING Outside view



**FIXED (direct glazing)**  
Min sizes 330 x 330 mm

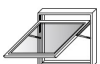

**TOPGUIDED**  
Min max L= 370...1600 mm H= 370...1600 mm, sash weight max 60 kg

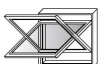

**TOPSWING**  
Min max L= 385...1600 mm H= 595...1645 mm, sash weight max 60 kg

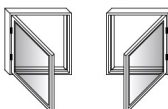

**SIDEHUNG (left/right)**  
Min max L= 360...850 mm H= 515...1500 mm, sash weight max 40 kg



**SIDE-SLIDEHUNG (concealed hinges; left/right)**  
Min max L= 395...850 mm H= 515...1500 mm, sash weight max 50 kg

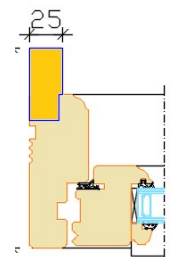

Frame with extension

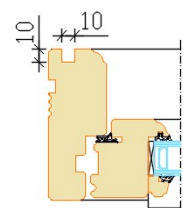

Grooved frame