

Be creative
start right here!





Alex **5**



Barbados 3 44 Double **6**



Barbados 3 70 **7**



Barbados 5 **8**



Barbados Mini 70 **9**



Brighton 70 **10**



Dorset 1
Dorset 2
Dorset 3 **11**



Elba 70 **12**



Exeter 1 **13**



Exeter 2 **14**



Jari 3 **15**



Java **16**



Lyndhurst **17**



Multi 71
Multi 72
Multi 73 **18**



Orkney 1 **19**



Shetland 1
Shetland 2 44 Double
Shetland 2 70 **20**



Spiekeroog 1
Spiekeroog 2
Spiekeroog 3 **21**



Staffordshire 1 70
Staffordshire 1 44 **22**



Staffordshire 2 70
Staffordshire 2 44 **23**



Tahiti 70 **24**



Tirol 44
Tirol 70 **25**



Warwickshire 70 **26**



Zanzibar 1
Zanzibar 2
Zanzibar 3
Zanzibar 4 **27**



Antigua **28**



Canberra **29**



Arkansas **30**



Blue Nile **31**



Canada **32**



Ceylon **33**



Columbia **34**



Euftrat **35**



Ganges **36**



Grossglockner **37**



Han 70 **38**



Indus **39**



Jordan **40**



Kasai A 70 **41**



Kasai B 70 **42**



Maipo **43**



Matterhorn **44**



Mekong **45**



Mekong XL **46**



Missouri **47**



Mont Blanc **48**



Oka 70 **49**



Orange 70 **50**



Orinoco **51**



Orkney 2 **52**



Orkney 3 **53**



Orkney 4 **54**



Orkney 5 **55**



Orkney 6 **56**



Orkney 7 **57**



Orkney 8 **58**



Orkney 9 **59**



Orkney 10 **60**



Snake 70 **61**



Tennessee **62**



Tigris **63**



Tresco **64**



Twin Cabin **65**



Valga **66**



Vanessa 1 **67**



Volta **68**



White Nile **69**



Yukon **70**



Windows **71**



Doors **72**

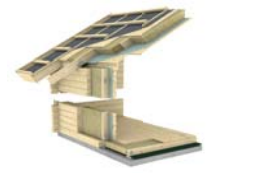

Construction **73**

Concept

We at Nordic-Holz value creativity. We value creativity both on the customer side but also on our company side as we specialise in creating bespoke log cabin solutions for our customers. Therefore, when examining this catalogue and looking at the products please keep in mind that these designs are mostly created to inspire and give ideas for your very own creations.

By creating bespoke cabins we can offer you a very personal building. YOUR building. Never be afraid to ask us if anything can be done. If it can be, we will do it. If it can not be done, we will patiently explain you why.

So be sure to take your sketchbook with you as you go through this myriad of designs and do not be afraid to draw up anything that comes to your mind because we want to make you the cabin that you had in mind. However, if you're not that creative, we also provide a range of products that are our stock products. These products are therefore cheaper and take less time to deliver. Some of these products are displayed in our catalogue too, but most of these products can be found in our mother-company Lasita Maja's catalogue.

Where to Begin?

As a whole it would be good to keep in mind that the construction of a summer cabin is similar to the construction of any smaller house, so to start with, the following things should be considered:

1. A suitable location
2. Financing for the project - both for the cabin and it's installation & the connecting services
3. Getting familiar with the building regulations in your area
4. Getting a planning or building consent from the relevant authorities
5. Planning the rooms
6. Choosing the architect/installer/buildier
7. The coordination of various projects
8. Composition of the order
9. Organising the construction
 - a. Construction of the concrete foundation/base
 - b. Preparation for the receival of the wooden parts of the house and suitable storage (must be kept off the ground and dry)
 - c. The erection of the wooden parts
 - d. A topping-out ceremony for good luck
 - e. Decorating and weatherproofing the wooden parts
 - f. Installation of the roof
 - g. Installation of doors and windows
 - h. Connecting Services (plumbing and sewage, electric and heating systems)
 - i. Finishing the outer decoration
 - j. Finishing the landscape and garden

When you're taking a look at the list – that is a lot of various and pretty hard things to consider. Don't let yourself be frightened by the fact. We have done this many times, it's not rocket science and we would be glad to help you out too!

How will I create a suitable house for my needs?

The most important question to create a house suitable to your needs is – „**What will this house be used for?**“

For example if the house is planned as additional living accomodation, then the design/construction needs to be based around this. If the building is going to be used for storage, then more emphasis should be placed on the floor to be able to support the weight of the stored items and maybe consider a different type of access for a wheelbarrow or even a car.

However, these different solutions also influence the final cost of your product, so keep in mind not to add anything that's really not necessary! For example there is no point to install living space quality windows to a house which is used as a garage and sparsely heated. When choosing the heat insulation package, a principle should be followed – it's better to insulate evenly. So it's really not very useful to insulate the floors when the ceilings are left uninsulated and vice versa.

Materials and product classes

We use nordic spruce (Picea abies) for our products which has proven its suitability for houses. Finger jointing of the material also allows us to manufacture constructions which are longer than the standard length of the log (6 metres). The available wall thicknesses are 44, 70 and 94 millimeters.

We divide our products into four product classes – 1+, 2+, 3+ and 5+. Each of our product classes has a different set of characteristics that goes for doors, windows and the construction of the house (insulation, cable canals etc) You can learn more about the product classes in the end part of this catalogue.

Component Set

Depending on the product group the components supplied may also change, but generally we offer you everything that is needed to erect the house with the only exception of insulation materials for the larger houses.

Ordering

To place an order we suggest you to turn to our retailers who will help you find the best solution for your needs. To answer your two most important questions : “How much would my concept house cost?” And “ could I see what it looks like?“, we have created a unique online software that creates a visual model of what you are looking for, therefore allowing you to find the answers to these questions. More detailed information about it can be found on our homepage.

Symbol Keys

These are the symbol keys you have to get acquainted to in order to be able to learn more about our products.

	Foundation Dimensions		Cubic Volume		Doors
	Wall Thickness		Roof Slopes		Packet dimensions
	Ridge Height		Roof Angle		Packet weight
	Wall Height		Felt Rolls / Shingle Packs		In Stock
	Under Roof Area		Windows		

Alex 70



Alex 70

7010940

250 x 300

70

251,6

204

6,75

15,38

9,60

19

1/5

1x1100x1320

1x1340x1865

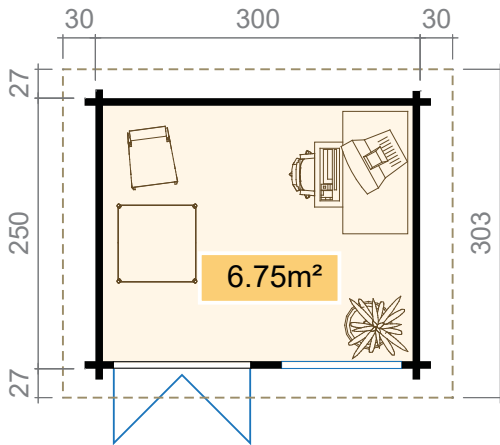

Our gardenhouse Alex is a great addition to a smaller garden. It is suitable for a garden office or a workshop or a general leisure house. It is also available as a special edition which comes with leaded glass design, which gives the house a historical look. Only a limited number of products available.



440x115x70, 1030kg

Barbados 3 44 Double



Barbados 3 44 Double

443780

309 x 399

2x44

238

204

9,8

25,89

23,36

6

3

3x552x1729

1x1580x1933

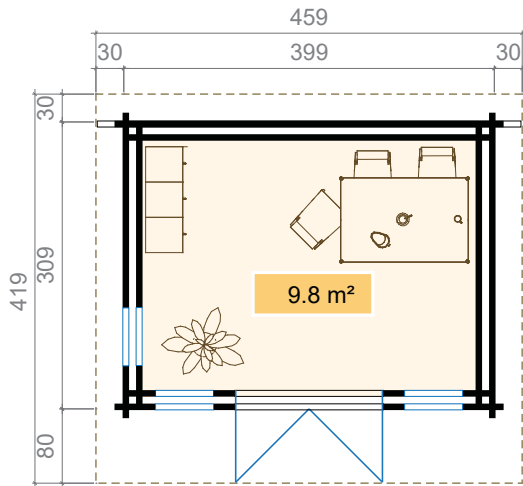

The Barbados 3 44 Double is a cabin that has 2 44mm thick double walls. This gives you the option to insulate the area between two walls therefore making the cabin usable all year round. Since it is a more difficult house to install it is recommended to use professional installers.



630x115x85, 1786kg

Barbados 3 70



Barbados 3 70

7011602

309 x 399

70

244,8

210,8

9,8

25,87

19,37

7

3

3x552x1729

1x1580x1933

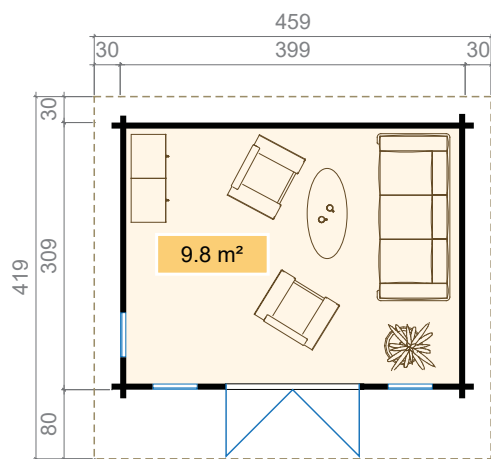

630x115x70, 1471kg

Barbados 5



Barbados 5

7010702

399 x 519

70

244,8

210,8

19,44

44,29

29,60

4

3

3x552x1729

1x1580x1933

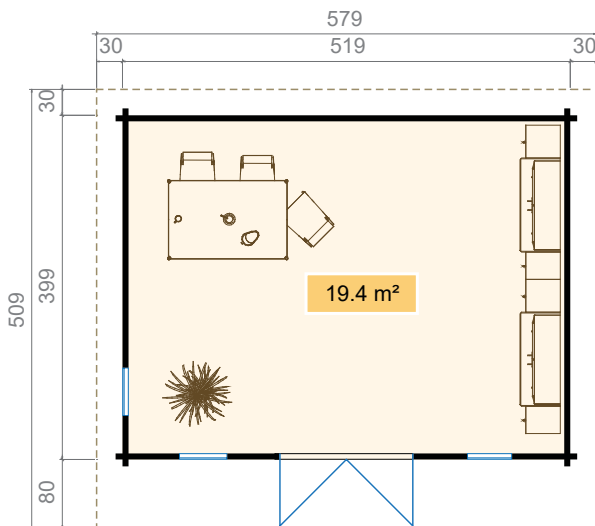

Barbados 5 is a single roomed cabin with a modern design. The 800mm front overhang gives a good protection to both the windows and the door so the rain doesn't affect you as much. Perfect to use as a home office or a general garden building.



630x115x94, 1975kg 200x115x45, 300kg

Barbados Mini 70



Barbados Mini 70

7010802

240 x 330

70

238

204

7,14

15,78

13,81

8

2

2x552x1729

1x1580x2000

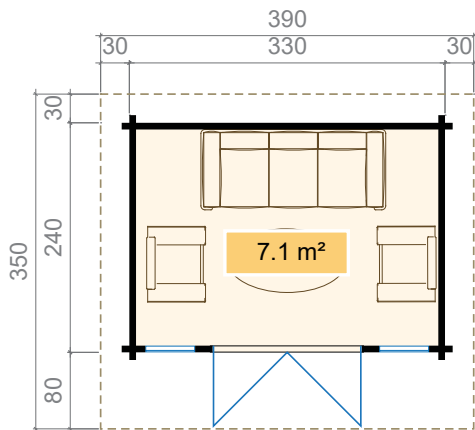

The Barbados Mini 70 as the name says is a small addition to the Barbados product family. It gives just that tiny bit of extra room to people who are in need of it. It can be your little garden retreat or you can even use it for storing your extra stuff. Also possible to create that small office corner in the greens.



440x115x82, 1203kg

Brighton 70



Brighton 70

7011802

370 x 520

70

251,6

204

14,9

41,03

25,52

13

3/10

1x552x1729

1x1100x1729

1x1580x2000

1x1580x2000

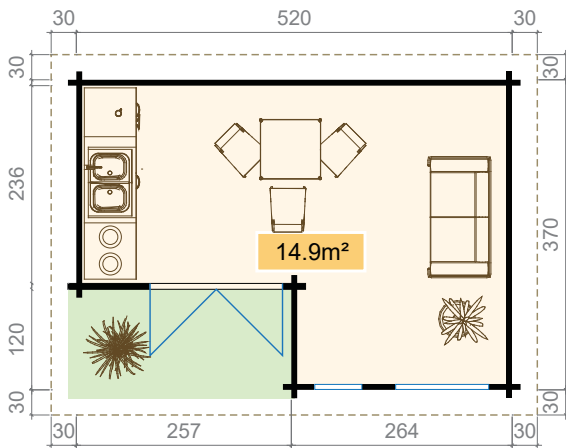

The Brighton 70 is a development of our Orkney range cabins. Still provides that small private terrace that is secluded by screening, but unlike the Orkneys it comes with a two-sloped roof making it a better fit for rainy conditions.



630x115x88, 1849kg



Model	Code	Width (cm)	Height (mm)	Depth (cm)	Depth (cm)	Floor Area (m²)	Volume (m³)	Floor Area (m²)	Angle (deg)	Rolls/Packs	Width (mm)	Width (mm)
Dorset 71	709502	250 x 400	70	237,5	234,9	9,11	21,51	16,62	4	2	1x1100x1729	1x1580x1933
Dorset 72	709602	250 x 450	70	235,5	224,4	10,29	23,66	18,43	4	2	1x552x1729 1x1100x1729	1x1580x1933
Dorset 73	709702	250 x 480	70	235,5	224,4	11,0	25,29	19,51	4	2	2x1100x1729	1x1580x1933

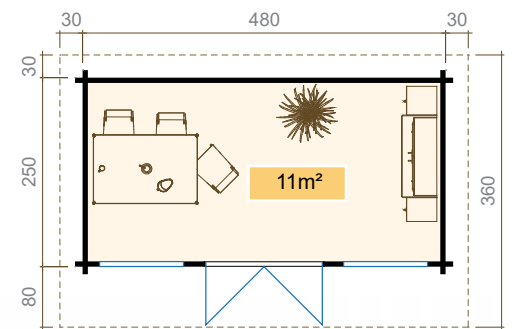
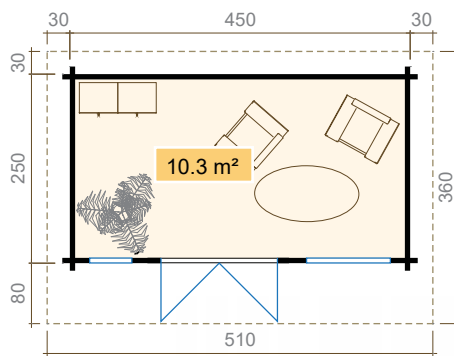
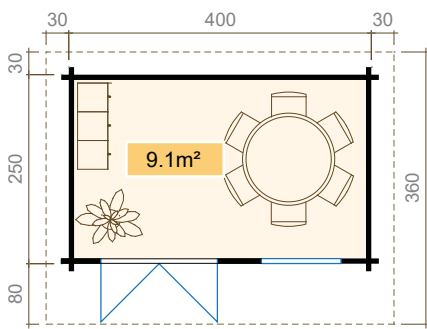

Dorset 71	450x115x85, 1276kg
Dorset 72	630x115x77, 1617kg
Dorset 73	630x115x82, 1723kg

Elba 70



Elba 70

701002

420 x 540

70

265,2

217,6

20,8

51,55

35,50

14

3/14

4x916x916

1x827x1933 2x827x1933 int.

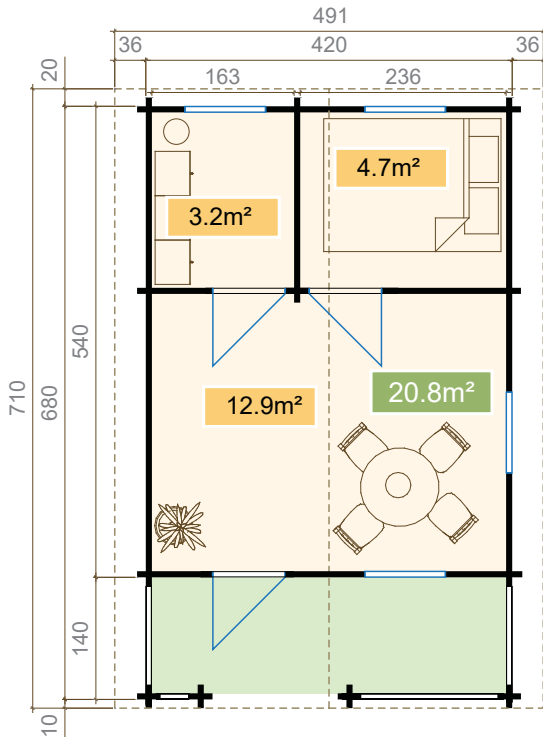

Elba 70 gives you the flexibility often much needed in garden buildings. Providing you with three separate rooms, the rooms can be used in accordance with your wishes and needs. Great for use as a guest house, a sauna or a storage building. Why not even all of them.



710x115x69, 1619kg 630x115x57, 1185kg

Exeter 1



Exeter 1

7012202

524 x 390

70

238

244,8

18,83

45,45

30,36

2

3/-

3x552x1729 1x510x510
1x1500x510

2x827x1933 int.
1x2600x2000

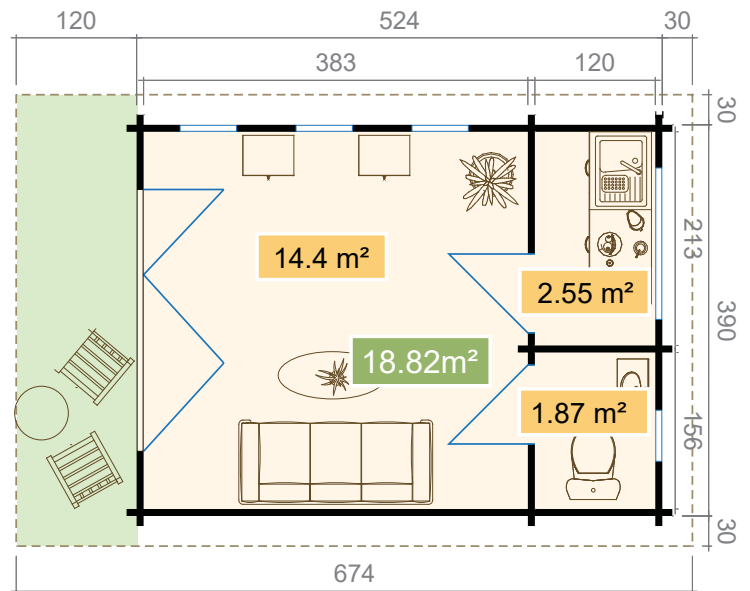

The Exeter houses have an extra option for terrace screening styled shutters for windows. (See smaller picture). Both of them also have bi-fold doors.



210x115x95, 665kg

Exeter 2



Exeter 2

7012302

397 x 390

70

238

244,8

14,40

34,76

24,65

3

3/-

3x552x1729

1x2600x2000

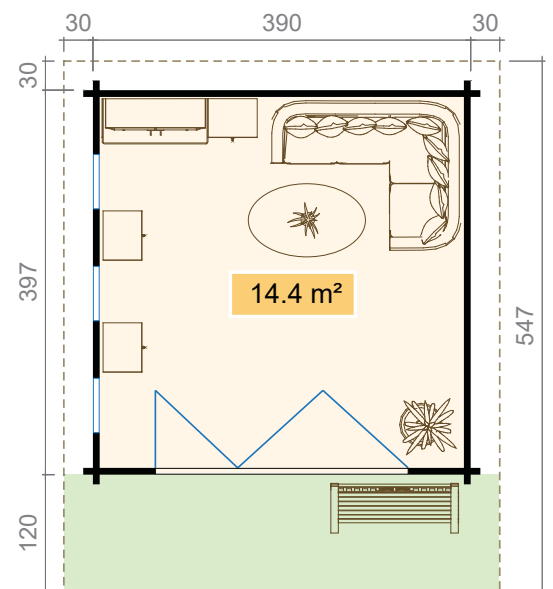

The Exeter houses have an extra option for terrace screening styled shutters for windows. (See smaller picture). Both of them also have bi-fold doors.



210x115x80, 560kg

Jari 3



Jari 3

703542

360 x 360

70

285,6

224,4

11,9

23,05

42,56

20

5/16

1x1374x1050 1x1374x916

1x827x2000

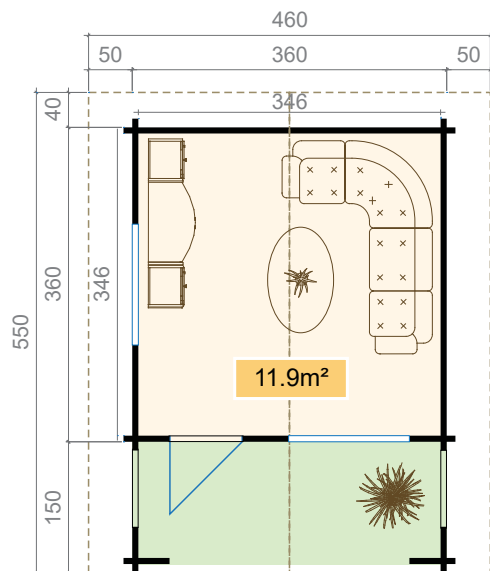

Classical Finnish styled summer house Jari 3 comes with preparations made for the insulation of both roof and floor making the house easily adaptable for harder weather conditions.



630x115x53, 1114kg 630x115x58, 1219kg



Java

704247

390 x 608,5

70

241,5

210,8

22

50,55

30,56

6

3

1x1500x500

1x4100x2000 1x827x1865
1x827x1933 int.

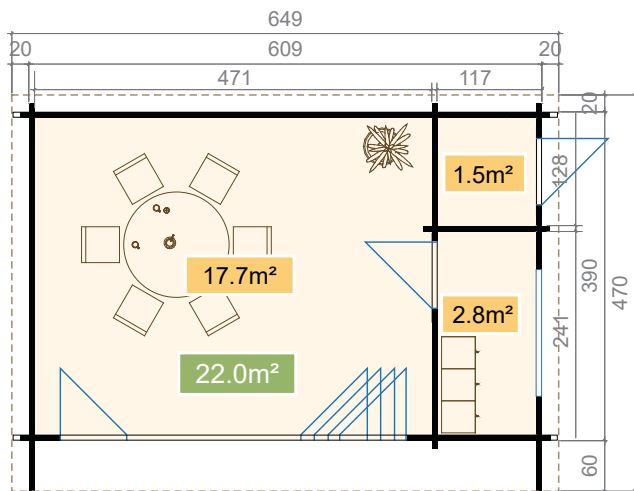

Java is a multifunctional and spacious garden building with a bi-fold door. The house is divided into 3 rooms – the main room is a great place for relaxation and the 2 smaller rooms are perfect for storing your garden tools and any other equipment.



650x115x106, 2298kg 200x115x69, 460kg

Lyndhurst



Lyndhurst

7011902

400 x 550

70

244,8

224,4

15,33

35,96

28,88

8

8/20

-

1x4100x2000

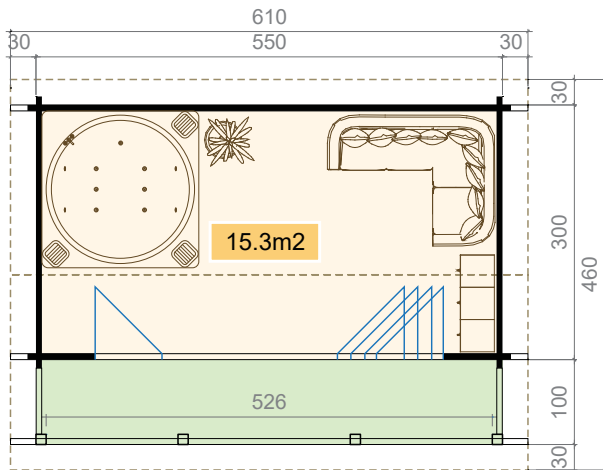

The Lyndhurst is a modern, 1-roomed garden house with a folding door. Perfect to use as a pool house or as a hot tub cottage.



840x115x81, 2269kg 420x115x72, 1009kg 200x115x57, 380kg



Model	Code	Width (cm)	Height (mm)	Length (cm)	Depth (cm)	Area (m²)	Volume (m³)	Area (m²)	Angle (deg)	Rolls/Packs	Width (mm)	Width (mm)
Multi 71	709802	640 x 840	70	346,8	231,2	33,90	97,97	66,60	20	5/25	1x1100x1729	1x552x1729
Multi 72	709902	640 x 840	70	346,8	231,2	33,90	97,97	66,60	20	5/25	1x1100x1729	1x552x1729
Multi 73	706602	640 x 840	70	346,8	231,2	33,90	97,97	66,60	20	5/25	1x1100x1729	1x552x1729

1x1580x1933
1x827x1933 int.
1x2375x2075
1x1580x1933
1x827x1933 int.
1x2375x2075
1x1580x1933
1x827x1933 int.
1x2375x2075

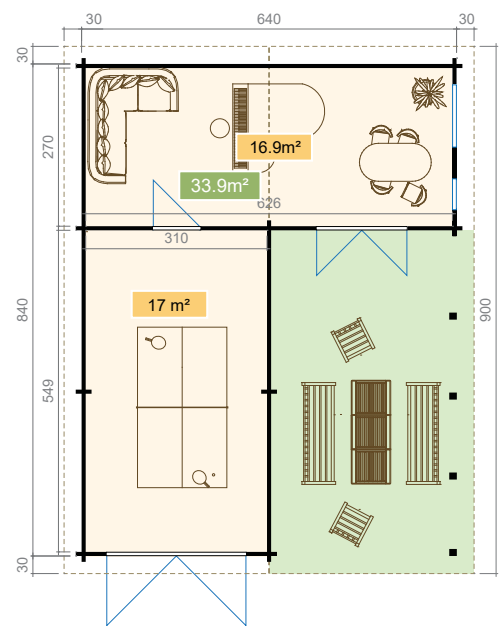
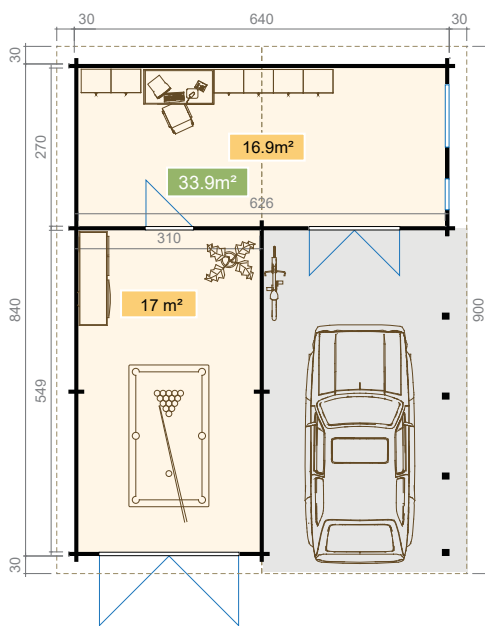
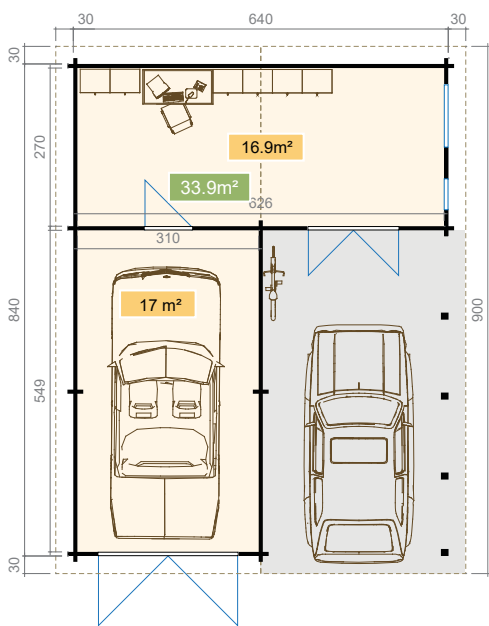

Multi 71	660x115x85, 1871kg	660x115x85, 1871kg	250x202x20, 293kg
Multi 72	660x115x85, 1871kg	660x115x85, 1871kg	250x202x20, 293kg
Multi 73	660x115x85, 1871kg	660x115x85, 1871kg	250x202x20, 293kg

Orkney 1



Orkney 1 704142 390 x 520 70 231,2 217,6 15,9 38,0 27,26 2 3 1x552x1729 1x1100x1729 1x1580x2000

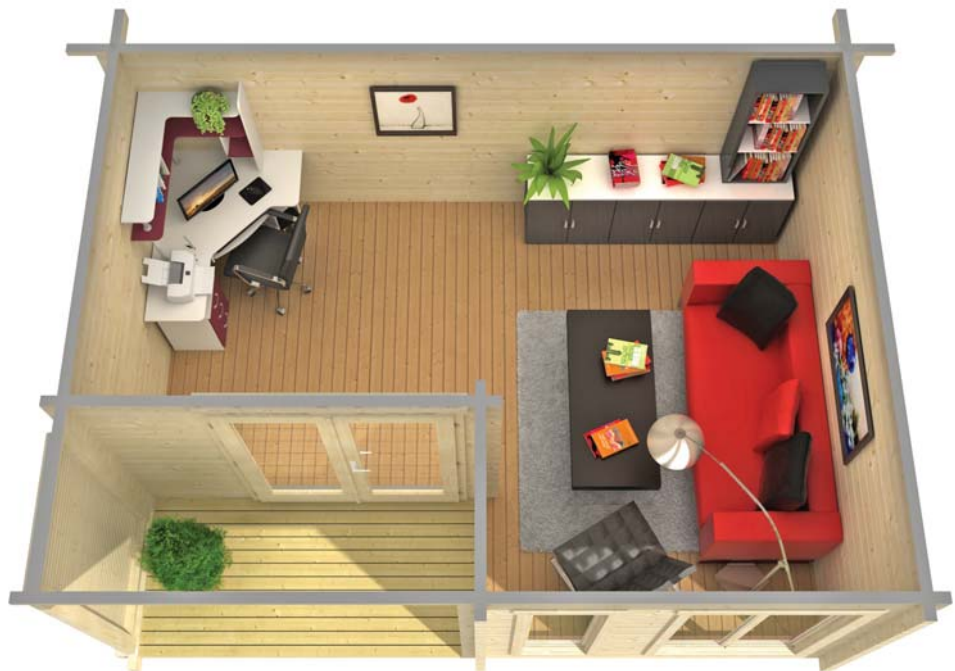
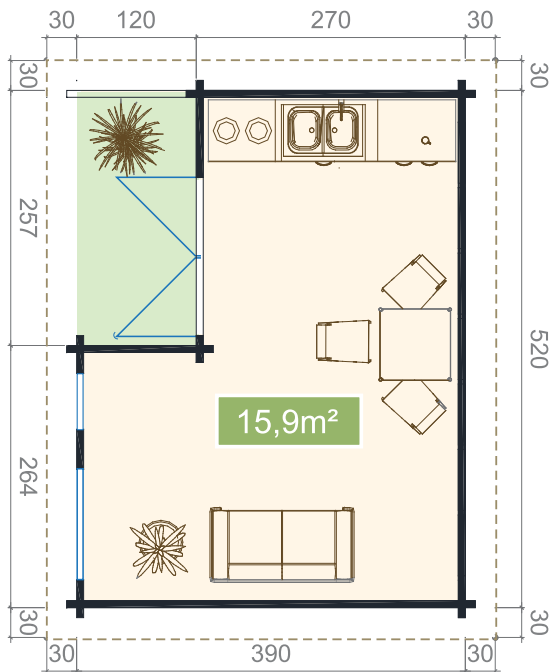

Roof insulation kit included.



630x115x101, 2122kg

Shetland





 Double walled version available!

											
-----------------------------------------------------------------------------------	-------------------------------------------------------------------------------------	-------------------------------------------------------------------------------------	-------------------------------------------------------------------------------------	-------------------------------------------------------------------------------------	-------------------------------------------------------------------------------------	-------------------------------------------------------------------------------------	-------------------------------------------------------------------------------------	--------------------------------------------------------------------------------------	---------------------------------------------------------------------------------------	---------------------------------------------------------------------------------------	---------------------------------------------------------------------------------------

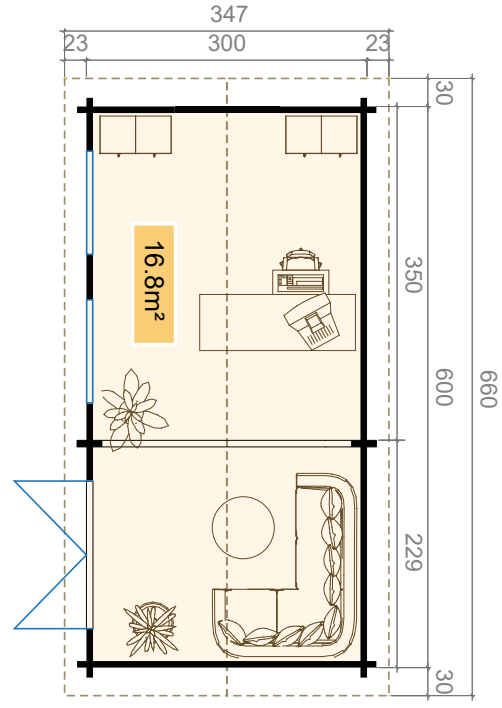
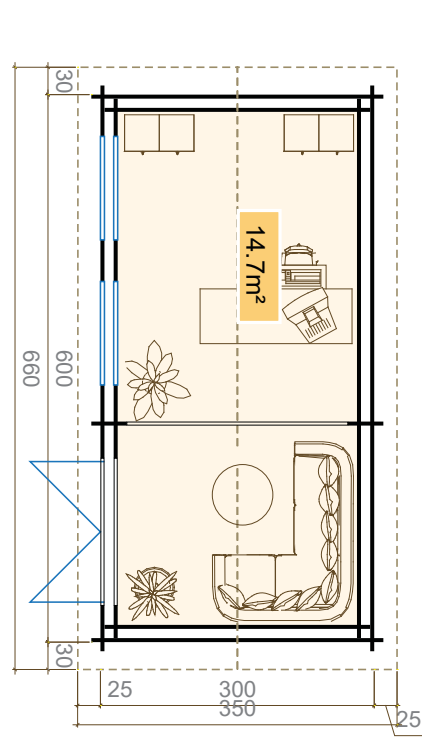
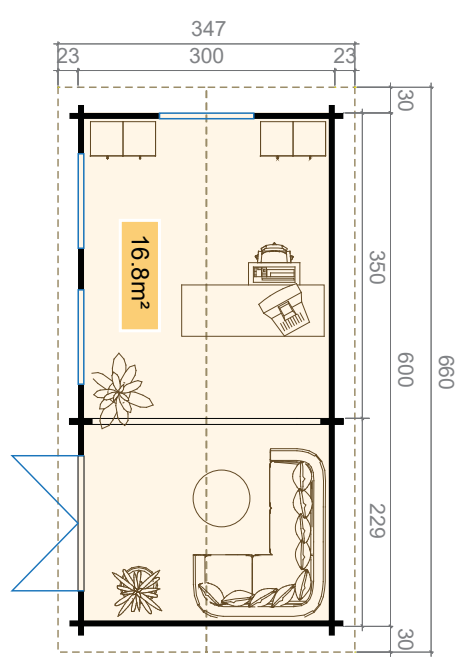
Shetland 1 70	7011002	300 x 600	70	244,8	204	16,76m²	37,61m³	23,76	17	3/10	3x1100x1729	1x1580x1865
Shetland 2 44 Double	4419780	300 x 600	2x44	251,6	204	14,7	35,29	23,76	17	2/10	2x1100x1729	1x1580x1865
Shetland 2 70	7011202	300 x 600	70	251,6	204	16,76	38,18	23,76	17	2/10	2x1100x1729	1x1580x1865



		Shetland 1 70	660x115x85, 1871kg
		Shetland 2 44 Double	660x115x90, 1981kg
		Shetland 2 70	660x115x79, 1739kg

Spiekeroog



Spiekeroog	Code	cm	mm	cm	cm	m ²	m ³	m ²	deg	rolls/pacs	mm	mm
Spiekeroog 1	700102	390 x 390	70	265,2	217,6	14,1	35,41	24,38	15	3/11	1x916x916	1x1580x1933
Spiekeroog 2	700202	480 x 390	70	278,8	217,6	17,5	45,07	28,62	15	3/12	1x1374x916	1x1580x1933
Spiekeroog 3	700302	480 x 480	70	278,8	217,6	21,7	55,52	31,86	15	3/12	1x1374x916	1x1580x1933

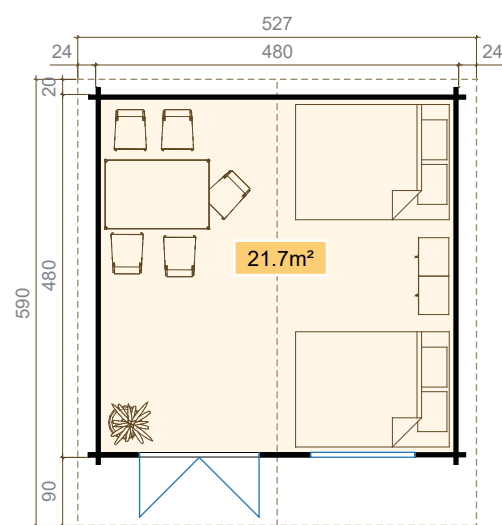
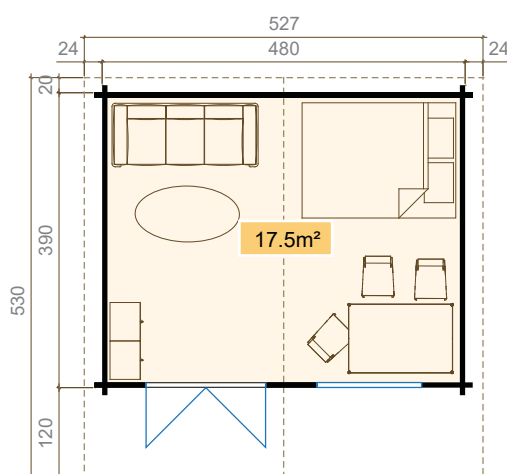
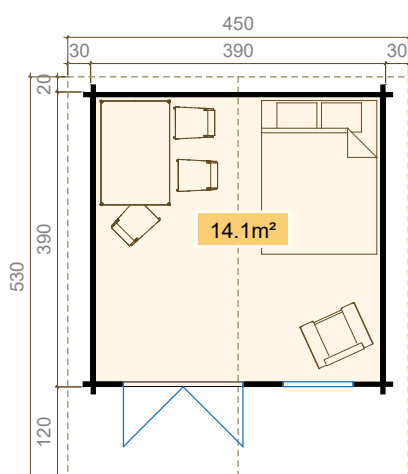

Spiekeroog 1	630x115x78, 1695kg
Spiekeroog 2	630x115x93, 2021kg
Spiekeroog 3	630x115x98, 2130kg

Staffordshire 1 70



Staffordshire 1 44	4421602	370 x 540	44	272	306	19,19	55,45	36,80	19	4/14	2x1200x1320	1x1580x2000
Staffordshire 1 70	7012402	370 x 540	70	217,6	306	18,73	49,02	36,80	19	4/14	2x1200x1320	1x1580x2000

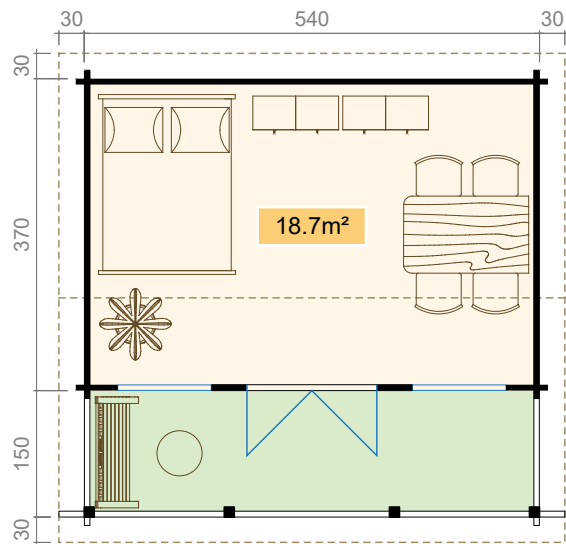

Staffordshire 1 70	630x115x85, 1786kg	450x115x82, 1201kg
Staffordshire 2 70	630x115x81, 1772kg	450x115x82, 1201kg

Staffordshire 2 70



Staffordshire 2 44	4421702	370 x 540	44	244,8	244,8	19,19	44,36	35,05	10	4/14	2x1200x1320	1x1580x2000
Staffordshire 2 70	7012502	370 x 540	70	217,6	244,8	18,73	43,29	35,05	10	4/14	2x1200x1320	1x1580x2000

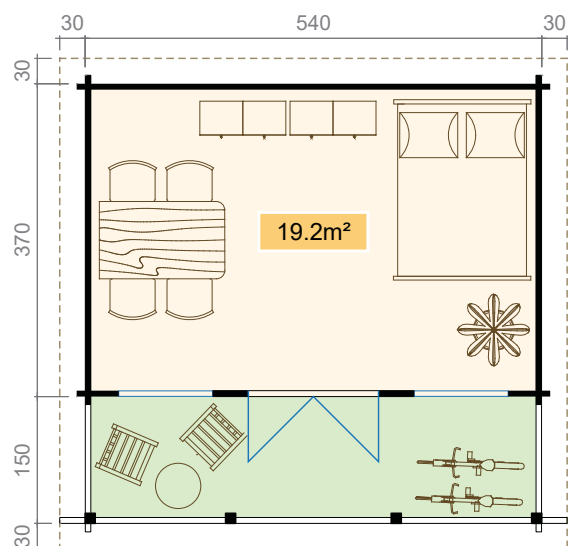

Staffordshire 1 44	630x115x79, 1662kg	450x115x82, 1201kg
Staffordshire 2 44	630x115x78, 1639kg	450x115x82, 1201kg

Tahiti 70



Tahiti 70

701302

390 x 540

70

360,4

258,4

22,9/5,89

61,19

29,0

27.61

3/12

2x1374x916 3x916x916

1x827x1933

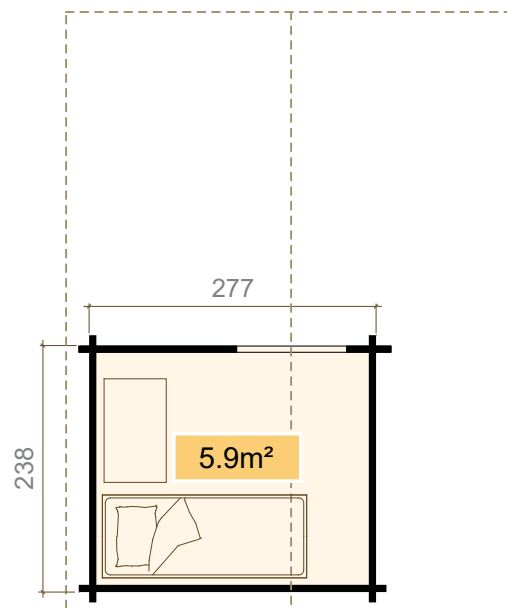
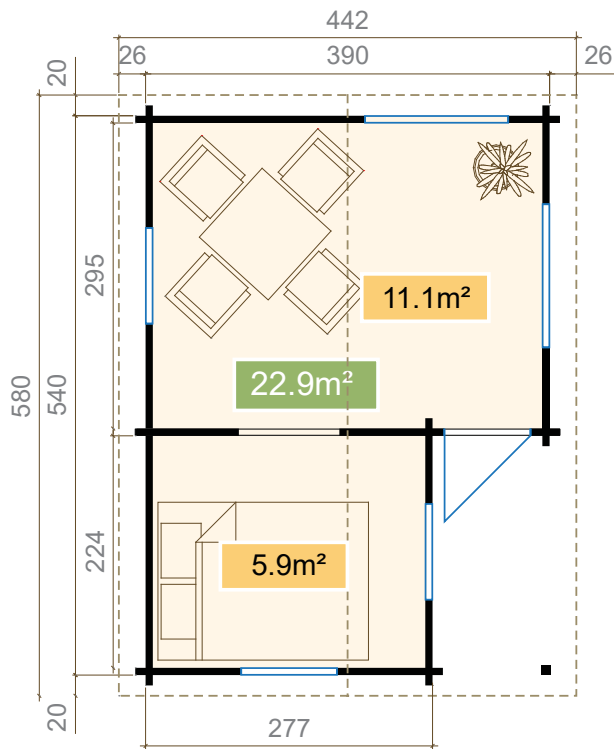

Our Tahiti model is perfect for your weekend in garden. This garden house has two rooms and a practical loft area.



630x115x108, 2269kg 200x115x65, 433kg



Tirol 44	4420202	340 x 300	44	285,6	224,4	9,64	24,59	12,60	20	3/7	1x702x1050	1x1580x2000
Tirol 70	7012144	340 x 300	70	272	210,8	9,32	23,14	16,81	20	3/7	1x702x1050	1x1580x2000



Tirol 70 - 325kg/m²
Tirol 44 - 250kg/m²

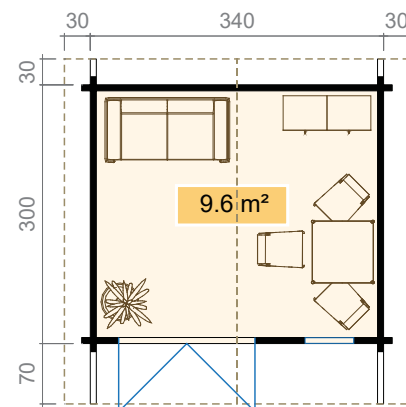
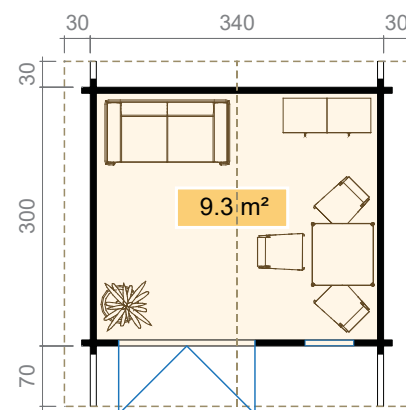

Tirol 44 450x115x79, 1186kg
Tirol 70 450x115x84, 1261kg

Named after a snowy and hilly region in Austria, Tirol buildings are designed for rough and snowy climates. The roof construction uses rafters instead of purlins to be able to support more weight during snowy winters. Tirol 44 can support up to 250 kg, Tirol 70 up to 325 kg of weight per roof m².

Warwickshire 70



Warwickshire 70	705502	280 x 480	70	238	204	12,40	27,39	19,98	14	2/9	1x1374x916 2x702x916	1x1580x1865

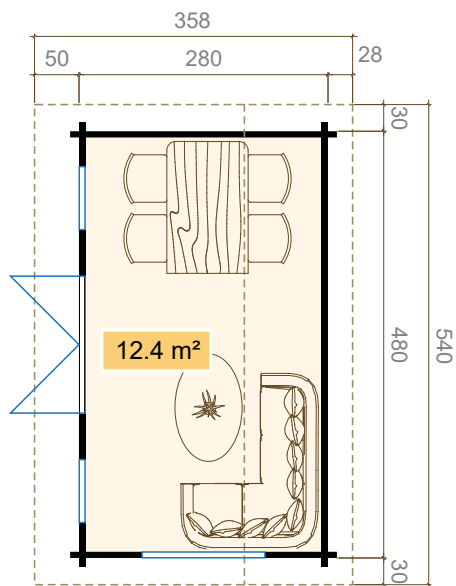

This cabin is perfect for office use, as the windows are designed at desk height but allowing in plenty of light, with fully glazed double doors and two single windows and one double window.

630x115x90, 1891kg

Zanzibar



		cm	mm	cm	cm	m ²	m ³	m ²	deg	rolls/pacs	mm	mm	
Zanzibar 1	700702	485 x 390	70	217,6	292,4	17,71	45,16	31,36	17	3/12	1x1374x916	1x916x916	1x1580x1933
Zanzibar 2	700602	485 x 485	70	217,6	292,4	22,18	56,57	36,68	17	4/14	1x1374x916	1x916x916	1x1580x1933
Zanzibar 3	700802	485 x 575	70	217,6	292,4	26,42	67,38	41,72	17	4/16	1x1374x916	1x916x916	1x1580x1933
Zanzibar 4	700902	575 x 575	70	217,6	312,8	31,47	83,46	49,17	15	5/18	2x1374x916		1x1580x1933

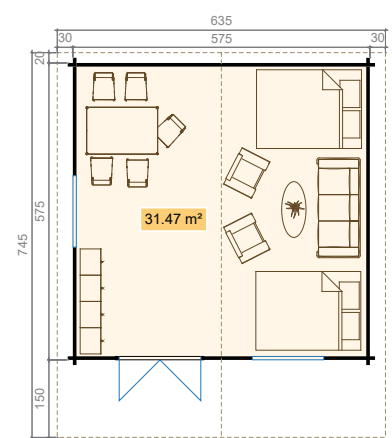
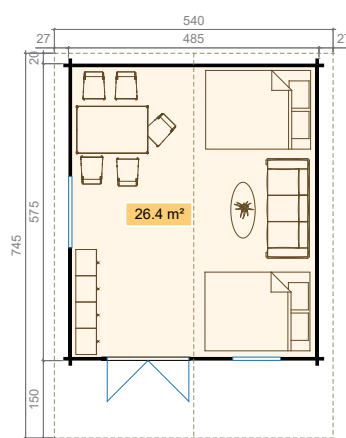
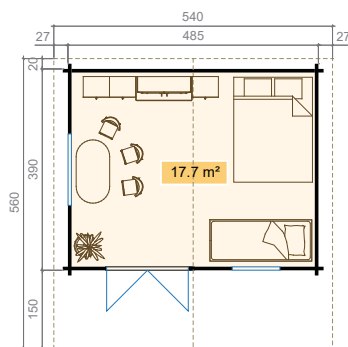
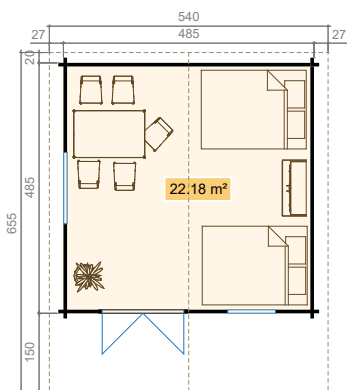

Zanzibar 1	630x115x48, 1008kg	560x115x60, 1120kg	200x115x47, 314kg
Zanzibar 2	630x115x54, 1134kg	655x115x60, 1311kg	200x115x47, 314kg
Zanzibar 3	600x115x54, 1080kg	745x115x64, 1590kg	200x115x49, 327kg
Zanzibar 4	600x115x54, 1080kg	750x115x62, 1551kg	200x115x49, 327kg

Antigua



Antigua

704193

360 x 540

70

285,6

238

18,81

49,24

26,40

16

3/11

1x916x916

1x827x1933

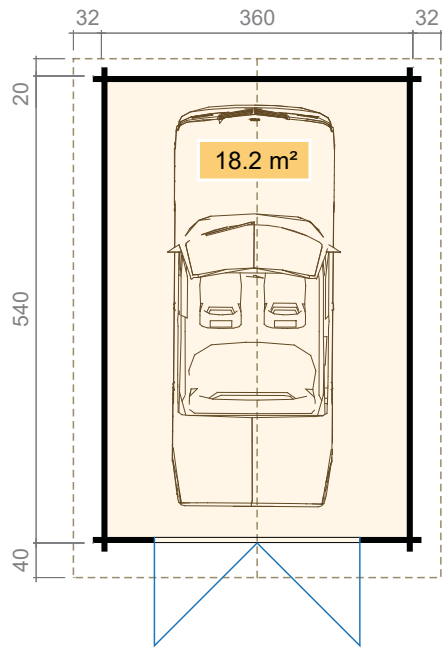

Available with two different doors – with regular wooden garage doors or a up-and-under type garage door.



The position of the door and window can be chosen by the client



650x115x90, 1951kg

Canberra



Canberra

7011193

360 x 540

70

241,6

224,4

18,20

42,40

24,90

5

3/11

2x1492x378

1x827x1933

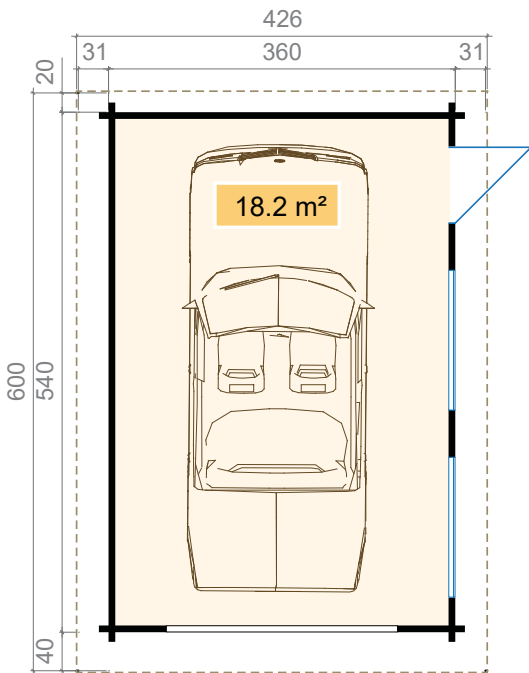

Available with two different doors – with regular wooden garage doors or a up-and-under type garage door.



630x115x80, 1701kg

Arkansas



Arkansas 703141 450 x 697 70 299,2 224,4 24,9 64,64 32,80 22 7/13 2x1374x916 1x1580x1933 1x827x1933

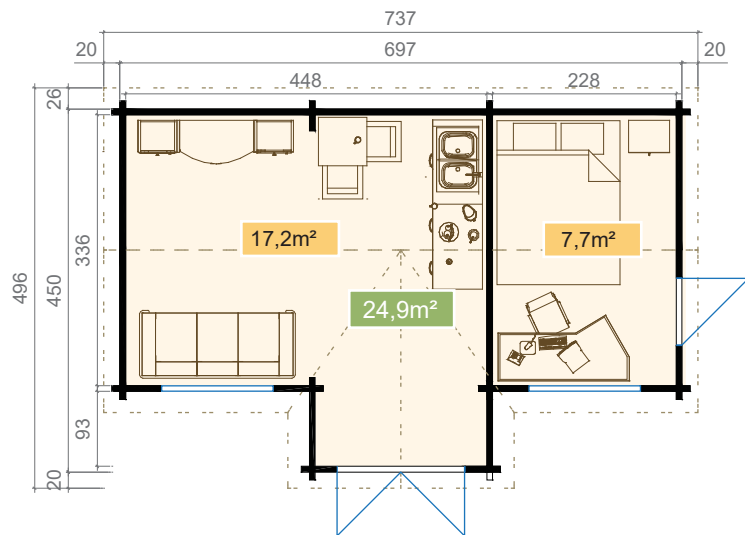

740x115x67, 1654kg 470x115x60, 941kg 220x115x56, 411kg

Blue Nile



Blue Nile 703041 500 x 600 70 333,2 244,8 28,01 80,94 73,32 14 10/27 1x1374x916 2x552x1729 1x1580x1933 1x827x1933 int.

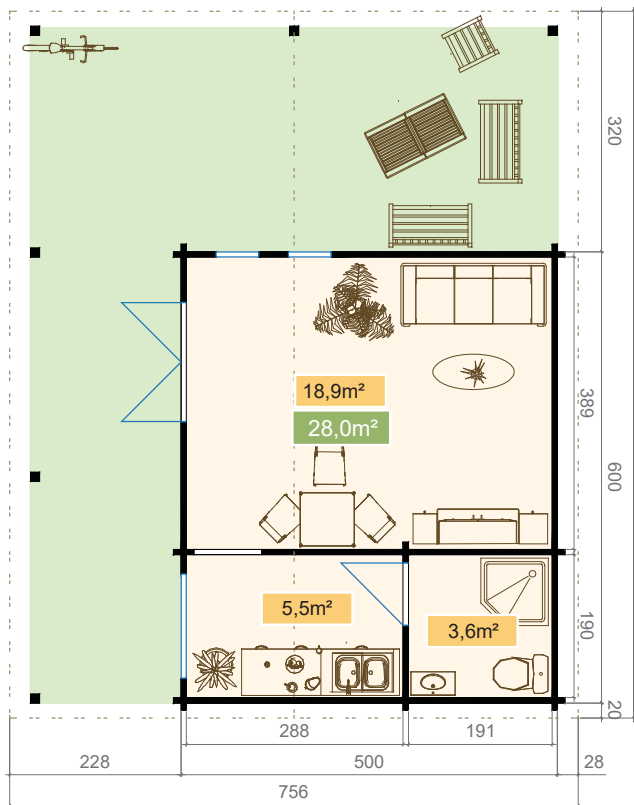

730x115x71, 1729kg 620x115x84, 1737kg 470x115x76, 1191kg 200x115x55, 367kg



Canada 703442 540 x 640 70 448,8 251,6 32,6/12 121,55 70,01 36 10/25 1x650x650 3x916x1050 3x1374x1050 1x827x2000 1x827x2000 int.

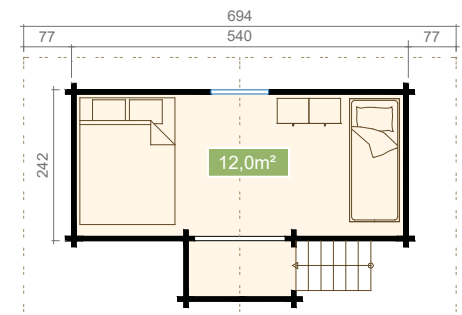
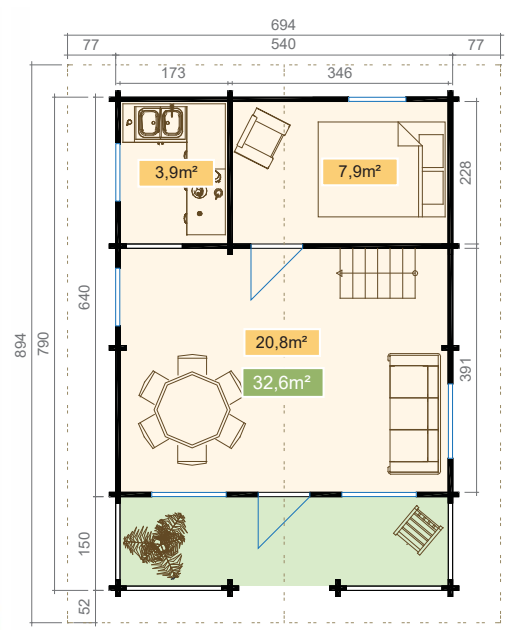

Roof and floor insulation kit included!



900x115x82, 2461kg 400x115x55, 734kg 530x115x91, 1608kg 530x115x89, 1573kg 200x115x88, 587kg



Ceylon	706142	540 x 740	70	489,6	346,8	40,7/35,3	156,19	77,85	28	10/28	2x916x916 3x650x650 1x1500x650 2x1100x1729	1x1580x2000 1x827x2000 2x827x1933 int. 3x827x2000 int.
--------	--------	-----------	----	-------	-------	-----------	--------	-------	----	-------	-----------------------------------------------	--------------------------------------------------------------

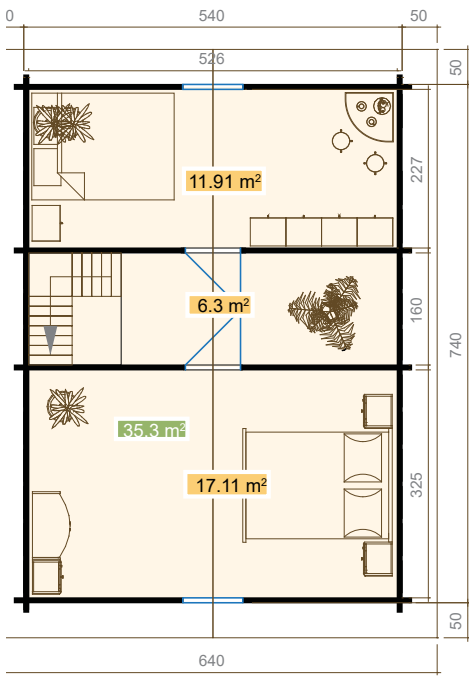
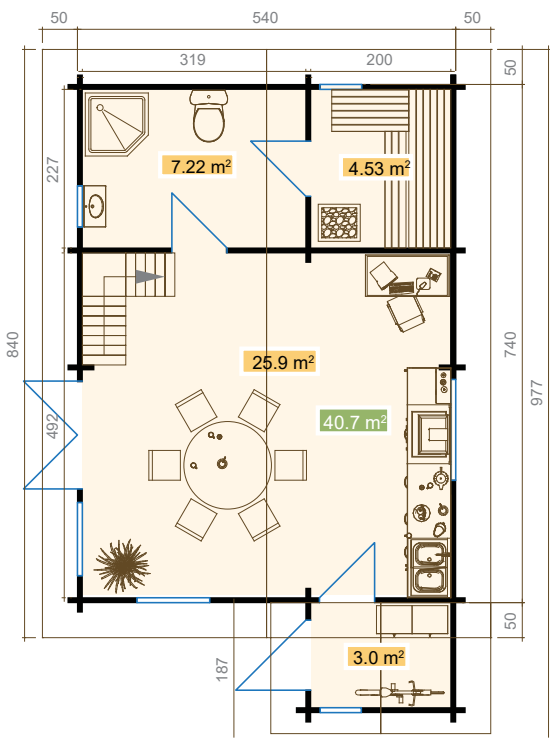

 **Roof and floor insulation kit included!**



940x115x61, 1912kg 630x115x91, 1912kg 630x115x98, 2059kg 210x115x95, 665kg 250x82x44, 262kg

Columbia



Columbia 703241 599 x 664 70 346,8 231,2 47,58 137,51 73,50 21 10/25 2x916x916 2x552x1729 1x650x650 2x702x1190 2x1374x916 2x827x1933 1x827x1933 int. mm

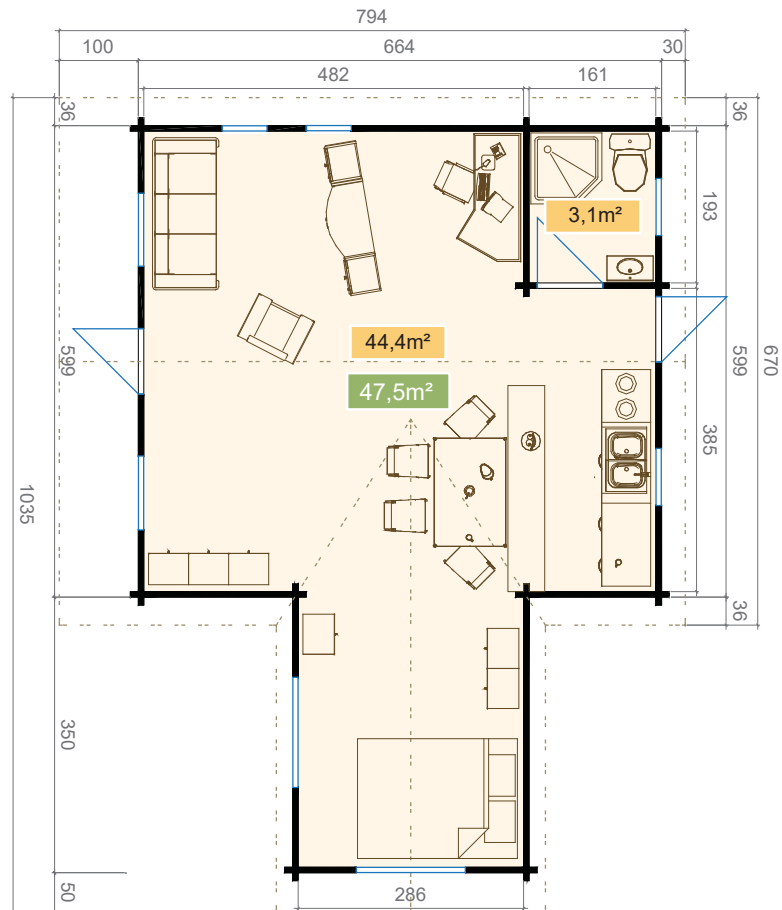

800x115x83, 2214kg 630x115x102, 2143kg 200x115x91, 607kg



Eufrat 701941 464 x 800 70 374 238 34,8/13,32 107,12 58,95 30 10/23 3x916x916 2x650x650 3x1100x1729 1x827x1933 2x827x1933 int.

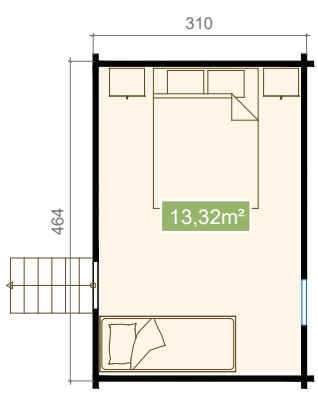
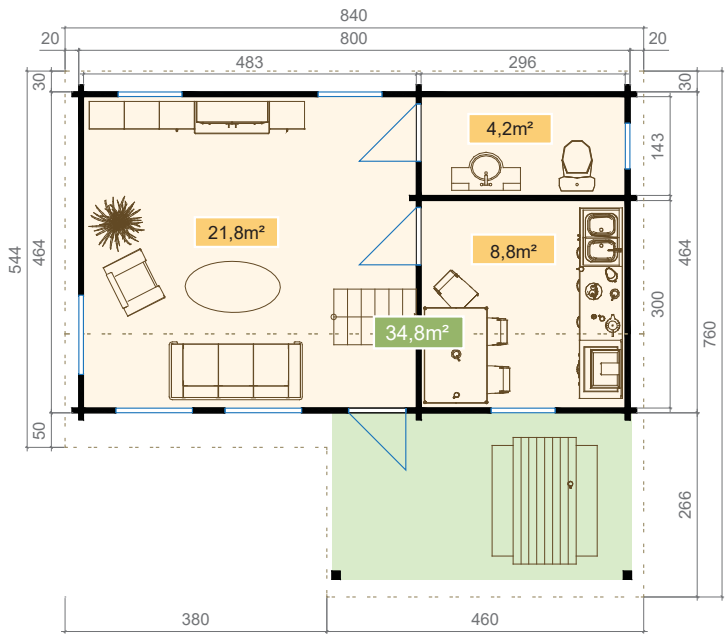

 **Roof and floor insulation kit included!**



760x115x75, 1901kg 450x115x68, 1021kg 470x115x72, 1129kg 200x115x91, 607kg

Ganges



Ganges 702041 780 x 730 70 394,4 265,2 46,64/19,47 153,83 75,64 18 9/27 2x552x1729 3x650x650 1x702x1190 2x1374x916 2x1100x1729 2x827x1933 1x827x1933 int.

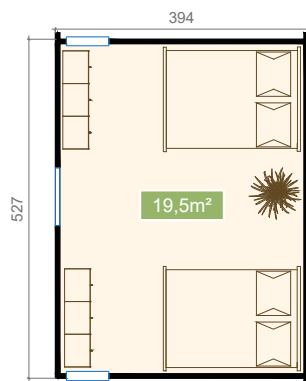
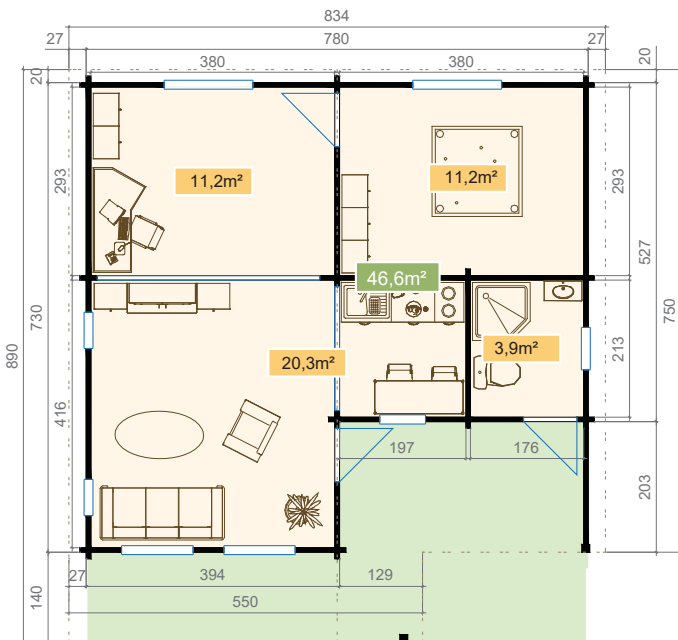

Roof and floor insulation kit included!



900x115x61, 1831kg 600x115x95, 1901kg 600x115x126, 2521kg 200x115x101, 674kg

Grossglockner

 **Roof and floor insulation kit included!**
 **Includes a wooden staircase!**



--	--	--	--	--	--	--	--	--	--	--

Grossglockner 7011148 540 x 640 70 476 278,8 32,50/12,0 122,66 69,79 36 9/26 1x916x1050 2x650x650 1x1374x1050 2x1100x1729 1x827x2000 2x827x2000 int.

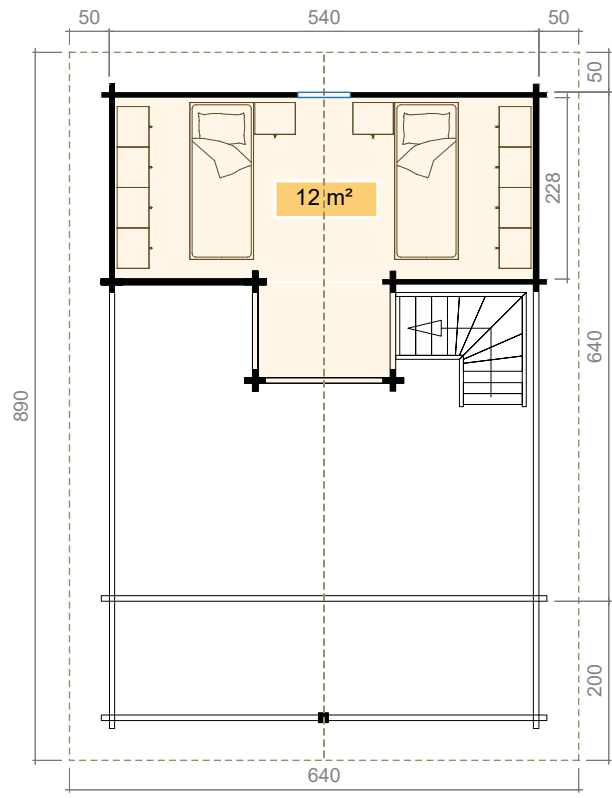
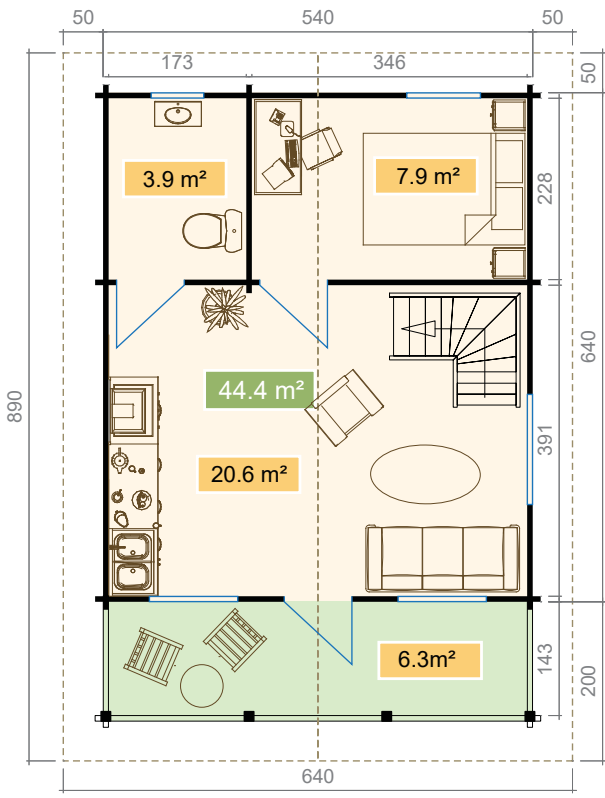

--	--

690x115x85, 1956kg 650x115x85, 1843kg 420x115x85, 1191kg 890x115x60, 1781kg 210x115x85, 1002kg

Han 70



Han 70 7010441 575 x 625 70 394,4 278,8 33,9/13,2 112,25 58,82 22 8/22 1x650x650 4x916x1050 2x1374x1050 1x827x2000 3x827x2000 int.

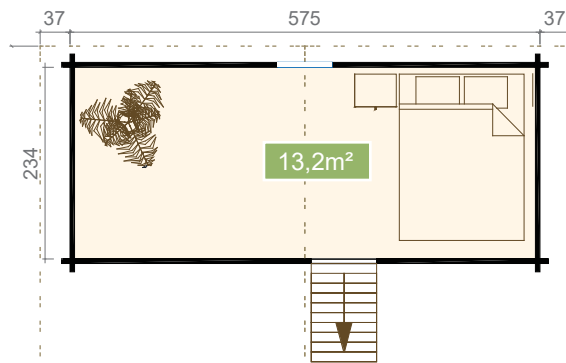
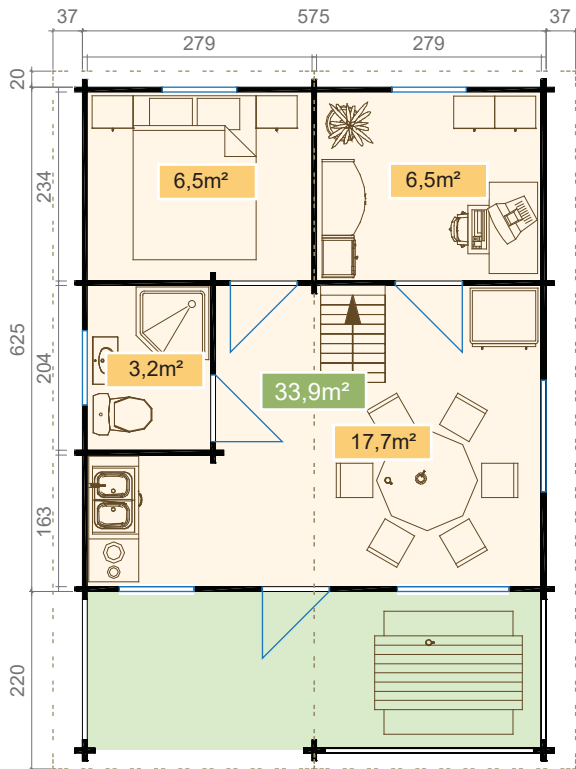

650x115x98, 2124kg 650x115x98, 2124kg 360x115x95, 1141kg 200x115x95, 634kg

Indus



Indus	702141	580 x 867	70	319,6	217,6	41,63	111,83	63,04	19	8/23	3x916x916 1x702x1190 2x1374x916	1x827x1933 3x827x1933 int.
-------	--------	-----------	----	-------	-------	-------	--------	-------	----	------	------------------------------------	-------------------------------

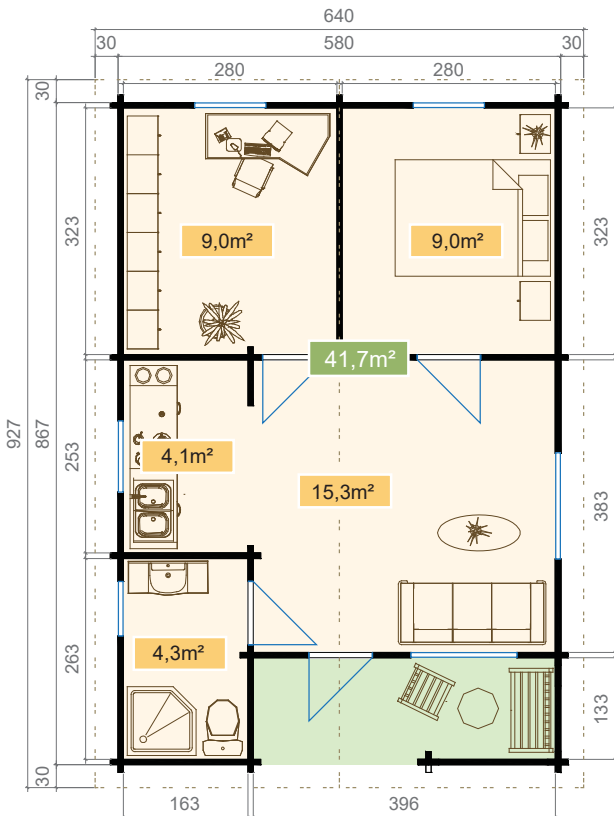

760x115x103, 2611kg 630x115x95, 1996kg 200x115x89, 594kg

Jordan



Jordan 702341 575 x 575 70 306 217,6 28,0 73,0 46,90 17 8/18 1x702x1190 2x916x916 2x1374x1050 1x650x650 2x827x1933 3x827x1933 int.

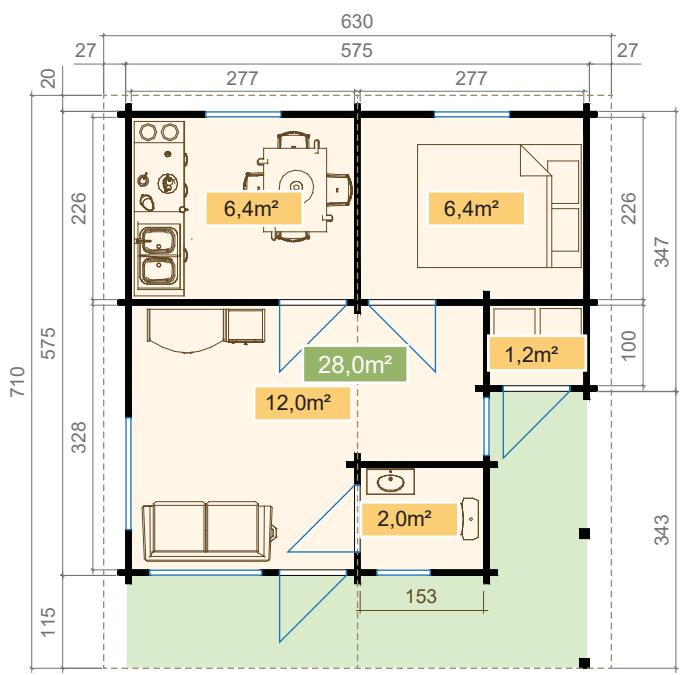

710x115x70, 1715kg 200x115x80, 552kg 220x115x70, 531kg

Kasai A 70



Kasai A 70 7010141 575 x 775 70 312,8 224,4 35,2 98,03 53,79 17 8/20 5x916x1050 1x1374x1050 1x827x2000 3x827x2000 int.

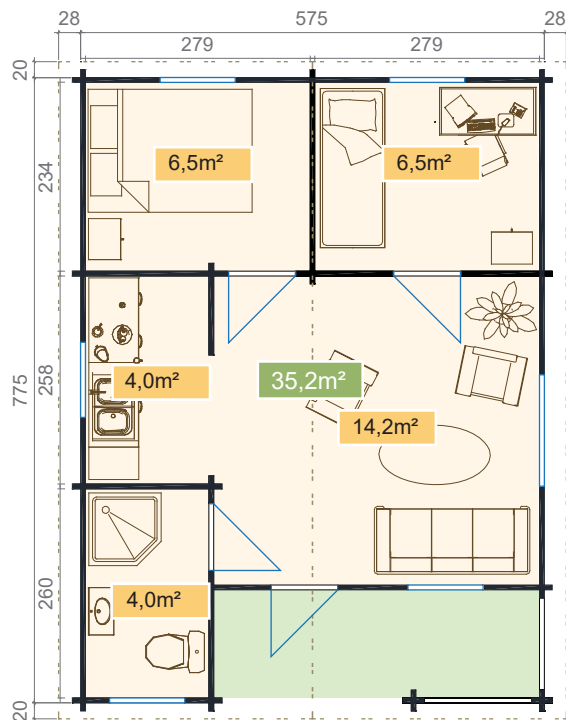

630x115x87, 1828kg 630x115x87, 1828kg 360x115x87, 1045kg 200x115x80, 534kg

Kasai B 70



Kasai B 70 7011741 575 x 865 70 312,8 224,4 41,5 110,60 59,73 18 8/24 5x916x1050 1x1374x1050 1x827x2000 3x827x2000 int.

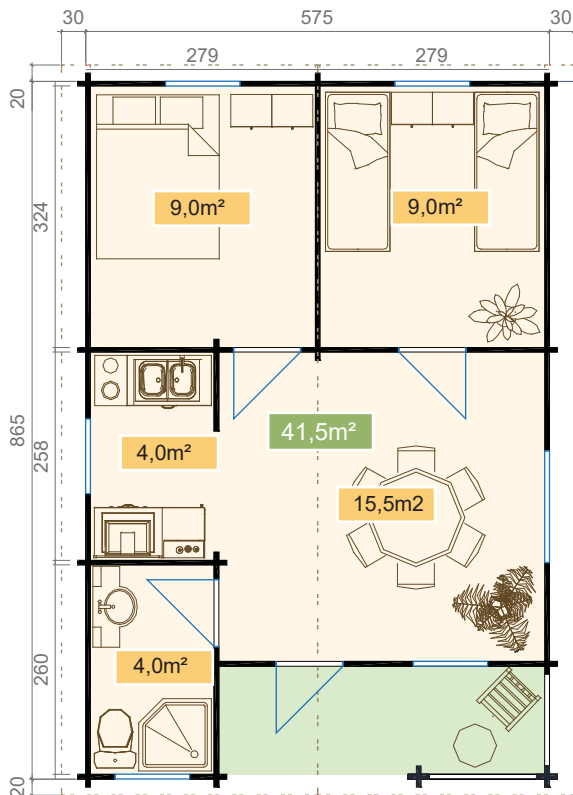

630x115x87, 1828kg 630x115x87, 1828kg 360x115x87, 1045kg 200x115x80, 534kg

Maipo



Maipo 702841 400 x 700 70 455,6 272 26,5/9,6 95,35 50,99 41 8/23 2x650x650 2x916x916 1x1580x1933 1x827x1933

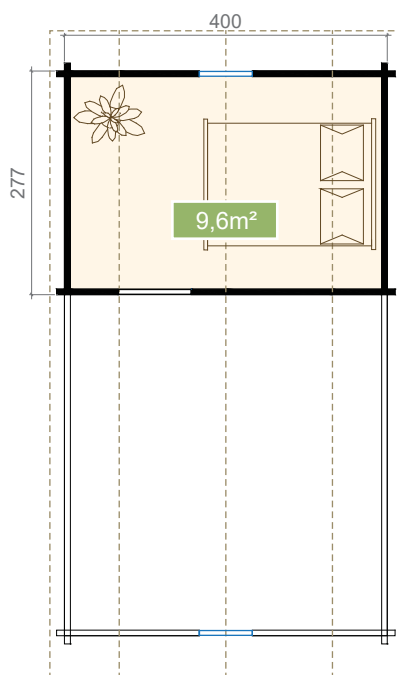
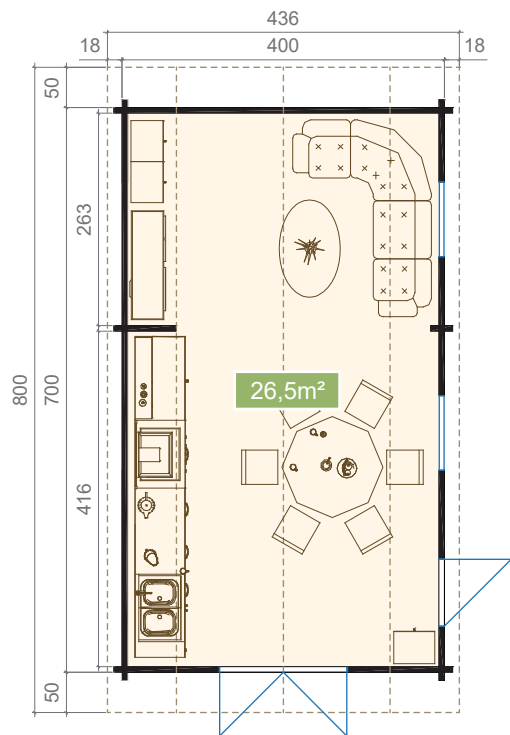

690x115x85, 1956kg 650x115x85, 1843kg 420x115x85, 1191kg 890x115x60, 1781kg 210x115x85, 595kg

Matterhorn



Matterhorn 7011248 540 x 740 70 516,8 360,4 37,63/35,14 165,05 61,57 30 12 1x650x650 2x1100x1729 2x916x916 4x1200x650 4x827x2000 int. 1x1580x2000 1x827x2000

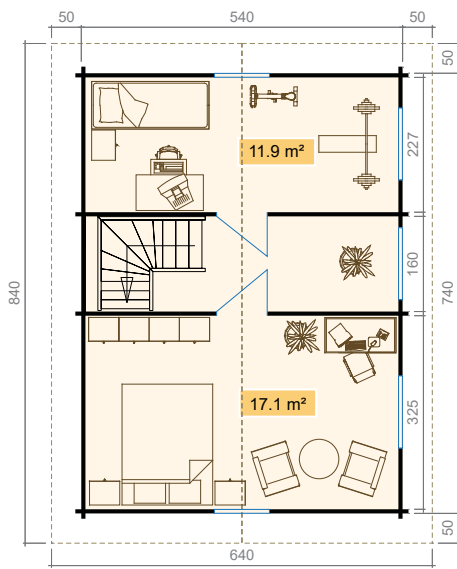
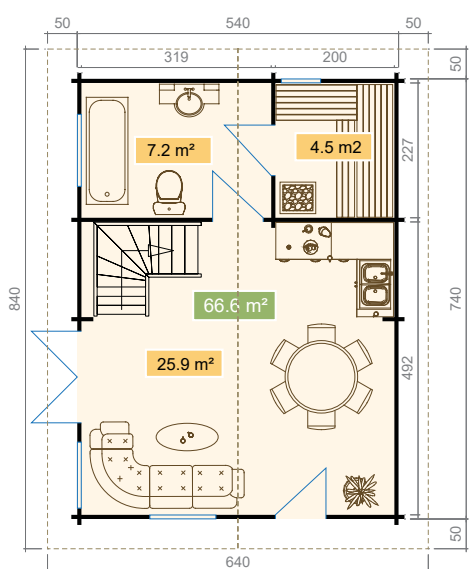

Roof and floor insulation kit included!



Includes a wooden staircase!



800x115x107, 2855kg 762x115x102, 2592kg 390x115x52, 676kg 600x115x108, 2161kg 600x115x99, 1981kg 270x115x45, 405kg 200x115x85, 567kg 200x115x96, 640kg

Mekong



Roof insulation kit included!



Includes a wooden staircase!



Mekong

702241

735 x 1050

70

489,6

210,8

66,08/32,9

231,40

103,21

11

9/21

1x916x916 2x650x650
1x552x1729 5x1374x916
3x1100x1729 3x1840x650

1x1580x1933 1x827x1933
3x827x1933 int.

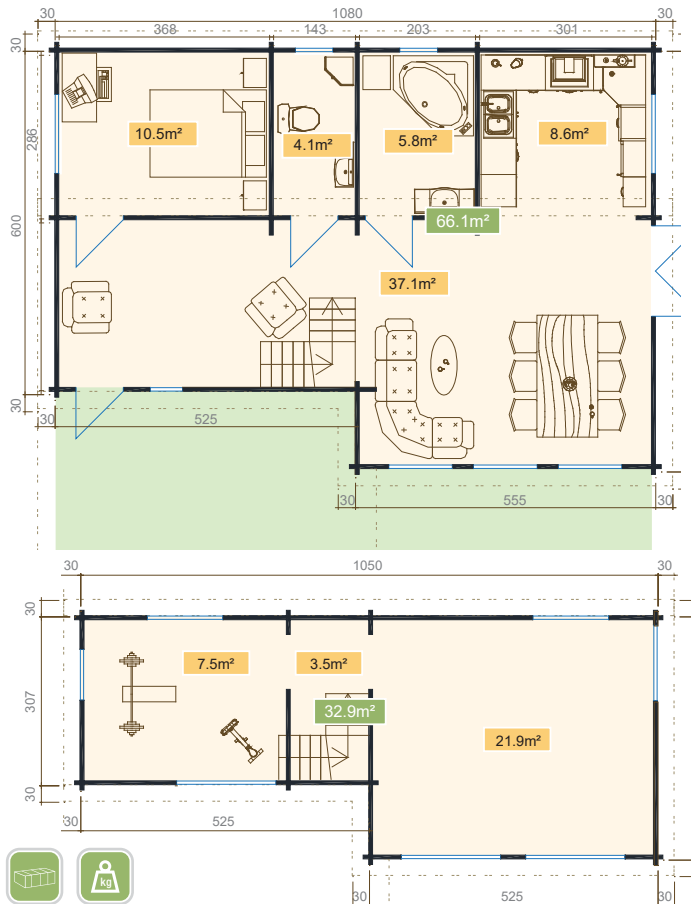

800x115x107, 2855kg 762x115x102, 2592kg 390x115x52, 676kg 600x115x108, 2161kg 600x115x99, 1981kg 270x115x45, 405kg 200x115x85, 567kg 200x115x96, 640kg

Mekong XL



Mekong XL 702241 735 x 1050 70 489,6 210,8 66,1m²/36,8m² 231,40m³ 103,21 11 9/21 3x916x916 4x650x650 2x1374x916 3x1100x1729 2x1580x2000 8x827x2000 int. 7x1800x650

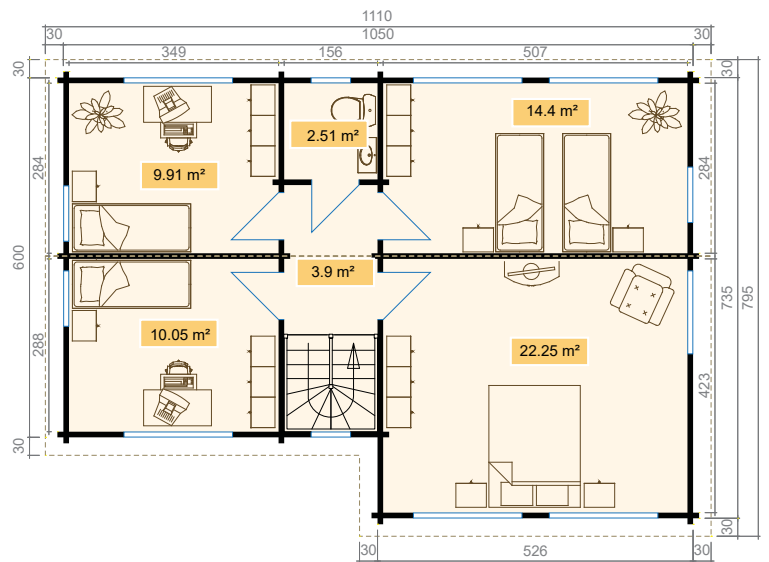
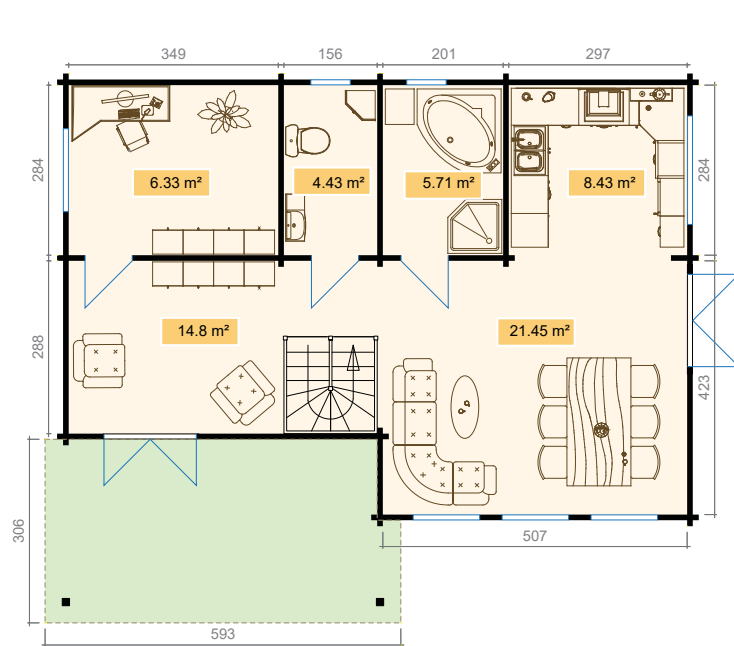

Roof insulation kit included!

Includes a wooden staircase!



800x115x107, 2855kg 762x115x102, 2592kg 390x115x52, 676kg 600x115x108, 2161kg 600x115x99, 1981kg 270x115x45, 405kg 200x115x85, 567kg 200x115x96, 640kg

Missouri



Missouri 702541 430 x 560 70 387,6 231,2 22,28/10,6 68,94 56,56 36 7/25 1x916x916 1x552x1729 1x702x1190 1x1374x916 2x1580x1933 1x827x1933 int.

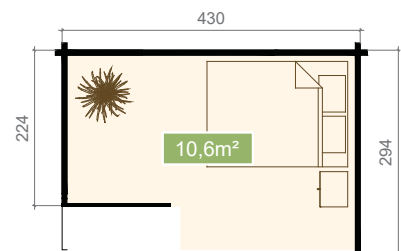
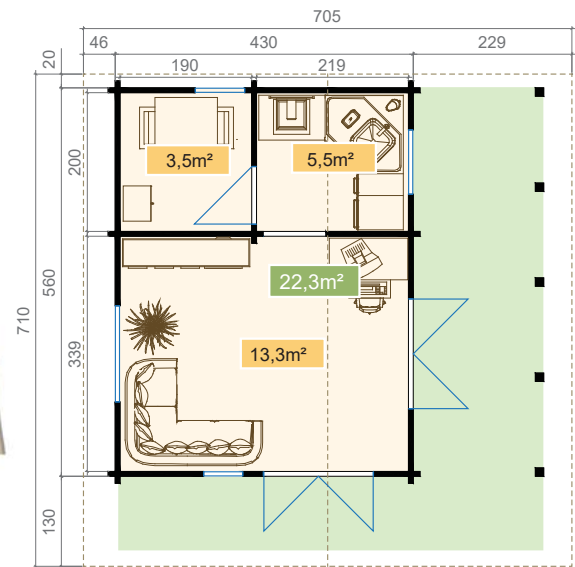

690x115x85, 1956kg 650x115x85, 1843kg 420x115x85, 1191kg 890x115x60, 1781kg 210x115x85, 595kg

Mont Blanc



Mont Blanc	7011348	660 x 760	70	346,8	231,2	41,0	118,49	62,56	27	5/25	1x1100x1729 1x1374x1050	1x650x650 2x1200x650	2x827x2000 int. 1x2540x2000
------------	---------	-----------	----	-------	-------	------	--------	-------	----	------	----------------------------	-------------------------	--------------------------------

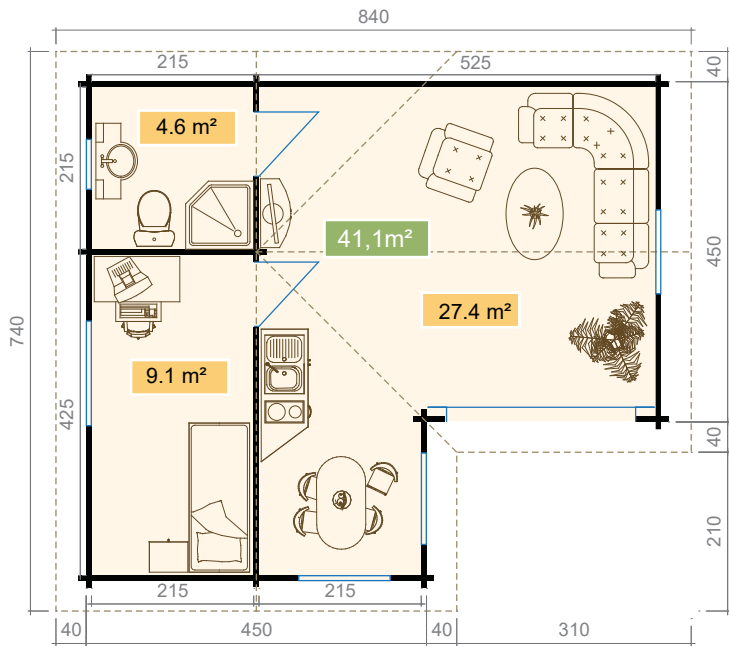

With a Bi-fold door!



660x115x85, 1871kg 660x115x85, 1871kg 250x202x20, 293kg

Oka 70



Oka 70 7012741 575 x 725 70 326,4 224,4 39,48 108,73 65,62 20 8/25 4x916x1050 2x1374x1050 1x827x2000 3x827x2000 int.

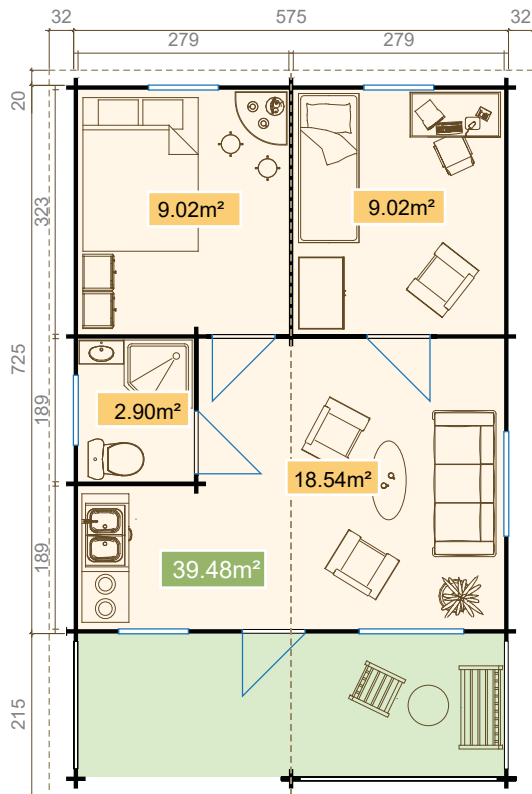

630x115x87, 1828kg 630x115x87, 1828kg 360x115x87, 1045kg 200x115x80, 534kg

Orange 70



Orange 70 7010541 595 x 1050 70 326,4 224,4 56,2 153,09 72,24 19 7/27 2x916x1050 4x1374x1050 1x827x2000 4x827x2000 int.

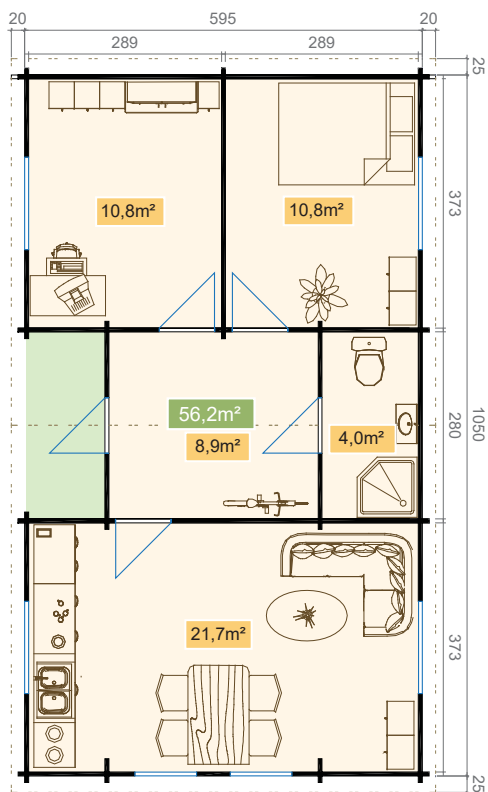

876,5x115x76, 2222kg 630x115x83, 1744kg 640x115x87, 1857kg 770x115x83, 2131kg 630x115x83, 1744kg 200x115x101, 674kg

Orinoco



Orinoco 702741 320 x 500 70 306 244,8 14,5 42,14 40,0 22 8/15 1x916x916 1x827x1933 1x1580x1933

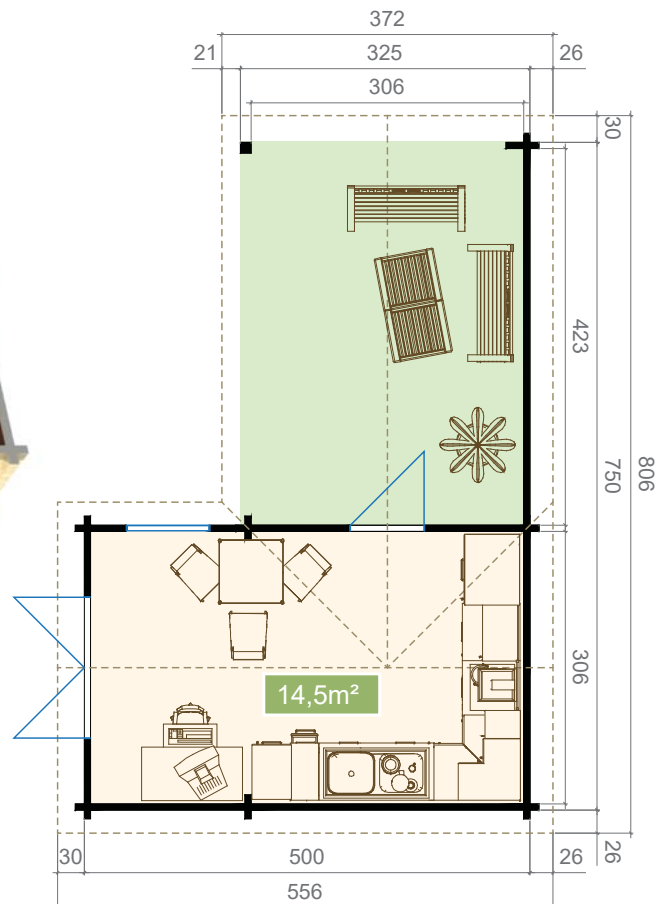

770x115x30, 797kg 520x115x60, 1076kg 220x115x40, 304kg

Orkney 2



Orkney 2 704342 390 x 610 70 244,8 231,2 19,10 45,50 30,20 2 3 1x1100x1729 1x1580x2000 1x827x2000 int.

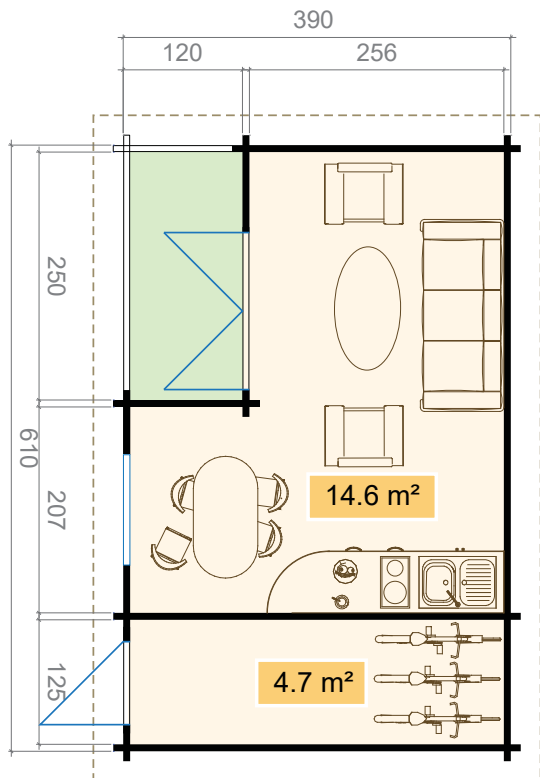

Roof insulation kit included.



650x115x90, 2018kg 480x115x90, 1490kg 220x115x60, 455kg

Orkney 3



Orkney 3 704442 390 x 610 70 244,8 231,2 19,10 45,50 30,20 2 3 1x1100x1729 2x650x650 1x1580x2000 2x827x2000 int.

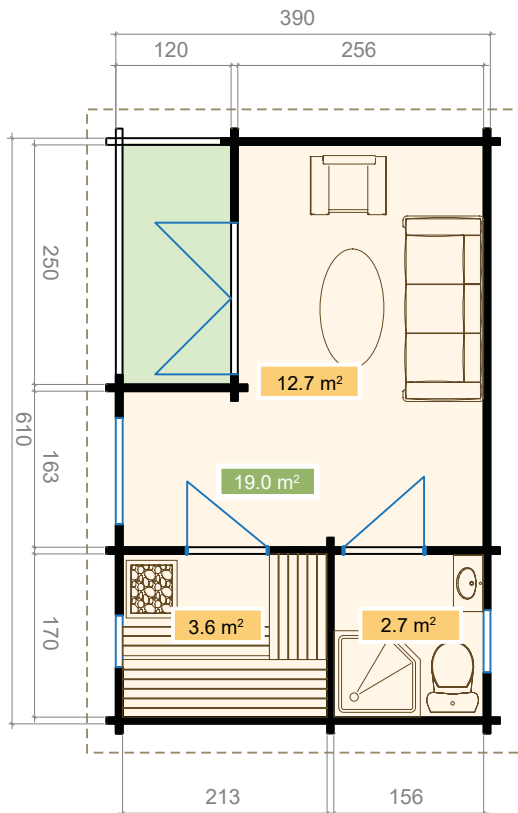

 **Roof insulation kit included.**



650x115x90, 2018kg 480x115x90, 1490kg 220x115x80, 607kg

Orkney 4



Orkney 4 704542 390 x 610 70 244,8 231,2 19,10 45,50 30,20 2 3 1x1100x1729 1x552x1729 1x650x650 1x1580x2000 2x827x2000 int.

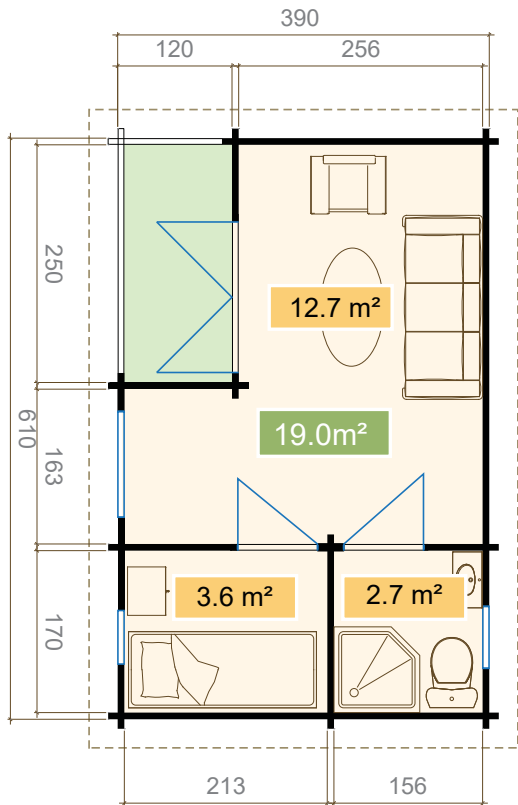

 **Roof insulation kit included.**



650x115x90, 2018kg 480x115x90, 1490kg 220x115x80, 607kg

Orkney 5



Orkney 5 704642 390 x 610 70 244,8 231,2 19,10 45,50 30,20 2 3 1x552x1729 1x650x650 1x1100x1729 1x1580x2000 1x827x1933 int.

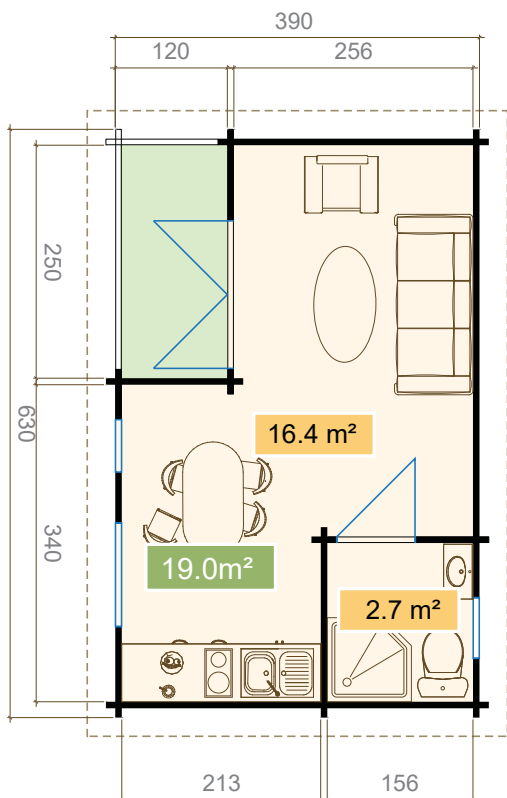

 **Roof insulation kit included.**



670x115x65, 1452kg 630x115x57, 1198kg 200x115x52, 347kg

Orkney 6



Orkney 6 704742 390 x 610 70 244,8 231,2 18,25 43,44 30,20 2 3 1x552x1729 2x1100x1729 1x1580x2000

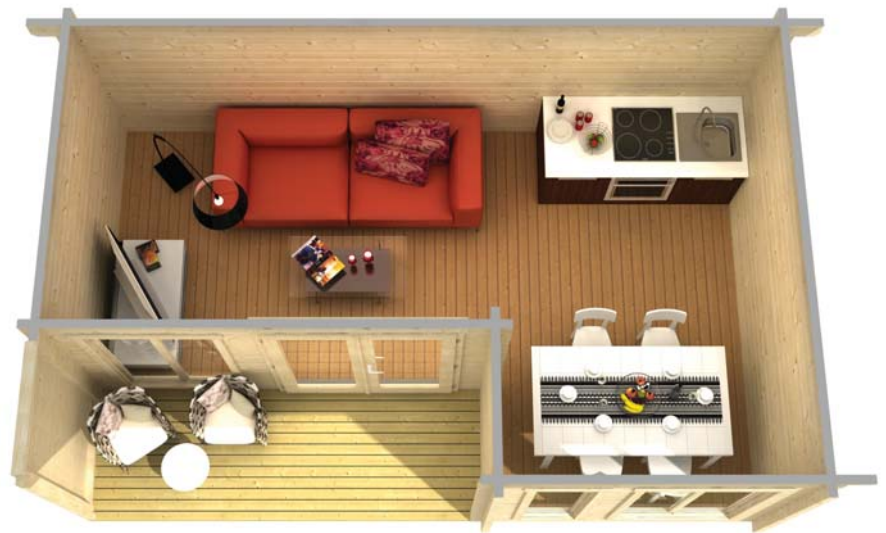
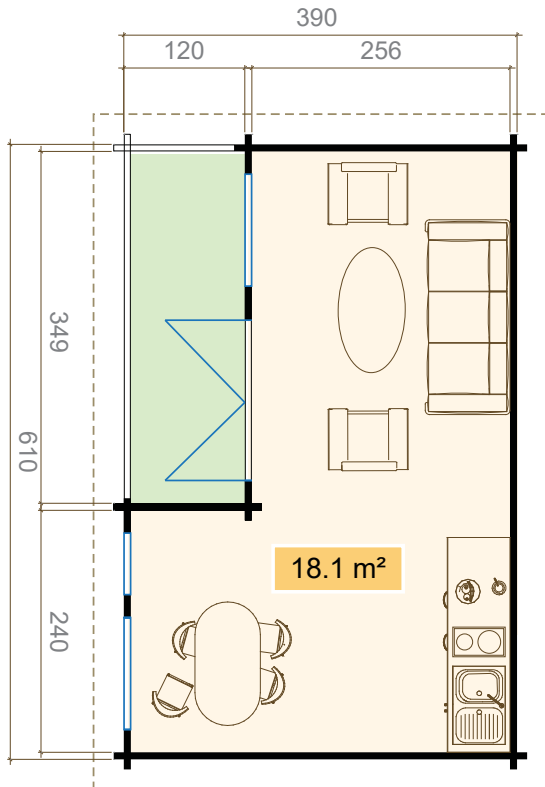

 **Roof insulation kit included.**



670x115x75, 1676kg 480x115x43, 688kg 200x115x53, 354kg

Orkney 7



Orkney 7 704842 390 x 610 70 244,8 231,2 17,70 42,10 30,20 2 3 1x1100x1729 2x650x650 1x1580x2000 2x827x2000 int.

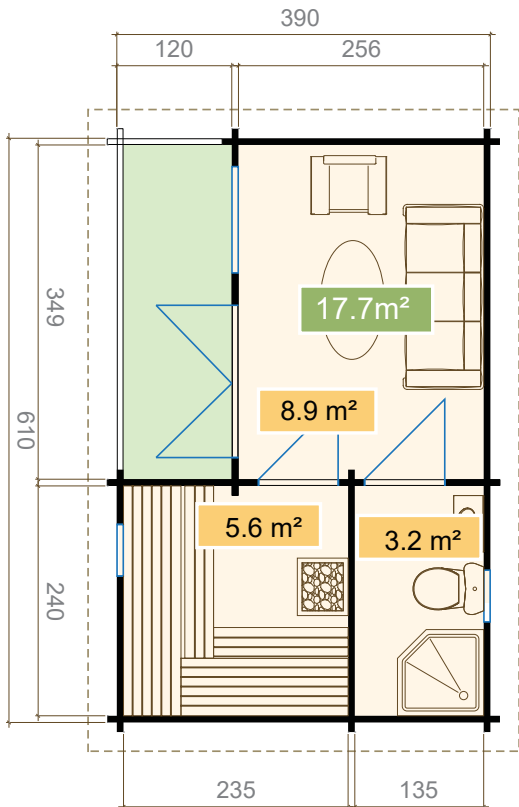

 **Roof insulation kit included.**



650x115x90, 2018kg 480x115x90, 1490kg 220x115x70, 531kg

Orkney 8



Orkney 8 704942 390 x 610 70 244,8 231,2 17,96 42,74 30,20 2 3 1x552x1729 2x1100x1729 1x1580x2000 1x827x1933 int.

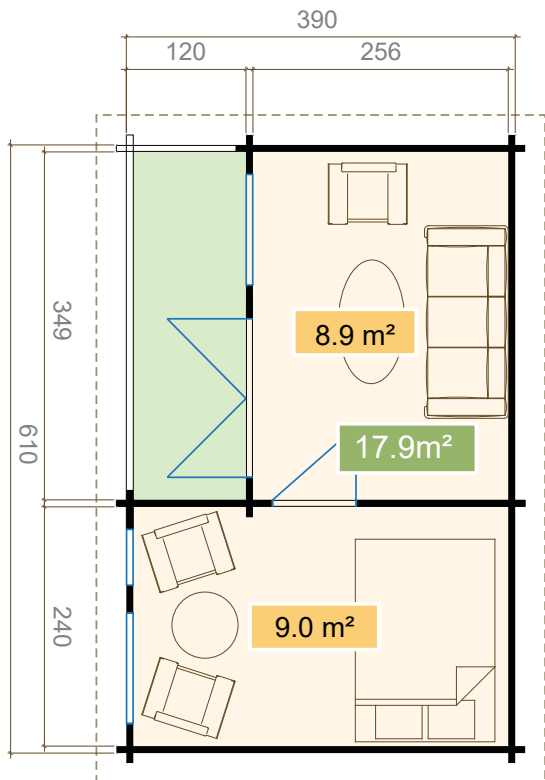

Roof insulation kit included.



670x115x68, 1519kg 490x115x63, 1030kg 200x115x61, 407kg

Orkney 9



Orkney 9 705042 390 x 610 70 244,8 231,2 8,8 42,60 30,20 2 3 1x1100x1729 1x552x1729 1x650x650 1x1580x2000 1x827x2000 int.

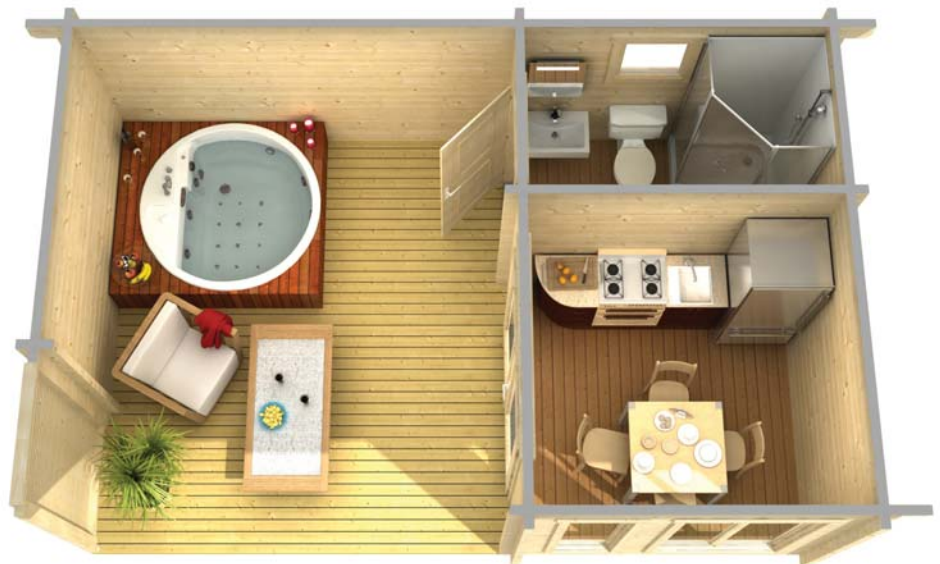
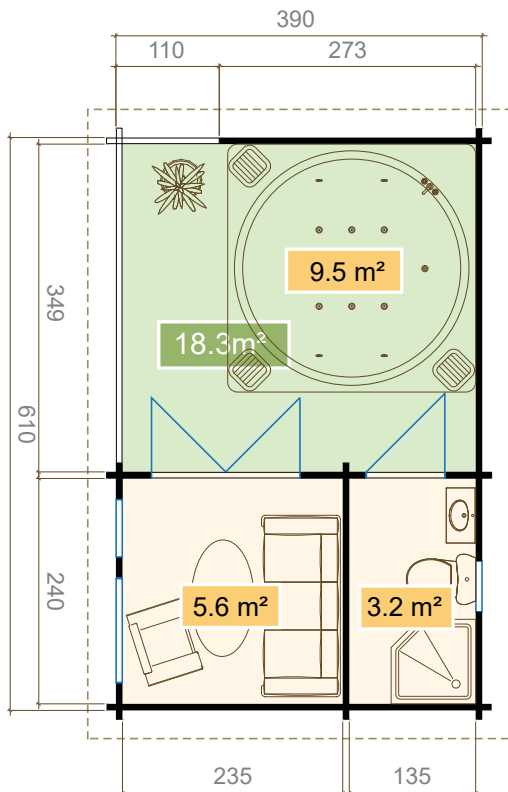

Roof insulation kit included.



650x115x90, 2018kg 480x115x90, 1490kg 220x115x80, 607kg

Orkney 10



Orkney 10 705442 390 x 610 70 244,8 231,2 19,3 42,60 30,20 2 3 1x1100x1729 1x650x650 1x1580x2000 1x827x2000 int.

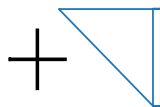
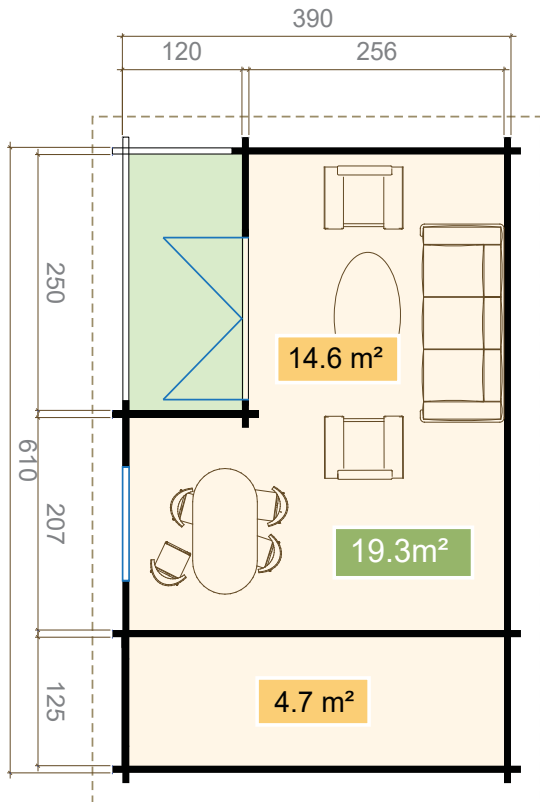

 **Roof insulation kit included.**

The position of the internal single door can be chosen by the client



650x115x90, 2018kg 480x115x90, 1490kg 220x115x80, 607kg

Snake 70



Snake 70 7012741 575 x 625 70 326,4 224,4 33,90 93,36 58,82 20 8/22 4x916x1050 2x1374x1050 1x827x2000 3x827x2000 int.

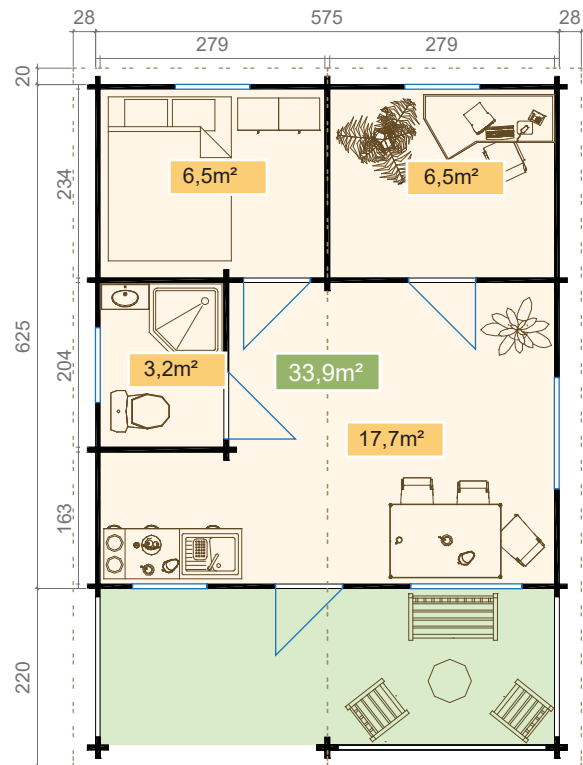

630x115x87, 1828kg 630x115x87, 1828kg 360x115x87, 1045kg 200x115x80, 534kg

Tennessee



Tennessee 7012041 600 x 600 70 326,4 224,4 33,83 93,17 58,10 19 8/21 5x916x1050 1x 1580x2000 2x827x2000 int.

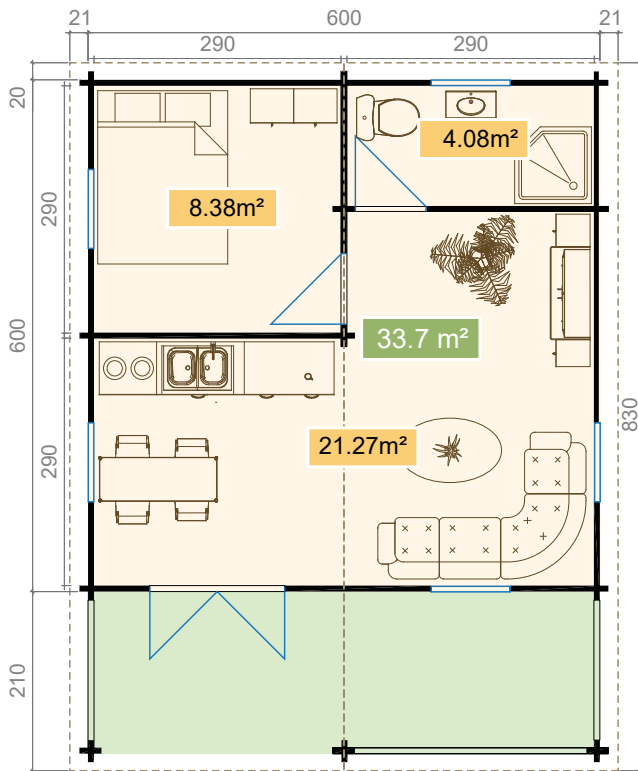

670x115x85, 1899kg 700x115x80, 1868kg 450x115x92, 1381kg 200x115x85, 567kg

Tigris



Tigris 701841 570 x 550 70 360,4 272 23,84/16,05 75,38 38,94 17 4/15 2x702x1190 2x650x650 2x1374x916 1x827x1933 1x827x1933 int.

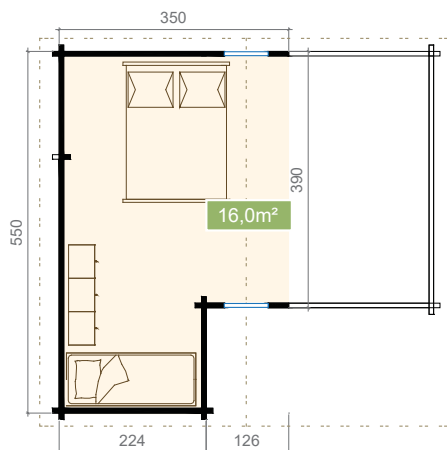
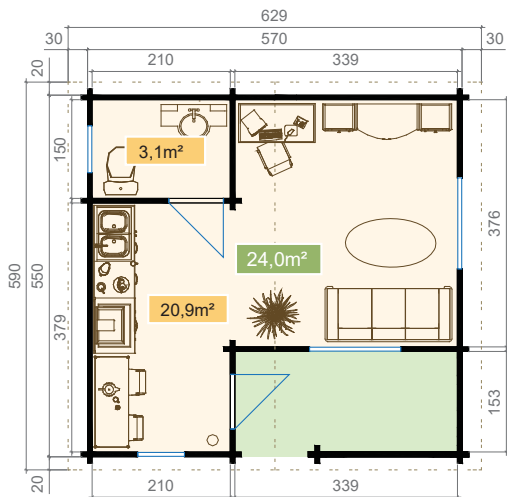

630x115x111, 2332kg 480x115x65, 1041kg 200x115x70, 467kg



Tresco 703942 450 x 260 70 299,2 224,4 15,4 27,58 27,04 18 4/11 2x916x916 1x827x2000 int 1x827x2000

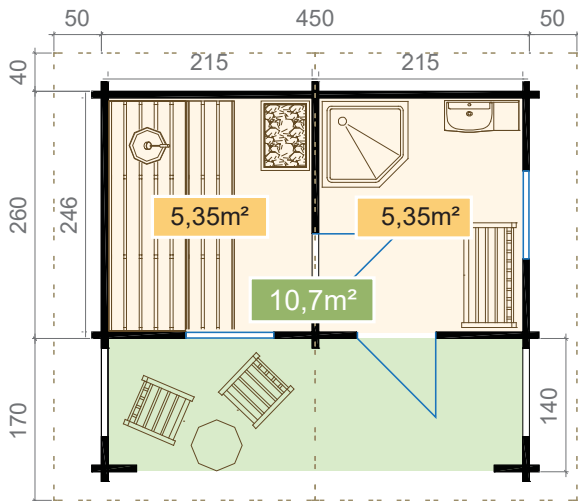

Classical Finnish styled sauna cabin
Tresco comes with preparations made
for the insulation of both roof and floor
making the house easily adaptable for
harder weather conditions.



620x115x85, 1818kg

Twin Cabin



Twin Cabin 703842 600 x 280 70 340 224,4 15,40 43,46 34,73 20 4/13 2x1374x916 2x827x2000

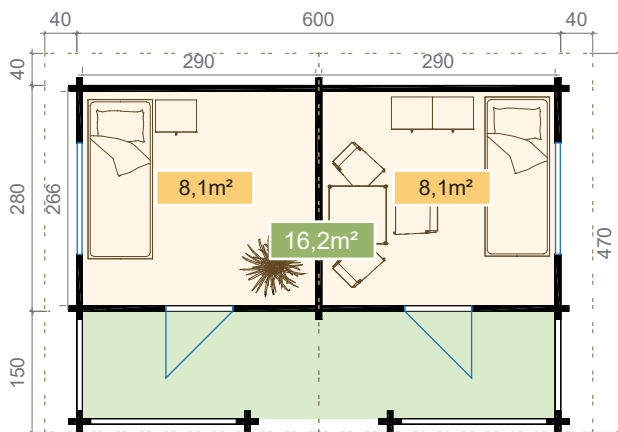

Finnish styled double cabin Twin Cabin comes with preparations made for the insulation of both roof and floor making the house easily adaptable for harder weather conditions. Perfect for use at camping sites.



630x115x83, 1744kg 480x115x76, 1217kg



Valga

703341

600 x 600

70

360,4

244,8

33,76/14,24

102,16

47,60

21

8/18

3x916x916 1x1374x916

1x1580x1933
2x827x1933 int.

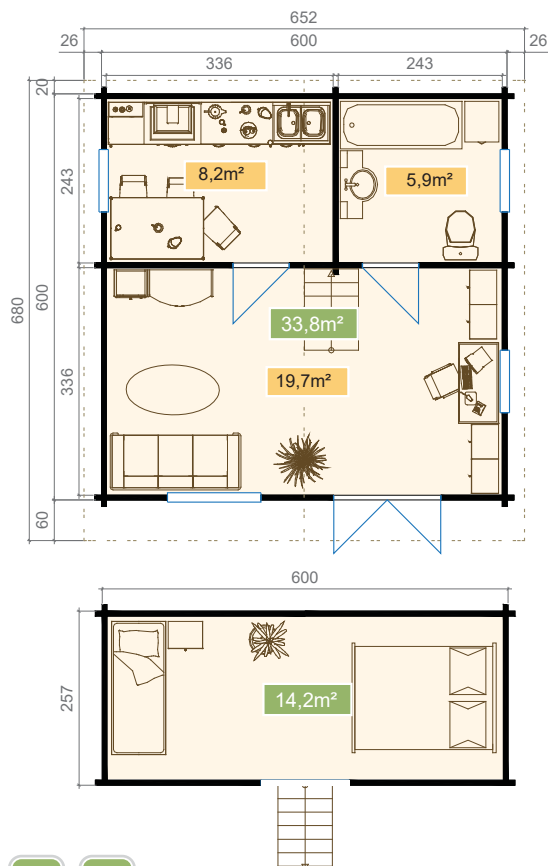

680x115x82, 1860kg 500x115x60, 1001kg 500x115x75, 1251kg 200x115x68, 454kg

Vanessa 1



Vanessa 1 705944 300 x400 70 244,8 204 9,6 53,50 26,28 15 2 2x1100x1729 1x1580x1865

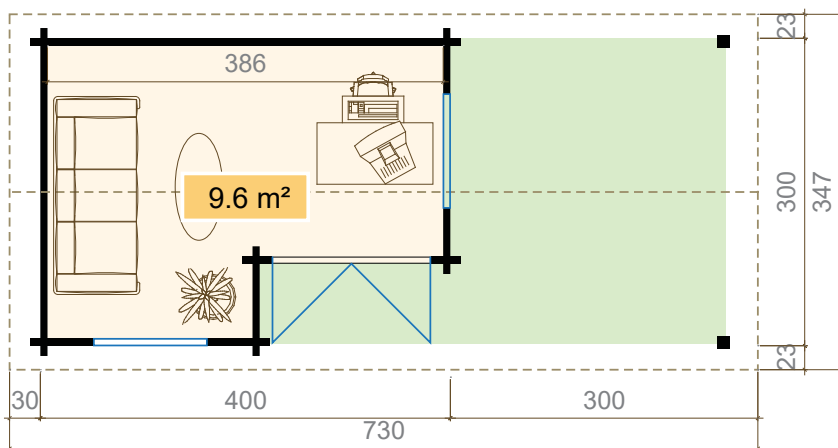

The Vanessa cabin provides lots of light both on the inside and on the outside. It boasts with a large terrace with a three meter canopy. Great for a home office and leisure.



730x115x80, 1947kg



Volta 702441 500 x 650 70 346,8 244,8 30,30/10,0 91,40 45,80 23 7/17 3x916x916 1x650x650 1x1374x916 1x827x1933 1x1580x1933 1x827x1933 int.

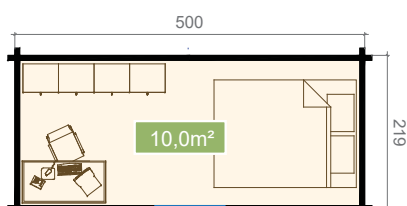
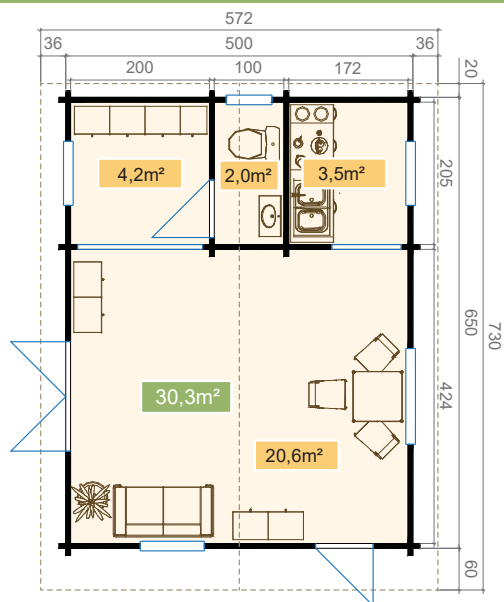

730x115x60, 1511kg 240x115x80, 662kg 220x115x50, 380kg

White Nile



White Nile 702941 300 x 350 70 278,8 231,2 9,6 24,90 38,0 14 6/15 3x552x1729 1x916x916 1x1580x1933

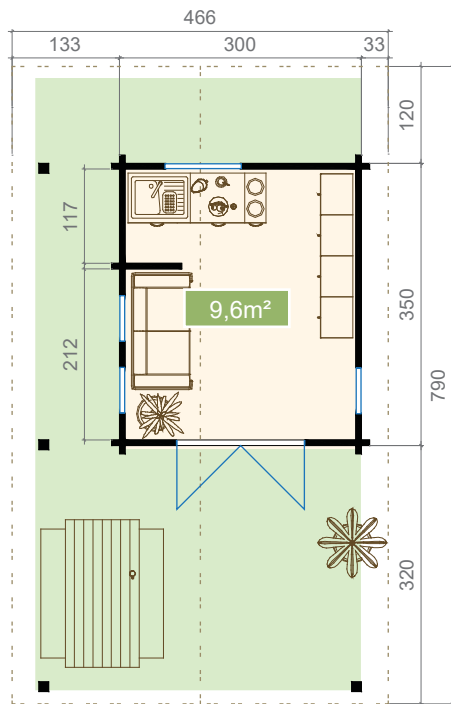

790x115x30, 818kg 420x115x40, 580kg 220x155x30, 288kg



Yukon 702641 575 x 575 70 306 217,6 27,70 72,30 46,90 17 8/18 3x916x916 1x650x650 1x1374x1050 1x1580x1933 2x827x1933 int.

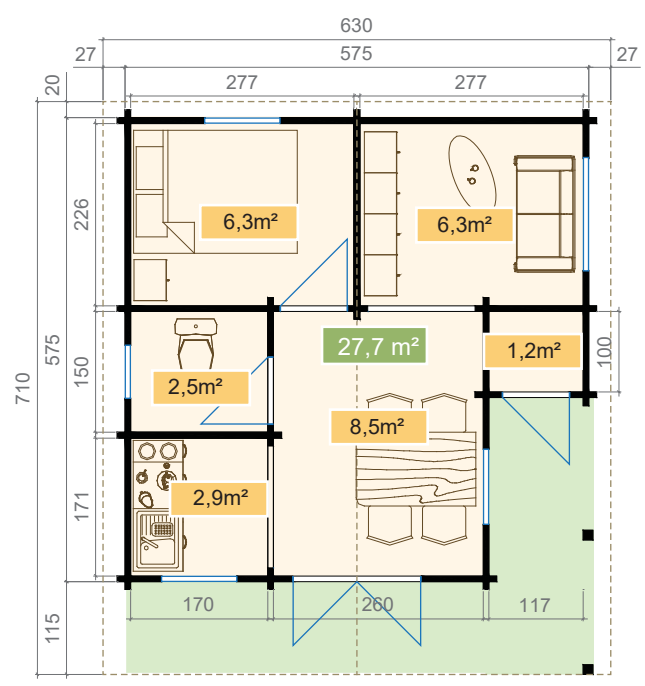

710x115x50, 1225kg 362x115x80, 999kg 220x115x50, 380kg

We offer a series of Estonian-produced premium windows with our range of products. We have four distinctive product classes and each of them has certain characteristics. You can learn more about our window classes by looking at the table below.

WINDOWS	1+	2+	3+	5+
1 Wood type	Pine	Pine	Pine	Pine (Painted)
2 Wall thickness	44;58;70;94	44;58;70;94	44;58;70;94	44;58;70;94
3 Laminated wood	+	+	+	+
4 Cross bars type	Screws	Screws	Clips	Clips
5 Pretreated	Remmers Induline	Remmers Induline	Remmers Induline	Remmers Induline
6 Finishing	++	++	++	Painted or stained
7 Glazing	Single	Double	Double	Double
8 Code	1+	2+	3+	5+
9 Selective glazing	-	++	++	+
10 Argon	-	++	++	+
11 U ⁱ -value>W/m ² K	5,6	2.8 (1.2*)	2.8 (1.2*)	1.1
12 Silicon gascet	+	+	+	2x
13 Water gutter	Aluminum	Aluminum	Aluminum	Aluminum
14 Opening	Inside	Inside	Inside	Inside
15 Opening system	N/A Tilt and turn	N/A Tilt and turn	D/K Tilt and turn	D/K Tilt and turn
16 Tender post for window -installation	from 70mm	from 70mm	from 70mm	from 70mm



- not included; + included; ++ on request;

As with windows we also have certain product classes for our doors. All four product classes have different characteristics and you can learn more about them by looking at the table below.

DOORS	1+	2+	3+	5+
1 Wood type	Pine	Pine	Pine	Pine (Painted)
2 Wall thickness	44;58;70;94	44;58;70;94	44;58;70;94	44;58;70;94
3 Laminated wood	+	+	+	+
4 Cross bars type	Screws	Screws	Clips	Clips
5 Pretreated	Remmers Induline	Remmers Induline	Remmers Induline	Remmers Induline
6 Finishing	-	-	-	Painted or stained
7 Glazing	Single	Double	Double	Double
8 Code	1+	2+	3+	5+
9 Selective glazing	-	++	++	+
10 Argon	-	++	++	+
11 U ⁱ -value>W/m ² K	5,6	2.8 (1.2*)	2.8 (1.2*)	1.1
12 Silicon gascet	+	+	+	2x
13 Door sill	Metal covered	Metal covered	Metal/Oak	Metal/Oak
14 Opening	Outside	Outside	Outside/Inside	Outside/Inside
15 Locking system	Cylinder	Cylinder	3 point lock	3 point lock
16 Tender post for door'-installation	from 70mm	from 70mm	from 70mm	from 70mm



- not included; + included; ++ on request;

Our products are available in four different wall thicknesses – 44, 58, 70 and 94. There's also an option to make double walled buildings such as the Barbados 3 44 Double (page 6 of this catalogue). To learn more about different construction options see the table below.

CONSTRUCTION	1+	2+	3+	5+
1 Wall thickness (mm)	44	58	70	94
2 Wind tight chalet'-connection	+	+	+	+
3 Wall insulation frame kit	-	-	++	++
4 Double tongue and groove	+	+	+	+
5 Impragnated terraceboard	+	+	+	+
6 Impragnated foundation	+	+	+	+
7 Floor 18mm	++	++	++	++
8 Floor 28mm	++	++	++	++
9 Floor insulation package	++	++	++	++
10 Floor fillets	+	+	+	+
11 Roof	18	18	18	18
12 Roof construction	Purlins/Rafters	Purlins/Rafters	Purlins/Rafters	Purlins/Rafters
13 Roof insulation package	++	++	++	++
14 Roofing felt	++	++	++	++
15 Shingles	++	++	++	++
16 Construction for roof tiles	++	++	++	++
17 Wind protection	wooden strip	wooden strip	treaded rod	treaded rod
18 Fixing set	+	+	+	+
19 Quarantee for construction	5 years	5 years	5 years	5 years
20 T-batten for window-installation	-	-	++	+
21 Predrilled cabel canals	-	-	++	++

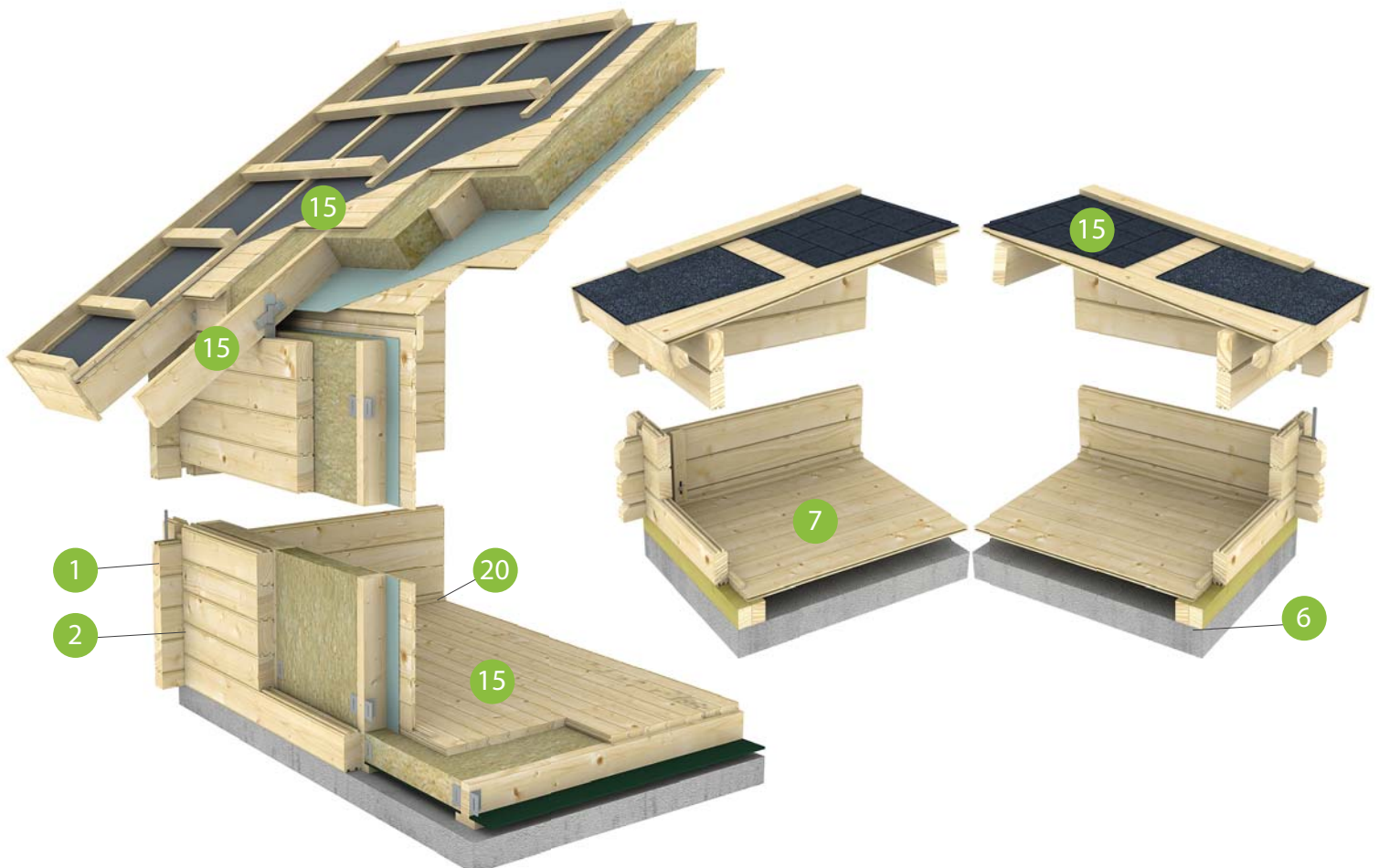

OÜ Nordic-Holz

Atla küla

Juur vald

Raplamaa

ESTONIA

mait@nordic-holz.ee

+372 5149767

www.nordic-holz.ee

